4. Disassembly and Reassembly

4-1 Replacement of Magnetron, Motor Assembly and Lamp

Remove the magnetron including the shield case, permanent magnet, choke coils and capacitors (all of which are contained in one assembly).

1. Disconnect all lead wires from the magnetron and lamp.
2. Remove the air cover.
3. Remove screws securing the magnetron to the wave guide.
4. Take out the magnetron very carefully.
5. Remove screws from the back panel.
6. Take out the fan motor.
7. Remove the oven lamp by pulling out from hole of air cover.

NOTE 1 : When removing the magnetron, make sure that its antenna does not hit any adjacent parts, or it may be damaged.

NOTE 2 : When replacing the magnetron, be sure to remount the magnetron gasket in the correct position and make sure the gasket is in good condition.

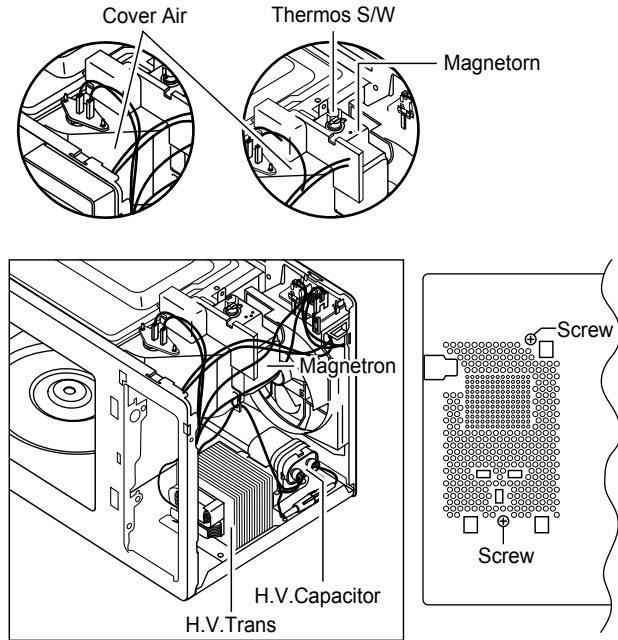

4-2 Replacement of High Voltage Transformer

1. Discharge the high voltage capacitor.
2. Disconnect all the leads.
3. Remove the mounting bolts.
4. Reconnect the leads correctly and firmly.

PRECAUTION

Servicemen should remove their watches whenever working close to or replacing the magnetron.

PRECAUTION

There exists HIGH VOLTAGE ELECTRICITY with high current capabilities in the circuits of the HIGH VOLTAGE TRANSFORMER secondary and filament terminals. It is extremely dangerous to work on or near these circuits with the oven energized.

DO NOT measure the voltage in the high voltage circuit including filament voltage of magnetron.

4-3 Replacement of Door Assembly

4-3-1 Removal of Door Assembly

Remove hex bolts securing the upper hinge and lower hinge. Then remove the door assembly.

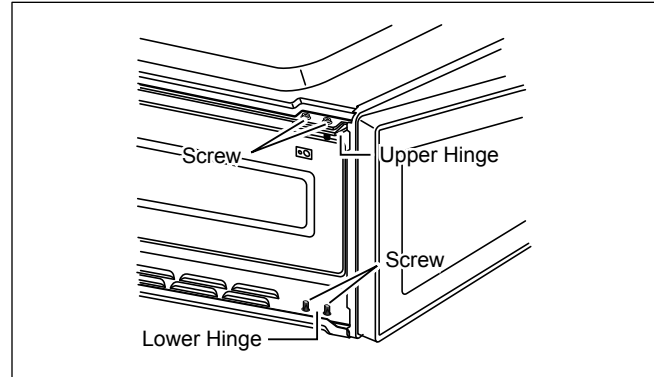

4-3-2 Removal of Door "C"

Insert flat screwdriver into the gap between Door "E" and Door "C" to remove Door "C". Be careful when handling Door "C" because it is fragile.

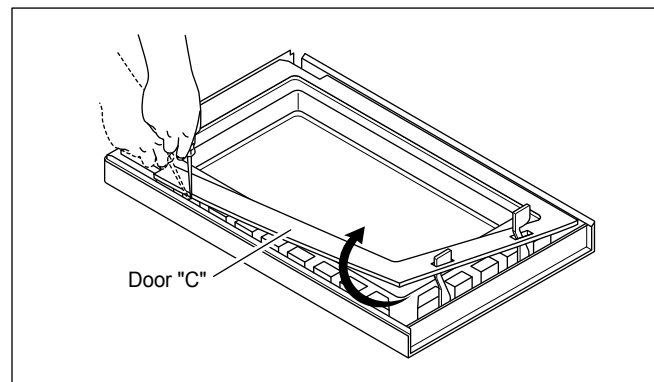

4-3-3 Removal of Door "E"

Following the procedure as shown in the figure, insert and bend a thin metal plate between Door "E" and Door "A" until you hear the 'tick' sound.

1. Insertion depth of the thin metal plate should be 0.5mm or less.

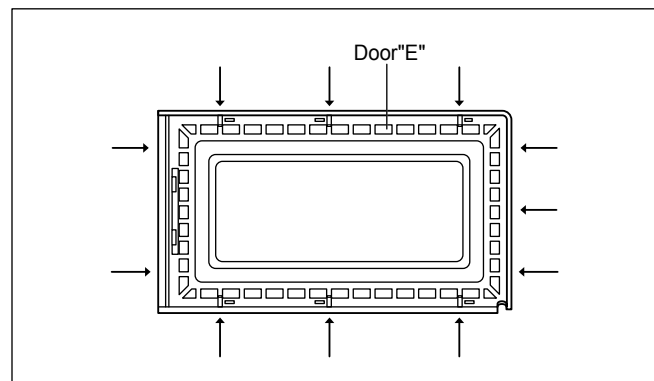

4-3-4 Removal of Key Door & Spring

Remove pin hinge from Door "E"
Detach spring from Door "E" and key door.

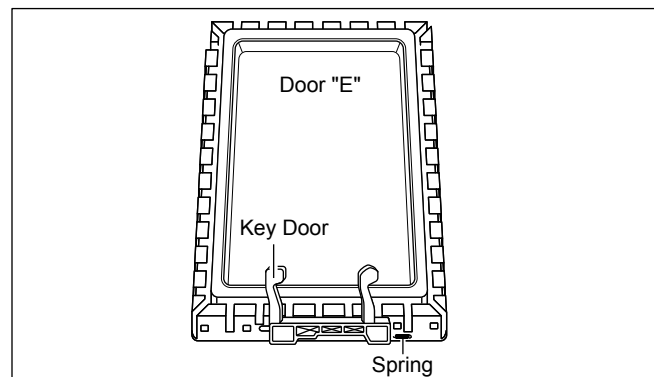

4-3-5 Reassembly Test

After replacement of defective component parts of the door, reassemble it and follow the instructions below for proper installation and adjustment so as to prevent an excessive microwave leakage.

1. When mounting the door to the oven, be sure to adjust the door parallel to the bottom line of the oven face plate by moving the upper hinge and lower hinge in the direction necessary for proper alignment.
2. Adjust so that the door has no play between the inner door surface and oven front surface. If the door assembly is not mounted properly, microwave energy may leak from the space between the door and oven.
3. Do microwave leakage test.

4-4 Replacement of Fuse

1. Disconnect the oven from the power source.
2. When 15A fuse blows out by the operation of interlock monitor switch failure, replace the primary interlock switch, door sensing switch, monitor switch and power relay.
3. When the above three switches operate properly, check if any other part such as the control circuit board, blower motor or high voltage transformer is defective.

4-5 Replacement of Drive Motor

1. Take out the glass tray, guide roller from oven cavity, disconnect power.
2. Remove turn table motor cover from case bottom.
CAUTION : Remove sharp edge after cover removal.
3. Disconnect leads from motor.
4. Remove the screws securing motor to bottom of oven cavity and lift out the motor.
5. When replacing the motor, be sure to remount it in the correct position.
NOTE : The shaft of motor should fit tip coupler.
6. Screw the motor to bottom of oven cavity.
7. Connect leads to the drive motor.
8. Screw the drive motor cover to the base plate with a screw driver.
NOTE : Bring the spare screw from service center.

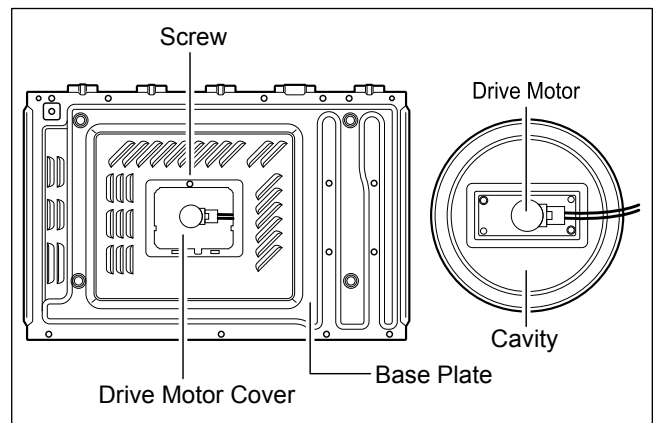

COVER FIXING SCREW :
MACHINE SCREW(6006-001170)

4-6 Replacement of Control Circuit Board

4-6-1 Removal of Control Box Assembly

1. Be sure to ground any static electric charge in your body and never touch the control circuit.
2. Disconnect the connectors from the control circuit board.
3. Remove screws securing the control box assembly.
4. Remove the screw securing the ground tail of the keyboard.

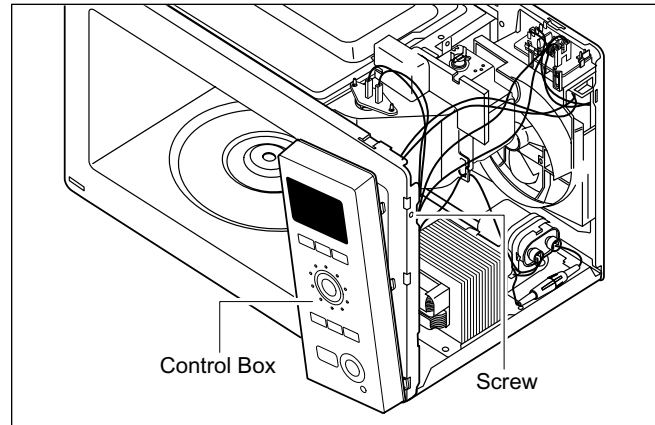

4-6-2 Removal of Ass'y P.C.B Assembly

1. Remove screws securing the control circuit board.
2. Lift up the control circuit board from the Ass'y control box.

