

3. Exploded View & Parts List

3-1 SP67L6HXX/BWT

You can search for the updated part code through ITSELF web site.
URL : <http://itself.sec.samsung.co.kr>

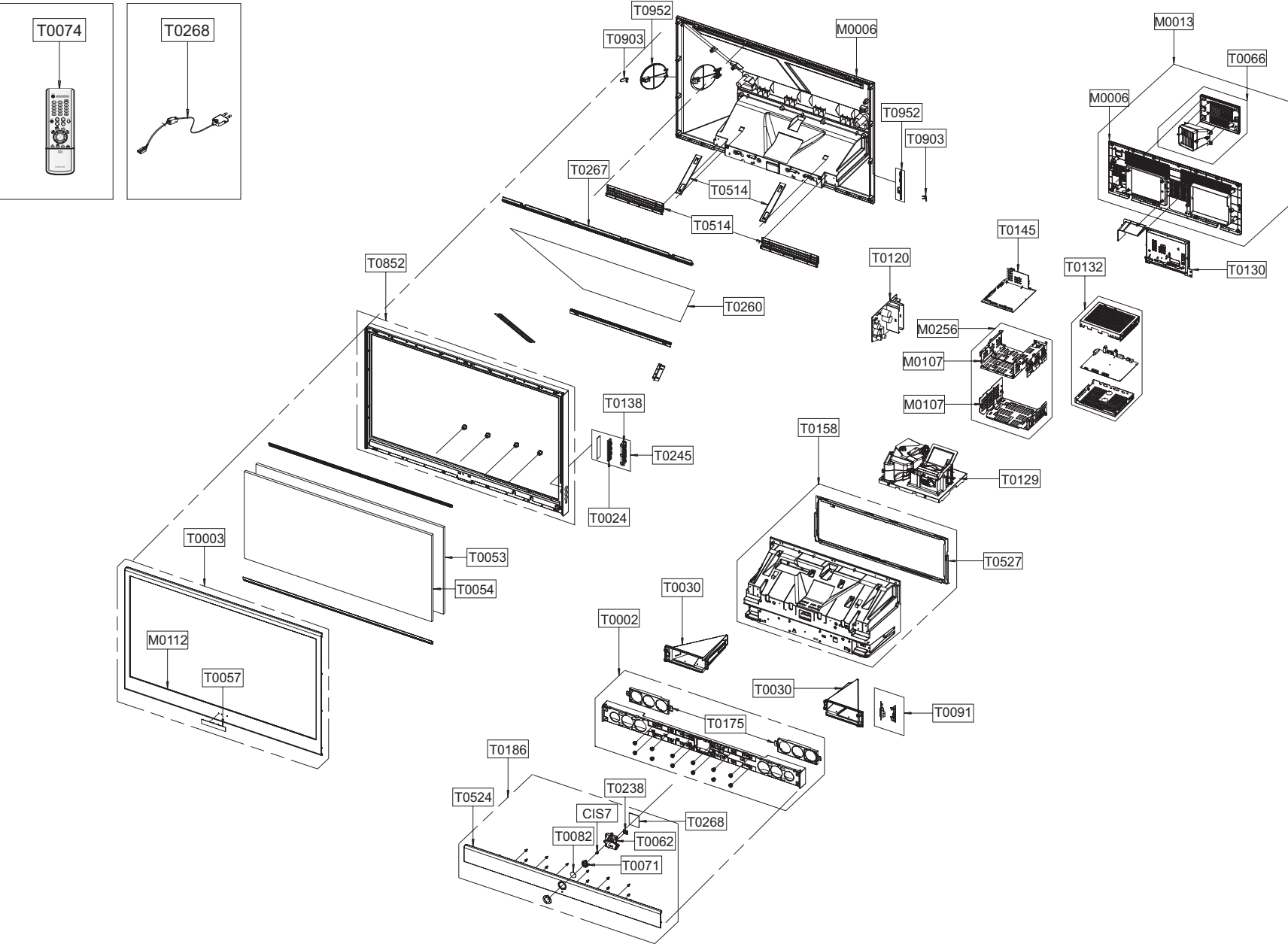

Loc.No	Code No	Description;Specification	Q'ty	S.N.A
CIS7	AA61-60003J	SPRING ETC-CS;-;SUS304;-;-;OD6,N7,OD6,-;	1	S.N.A
M0006	BP63-00431A	COVER-REAR;67L6,HIPS,HB,GRAY,TOP	1	
M0006	BP63-00401A	COVER-REAR BOTTOM;50L6,HIPS,V0,GRAY	1	S.N.A
M0013	BP96-00938C	ASSY COVER P-REAR BOTTOM;L6,HIPS V0,GR50	1	
M0107	BP61-00892A	BRACKET-PCB;50L3,SECC,T1.0,NTR,TOP(BUILT	1	S.N.A
M0107	BP61-00893A	BRACKET-PCB;50L3,SECC,T1.0,NTR,BOT(BUILT	1	S.N.A
M0112	BP63-00429G	COVER-FRONT;67L6,HIPS,HB,BLK,BKN1576,EUP	1	S.N.A
M0256	BP96-00849F	ASSY BRACKET P-MAIN PCB;L3,L6,L7,SECC,T1	1	
T0002	BP96-01024A	ASSY COVER P-FRONT BOTTOM;67L6,HIPS,HB,G	1	
T0003	BP96-01030G	ASSY COVER P-FRONT;67L6,HIPS,HB,BLK,BKN1	1	
T0024	BP64-00384B	KNOB-FAMILY;L6,ABS,HB,GRAY,SVM-3012	1	S.N.A
T0030	BP96-01027B	ASSY COVER P-SIDE;67L6,HIPS,HB,GR503,LEF	1	
T0030	BP96-01028B	ASSY COVER P-SIDE;67L6,HIPS,HB,GR503,RIG	1	
T0053	BP67-00187A	SCREEN FRESNEL;67W,1524*875,T2.0	1	
T0054	BP67-00186A	SCREEN LENTI;67W,1524*875,T2.1	1	
T0057	BP64-00179A	BADGE-BRAND;ALL,AL,T1.5,83,14,,BLK,SILIV	1	S.N.A
T0062	BP61-00530A	HOLDER-POWER;50L3,HIPS HB,GRAY	1	S.N.A
T0066	BP96-00535E	ASSY COVER P-DUCT;L6,HIPS HB,GRY	1	
T0071	BP64-00382A	INDICATOR-LED;50L3,ABS CLEAR (LG)	1	S.N.A
T0074	BN59-00378C	REMOCON;ATLANTIS,TM77,55,EX	1	
T0082	BP64-00309E	WINDOW LED;50L3,ACRYL,T2.0,HALF-MIRROR,E	1	S.N.A
T0091	BP94-02059X	ASSY PCB MISC-AV SIDE;67L6/EUROPE,M62A	1	
T0120	BP94-02141T	ASSY PCB POWER;HURRICANE,M62A,PAL AREA,I	1	
T0129	BP96-01018F	ASSY ENGINE P-DLP;67L6(L620),PHILIPS 132	1	
T0130	BP96-01005A	ASSY COVER P-TERMINAL BOARD;L6(M62A),EUP	1	S.N.A
T0132	BP94-01848H	ASSY PCB MISC-DIGITAL;EUROPE,M62A,L620	1	
T0138	BP64-00383B	KNOB-HOLDER;L6,ABS,HB,GRAY,SVM3012	1	S.N.A
T0145	BP94-02182A	ASSY PCB MISC-ANALOG;SP46L3HXX/XEC,M62A,	1	
T0158	BP96-00937C	ASSY COVER P-MAIN;L6 ,M62A,HIPS, V0,GR50	1	
T0175	BP96-01278A	ASSY SPEAKER P;8ohm,L6(DLP)_VE,15W	2	
T0186	BP96-01025D	ASSY COVER P-GRILLE;67L6,HIPS,HB,GR503,S	1	S.N.A
T0238	BP64-00385B	WINDOW REMOCON;L3,L6 Series,ACRYL,MILKY	1	S.N.A
T0245	BP94-01712A	ASSY PCB MISC-KEY CONTROL;SVP-67L6X,L62B	1	
T0260	BP67-00215A	MIRROR-FRONT;Front mirror 67",glass,1510	1	
T0267	BP61-00938A	BRACKET-MIRROR TOP;67L6,AL6063 EXTR	1	S.N.A
T0268	BP94-02140G	ASSY PCB MISC-RMC LED;HLP5063W,L62B,ATLA	1	
T0268	3903-000145	CBF-POWER CORD;DT,EU,FP3/YES,U(IEC C13-R	1	
T0514	BP61-00916A	BRACKET-SUPPORT;67L6,SECC-1,T1.2,NTR,BAC	2	S.N.A
T0514	BP61-00918A	BRACKET-SUPPORT;61L6,SECC-1,T1.6,NTR	2	S.N.A
T0524	BP63-00433A	COVER-GRILLE;67L6,HIPS,HB,GR503,SV012P	1	S.N.A
T0527	BP61-01045A	BRACKET-COVER;L6,SECC-1,T1.2,NTR,BOTTOM	1	S.N.A
T0852	BP96-01026D	ASSY COVER P-MIDDLE;67L6,HIPS,HB,GR503,S	1	
T0903	BP61-00528A	HOLDER-DUST;50L3,HIPS HB,GRAY	2	S.N.A
T0952	BP63-00294B	COVER DUST-ASSY;L6,HIPS,HB,GRAY	2	S.N.A

3-2 Engine Ass'y

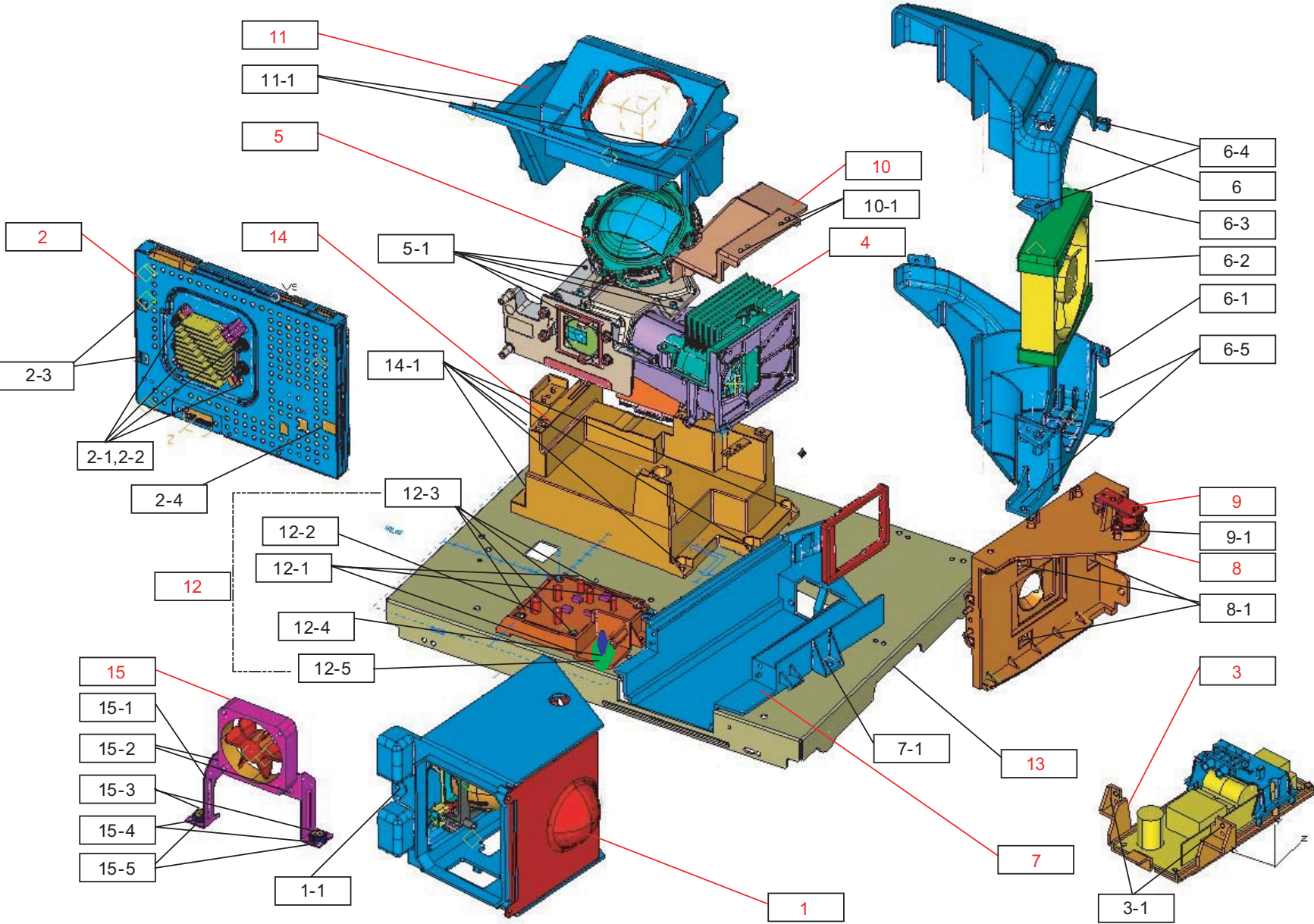

L3 Engine Exploded View List			
No.	Description	Specification	Q'ty
1	ASSY LAMP P	L3,LAMP SERVICE,PHILIPS 120W	1
1-1	SCREW-MACHINE	WSP,PH,+,M4,L12,ZPC(YEL),S	1
2	ASSY DMD BOARD P	L3 PHILIPS,DMD BOARD,SE	1
2-1	SPRING ETC-COIL,DMD	B3K,SPRING STEEL	4
2-2	SCREW-MACHINE	PWH,+, -,M3,L30,ZPC(YEL),SW	4
2-3	SCREW-TAPTITE	PWH,+, -,S,M3,L8,ZPC(YEL),S	2
2-4	SCREW-TAPTITE	PWH,+,B,M3,L6,ZPC(YEL),SWR	1
3	ASSY BALLAST P	L3,SERVICE BALLST	1
3-1	SCREW-TAPTITE	PWH,+,B,M3,L10,ZPC(YEL),SW	2
4	ASSY K/D-COLOR WHEEL	L3 ENGINE,SERVICE	1
5	ASSY K/D-OPTIC MODULE	L3 ENGINE(AIR),SER	1
5-1	SCREW-TAPTITE	BH,+,B,M3,L12,ZPC(YEL),SWR	5
6	COVER DUCT-TOP23	SVP-50L3HR,PC G/F20	1
6-1	COVER DUCT-BOTTOM23	SVP-50L3HR,PC G/F20	1
6-2	FAN-DC	SVP-50L7XHD,UL94V-0, PBT,Wire Len	1
6-3	RUBBER-FAN,LAMP	SHF700,NBR,50,LOSS FACTO	2
6-4	SCREW-TAPTITE	PWH,+,B,M3,L10,ZPC(YEL),SW	3
6-5	SCREW-MACHINE	WSP,PH,+,M4,L12,ZPC(YEL),S	3
7	GUIDE-BALLAST 23	SVP-50L3HR,PC G/F 20	1
7-1	SCREW-MACHINE	WSP,PH,+,M4,L12,ZPC(YEL),S	3
8	HOUSING-LAMP,BOTTOM 23	SVP-50L3HR,AL D/	1
8-1	SCREW-TAPTITE	PWH,+, -,S,M3,L7,ZPC(YEL),S	3
9	ASSY MISC-THERMOSTAT	HLP5063W,L62B	1
9-1	SCREW-MACHINE	WSP,PH,+,M3,L8,ZPC(YEL),SW	2
10	COVER-CW 23	SVP-50L3HR,PC G/F20	1
10-1	SCREW-MACHINE	WSP,PH,+,M3,L8,ZPC(YEL),SW	2
11	COVER-LENS PROJECTION	SVP-50L3,PS,T0.3	1
11-1	SCREW-TAPTITE	PWH,+,B,M3,L10,ZPC(YEL),SW	2
12	HOLDER-INTERFACE	SVP-50L3HR,ABS V0 BLK	1
12-1	SCREW-MACHINE	WSP,PH,+,M4,L12,ZPC(YEL),S	3
12-2	ASSY PCB S-ACTUATOR	DP,BP41-00121A,L62B,	1
12-3	SCREW-TAPTITE	PWH,+,B,M3,L10,ZPC(YEL),SW	4
12-4	ASSY MISC-DETECTOR S/W	HLP5063WX/XAA,L62	1
12-5	SCREW-TAPTITE	PWH,+,B,M3,L10,ZPC(YEL),SW	1
13	BRACKET-BASE 23	SVP-50L3HR,SECC,1.6	1
14	HOLDER-BASE	DLP L3,PPS G/F30	1
14-1	SCREW-MACHINE	WSP,PH,+,M4,L12,ZPC(YEL),S	6
15	FAN-DC	AD0612LB-D72GL,P.B.T UL94-Vo,Wire	1
15-1	BRACKET-FAN DMD	DLP L3,SECC,T1.0	1
15-2	SCREW-TAPTITE	BH,+,WT,B,M3,L20,ZPC(YEL),	2
15-3	SCREW-TAPTITE	PWH,+,B,M3,L14,ZPC(YEL),SW	2
15-4	HOLDER-SPACER,RUBBER	B3K,BSBM	2
15-5	RUBBER-DAMP FAN	HLN507W,CR,30,BLACK,V0	2