

LADEN

Service Manual

Washing machine

Toploader

AWF 886/IG

Model	AWF 886/IG	
Version	8519 886 22360	Page
	Technical data	2
	Spare part list	3 - 4
	Exploded view	5 - 6
	Wiring diagram	7
	Circuit diagram	8
	Program diagram	9

Technical data

Dimensions

Height	88.0	cm
Width	40.0	cm
Depth	60.0	cm

Weight

Net weight	59	kg
With package	62	kg

General specifications

Voltage	220± 10% V	
Frequency	50	Hz
Connected load	1.85	kW
Fuse	10	A

Drum data

Drum speed

Washing	55	rpm
Spinning	830	rpm

Capacity

Max. load dry laundry	5	kg
-----------------------	---	----

Electrical building parts

Heating

Type	Tubular radiator	
Rated power draft	1.85	kW
Mains Voltage	220	V

Drain pump

Power consumption	40	W
Capacity	11.5	l/min.
Rotation speed	3000	rpm
Height of drain hose	max. 1.00	m
	min. 0.55	m

Motor

Type	MCA 45/64-148IRA
------	------------------

Timer

Type	EATON EC 4447
The Timer chart includes	
2 basic programmes	- normal washing - delicate washing & wool

Control unit

Type	A1 D21
------	--------

Thermostat

A - a adjustable thermostat	0 - 90	°C
B - a fixed thermostat	60	°C

Pressostat (without laundry)

Foam level	2 ± 1	l
Low level	9 ± 1	l
High level	22 ± 1	l
Safety level	25 ± 1	l

Push button switch

Version with 3 buttons:	- On / Off - Intensive rinse - Eco
-------------------------	--

Spare part list

Model
Service No.
Version

AWF 886/IG
851988622360
851988622360

Pos. No.	12NC Code	Description
001 0	4819 440 19493	Cabinet
002 0	4819 440 18975	Door
010 0	4819 440 19601	Door frame
010 1	4819 404 78394	Water conveyor
012 0	4819 310 18304	Trolley kit
012 2	4819 528 78044	Wheel
012 3	4819 532 68171	Bracket for trolley
012 4	4819 528 78045	Roller rear
012 5	4819 498 68976	Handle for trolley
012 6	4819 462 79426	Support trolley
012 7	4819 530 78037	Clip trolley
013 0	4819 462 48485	Adjust.foot
022 0	4819 440 18976	Panel,side
025 0	4819 440 19651	Bracket
041 0	4819 417 19616	Hinge
053 0	4819 440 19876	Plinth
061 0	4819 466 89041	Counter weight upper
061 1	4819 466 88978	Counter weight lower
061 2	4819 466 88752	Fastener
080 0	4819 529 18054	Shock absorber
100 0	4819 440 19877	Door
110 0	4819 498 69902	Handle,door
121 0	4819 440 19875	Door,inner
130 0	4819 535 78144	Pin Lock
141 0	4819 418 78964	Lid
143 0	4819 459 48602	Tub frame
200 0	4819 418 18275	Tub
201 0	4819 440 19606	Cover
220 0	4819 418 18306	Drum
223 0	4819 418 49713	Drum lifter
252 0	4819 404 78686	Clamp
271 0	4819 358 18134	Belt
272 0	4819 528 88118	Pulley
272 1	4819 532 28263	Ring Cone 10 degrees
292 0	4819 532 68244	Gasket tub
301 0	4819 453 28224	Control panel
303 0	4819 498 69853	Handle
331 0	4819 412 58707	Knob
332 0	4819 410 29043	Button
337 0	4819 412 58709	Knob
343 3	4819 528 38131	Coupling piece
401 0	4819 361 58141	Motor AC
401 1	4819 310 88529	Brush,carbon
421 0	4819 218 38031	Interf.filter
430 0	4819 360 18203	Pump,draining synchronus
451 0	4819 259 28459	Heating element 1850 W
451 2	4819 404 49558	Clamp Heating element
490 0	4819 321 18292	Connect.cable EU
501 0	4819 282 18679	Timer EC 4447
501 1	4819 281 68026	Coil
521 0	4819 214 78406	Unit electrical A1 D21
551 6	4819 282 48255	Thermostat 60 degree
554 0	4819 282 48082	Thermostat adjustable
571 0	4819 281 28265	Valve,magnet
582 0	4812 271 28384	Pressostat

Pos. No.	12NC Code	Description
620 0	4819 276 18265	Switch
621 0	4819 273 28399	Switch on/off
633 0	4819 271 38149	Switch, door
633 1	4819 404 78969	Support
701 0	4819 530 28932	Hose, inlet cold water 1.5 m
702 0	4819 530 28896	Hose
710 0	4819 459 48613	Door,outer
711 0	4819 418 78965	Door,tub
712 0	4819 440 19607	Door,inner
712 1	4819 535 98514	Shaft
712 2	4819 535 98278	Spring
717 0	4819 323 28009	Bowden cable
717 1	4819 466 98972	Rocker
717 5	4819 528 38432	Cam
753 0	4819 530 28811	Chamber,air
754 0	4819 530 28504	Drainhose inner Tub/Pump
755 0	4819 530 48443	Hose over flow
760 0	4819 360 78363	Lid pump
781 0	4819 530 28783	Hose,draining
781 2	4819 532 68554	Sleeve hose
794 5	4819 530 58026	Gasket Air chamber
794 6	4819 530 58031	Gasket
901 0	4819 401 18806	Strap
901 1	4819 492 68337	Strap
901 2	4819 401 18362	Strap SNP 8
901 3	4819 401 18563	Clamp,hose
901 5	4819 535 38038	Clip bearing
902 1	4819 401 18579	Bracket
902 5	4819 401 18572	Holder hose
902 8	4819 404 78396	Tube,stabilizer over flow
903 2	4819 404 49431	Support overflow
903 3	4819 492 68338	Clip tub
903 5	4819 401 18585	Fastener sleeve
903 7	4819 492 68381	Clip
903 9	4819 404 49688	Support Top
910 0	4819 502 38231	Screw
910 1	4819 502 18417	Screw
910 5	4819 502 38265	Screw VAB 4,5x20
910 9	4819 502 38286	Screw PLASGOB ST 45
911 0	4819 502 18465	Screw
911 2	4819 502 18343	Screw TF 5x30
911 3	4819 502 38233	Screw N1 2x1/2
911 4	4819 502 38289	Screw
911 5	4819 502 18202	Screw CHC 6x25
911 6	4819 502 38232	Screw TF 4x20
912 0	4819 500 18108	Screw TH 8x60
912 1	4819 502 18206	Screw TF 4x12
912 7	4819 502 18209	Screw JAPY 8x160
912 8	4819 502 18208	Screw JAPY 8x110
913 1	4819 502 38288	Screw PLASGOB SP T45
913 4	4819 502 18211	Screw earth
914 0	4819 532 68363	Fastener
914 1	4819 505 18283	Nut M 5
915 1	4822 505 10547	Nut
923 0	4819 532 38095	Disc

Spare part list

Model
Service No.
Version

AWF 886/IG
851988622360
851988622360

Pos. No.	12NC Code	Description
923 5	4819 532 58107	Washer 8,3 x 30
923 6	4822 505 10148	Washer
923 7	4819 532 18174	Small plate
931 2	4819 492 38084	Spring Slide
931 3	4819 492 38085	Spring
932 3	4819 492 48131	Spring
934 0	4819 535 48005	Bar
934 1	4819 535 48004	Bar
941 0	4819 520 28029	Bearing, kit
941 1	4819 520 28026	Bearing
951 0	4819 530 58029	Gasket
952 0	4819 462 79347	Gasket container
953 0	4819 325 68041	Gasket V25
961 0	4819 440 19472	Shutter
962 2	4819 462 79336	Protector motor
993 0	4819 530 29028	Guide

Exploded view

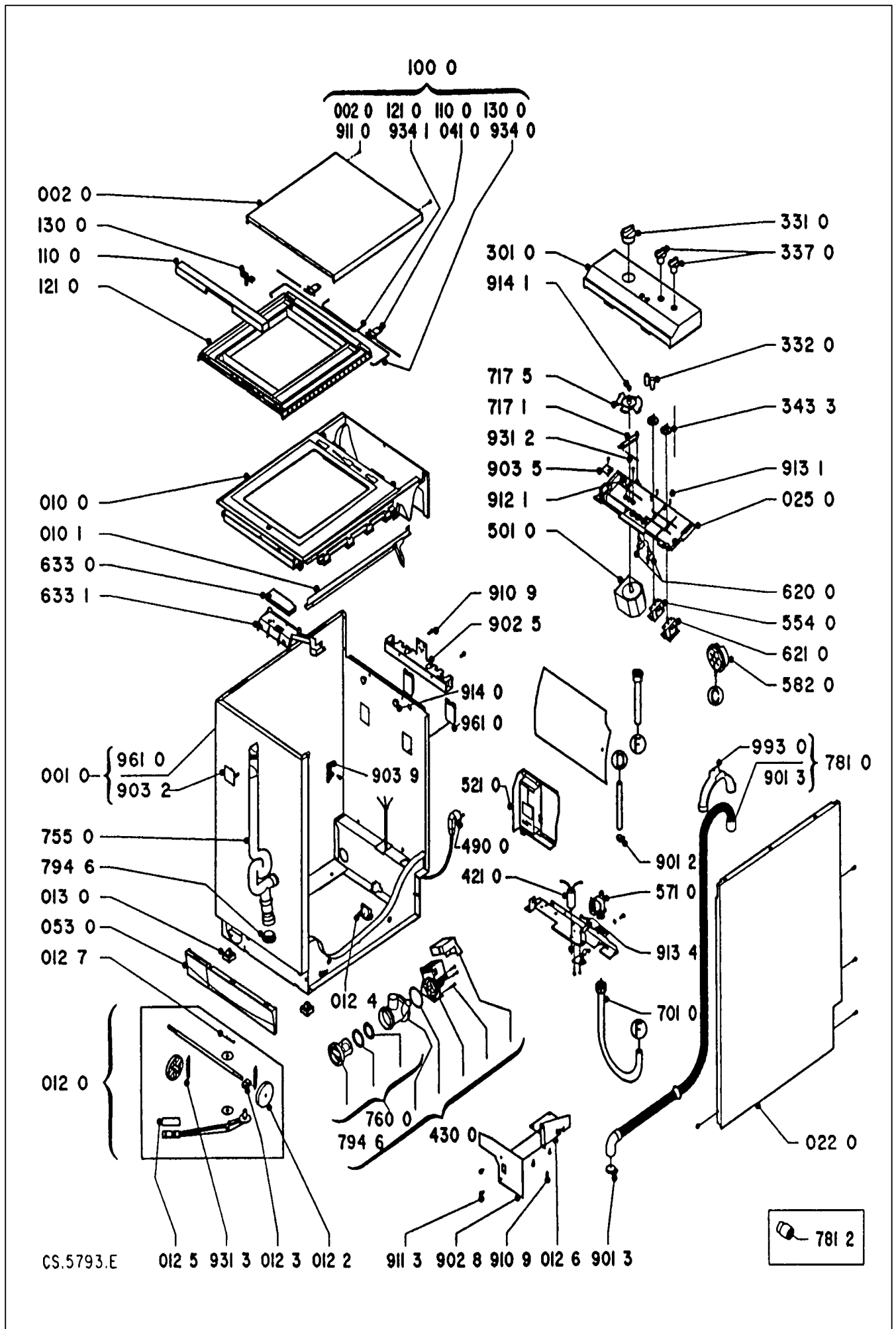

Exploded view diagram of a mechanical assembly. The diagram shows various components and their assembly relationships, indicated by leader lines and part numbers. Key parts include:

- Top Section:** 303 0, 932 3, 711 0 - 143 0, 712 1 - 712 2, 710 0, 141 0, 712 0, 141 0 - 303 0, 711 0, 712 2, 712 1, 911 2, 143 0, 717 0.
- Left Section:** 080 0, 910 5, 911 5, 901 5, 061 0, 061 2, 911 4, 200 0, 951 0, 901 5, 941 1, 912 8, 901 1, 903 7, 451 2, 903 7, 220 0, 911 6, 953 0, 941 0, 201 0, 272 1, 271 0, 272 0, 923 0, 910 1, 451 0, 952 0, 252 0, 551 6.
- Bottom Section:** 754 0, 901 0, 912 7, 923 7, 061 1, 915 1, 501 1, 401 1, 401 0, 912 0, 923 6, 923 5, 915 1, 962 2, 794 5, 911 0, -753 0.
- Other Labels:** NOIR BLACK, 902 1, 223 0, 292 0, 903 3, 910 0, 901 2, 702 0.

CS.5795.E

Wiring diagram

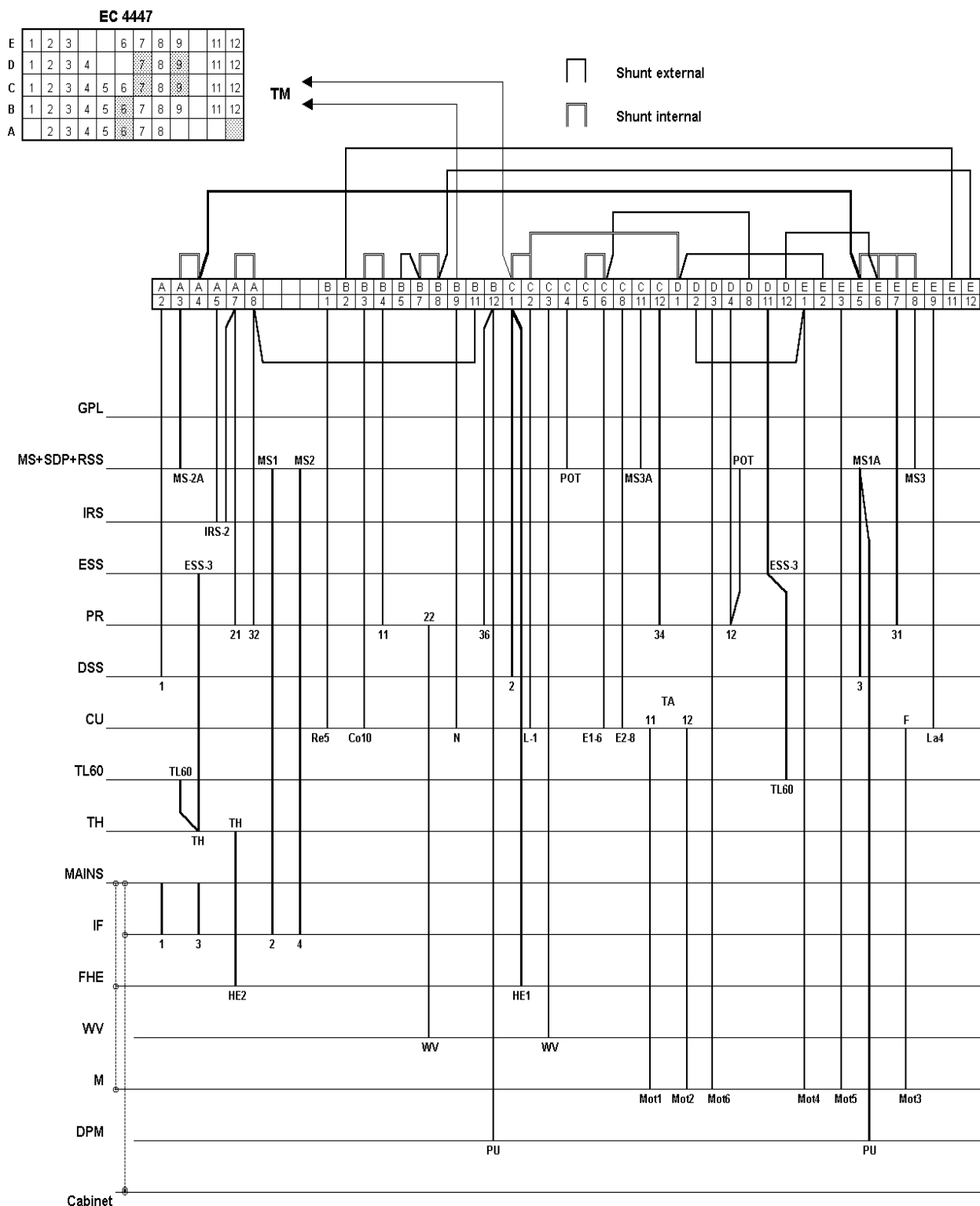

867T

CU - Contol Unit
 DPM - Draining Pump Motor
 DSS - Door Safety Switch
 ESS - Energy Saving Switch (Economy)
 FHE - Fused Heating Element
 GPL - Gas Pilot Lamp
 IF - Interference Filter
 IRS - Intensive Rinse Switch
 M - Main Motor
 MS - Main Switch

PR - Pressostat
 PREH - Pressostat Extra High (overflow)
 PRH - Pressostat High level
 PRL - Pressostat Low level
 PRM - Pressostat Mousse (foam detection)
 RSS - Rinse Stop Switch
 SDP - Spin Drying Potentiometer
 TH - Thermostat manual
 TL60 - Thermostat Limiter 60°C
 TM - Timer Motor
 WV - Water Valve inlet

4211 012 72991

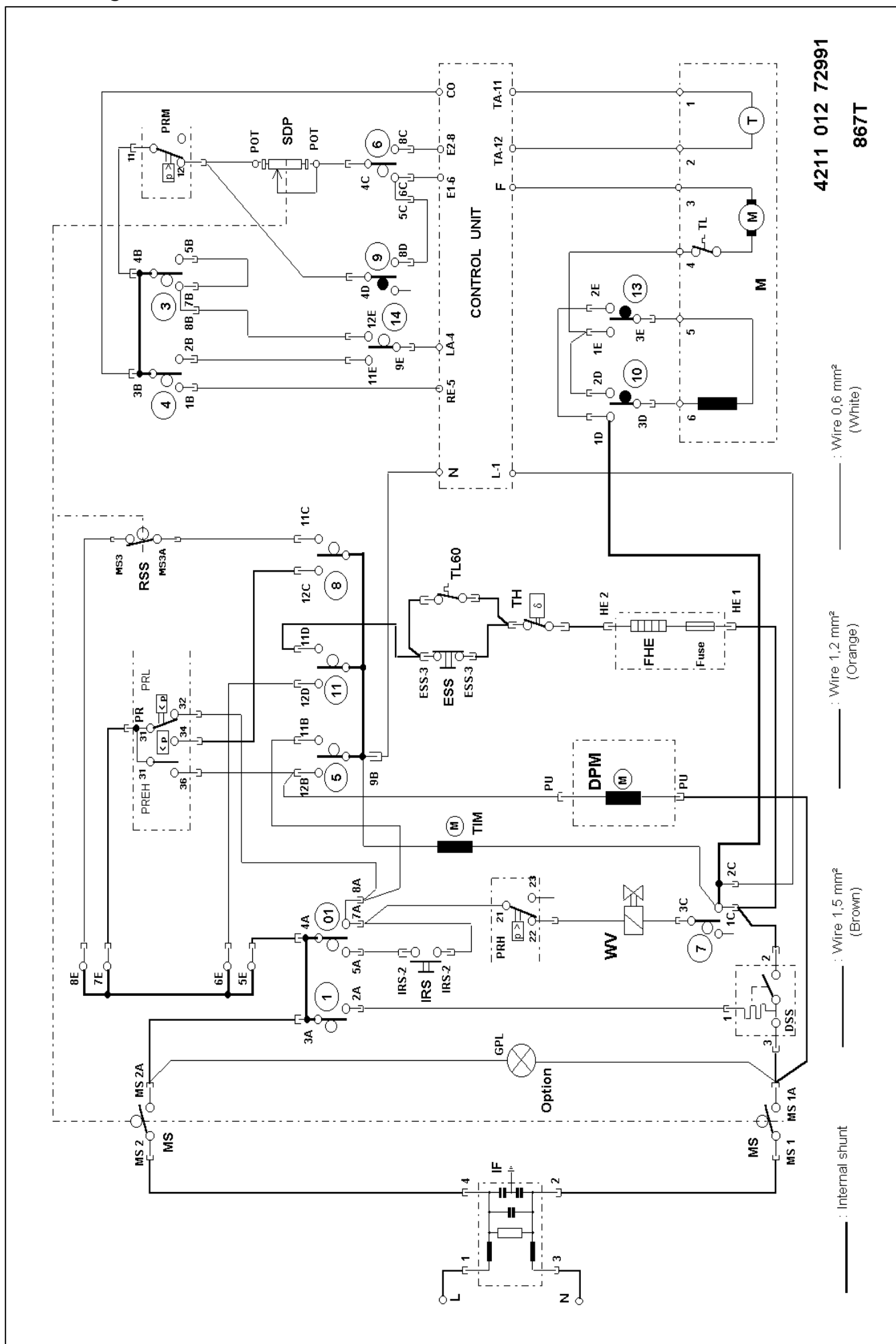

CS.5778.B