

# SERVICE MANUAL

# BE-5 CHASSIS

MODEL	COMMANDER	DEST.	CHASSIS NO.	MODEL	COMMANDER	DEST.	CHASSIS NO.
KV-20WS1A	RM-836	Italian	SCC-K31F-A	KV-20WS1K	RM-836	OIRT	SCC-K35M-A
KV-20WS1B	RM-836	French	SCC-K36F-A	KV-20WS1R	RM-836	OIRT	SCC-K35L-A
KV-20WS1D	RM-836	AEP	SCC-K32H-A	KV-20WS1U	RM-836	UK	SCC-K33D-A
KV-20WS1E	RM-836	Spanish	SCC-K30H-A				



TRINITRON® COLOR TV  
**SONY®**

## SECTION 4

### CIRCUIT ADJUSTMENTS

#### 4-1. ELECTRICAL ADJUSTMENTS

Service adjustment to this model can be performed with the supplied Remote Control Commander RM-836.

Range of adjustments available from the on screen menu system.

##### HOW TO ENTER INTO SERVICE MODE

1. Turn on the main power of the set and enter into stand-by mode.
2. Press the following sequence of buttons on the Remote Control Commander.

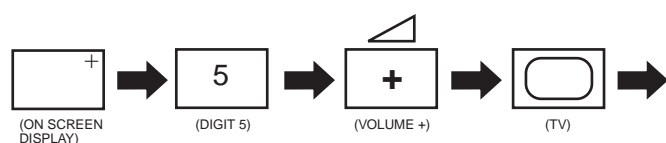

"TT-- " will appear in the top right corner of the screen  
Other status information will also be displayed.

3. Press the MENU button on the Remote Commander to obtain the menu on the screen.

Adjust.			
▷ 16:9	ON		
System			
Text			
AGC	33	00-63	
PLL	32	00-63	
<b>V1</b>	<b>00-01</b>	<b>SONY</b>	<b>BE-5</b>

Software version

Adjustment	Set	Range
V size	21	0 - 63
V breth	32	0 - 63
Pin amp	12	0 - 63
Para. tilt	43	0 - 63
V linear	42	0 - 63
Corner corr	05	0 - 63
H size	34	0 - 63
V pos	00	0 - 63
H phase	42	0 - 63
Blue	26	0 - 63
Green	32	0 - 63
Red	42	0 - 63
HV blk 1	00	0 - 63
HV blk 2	00	0 - 63
V cent	06	0 - 63
Zwei max	36	0 - 63
zwei min	18	0 - 63

4. Press the Blue (Next) or Green (previous) buttons to select the adjustment item from the table.
5. Press the Yellow (+) or Red (-) buttons to change the data as required.
6. Turn off the power to quit the service mode when adjustments are completed.

## 4-2. TEST MODE 2:

TT -- Mode is available by pressing the Test button twice, O.S.D 'TT --' appears. The functions described below are available by pressing two digits. To release the 'TT --' mode, press 0 twice, press 'TEST' , press 'TV' or switch the TV into Stand-by mode.

00	Switch 'TT—' Mode off.
01	Set picture level to maximum.
02	Set picture level to minimum.
03	Set volume to 35%.
04	Set volume to 50%.
05	Set volume to 65%.
06	Set volume to 80%.
07	Ageing condition (picture max., brightness max.).
08	Shipping condition (Analog values are RESET to factory setting, Prog 1 is selected, TT—mode switched off, Vol = 35%).
09	Dummy.
10	No function.
11	Dummy
12	Dummy.
13	Dummy.
14	Dummy.
15	Read factory setting from ROM to NVM - Reads Volume, Brightness, Picture, Hue, Sharpness and Colour values from ROM to the actual used values (Last Power Memory).
16	Save actual used values as reset values.
17	Enable / Disable Sharpness Operation.
18	Dummy.
19	RGB priority.
20	No function.
21	No function.
22	Sub Colour (Pal / Secam Different Stores)
23	Sub Brightness.
24	RGB priority on.

25	Destination Systems DKE.
26	Destination Systems I/U.
27	Destination System I/I'.
28	Destination BG only.
29	Dummy.
30-31	No function.
32	Picture level to 50%
33-35	No function.
36	Audio mute ON.
37	OSD off.
38	Enter G2 adjustment mode.
39	Sub-brightness
40	No function.
41	Re-initialise NVM.
42	Dummy.
43	Re-initialise Geometry settings.
44-47	Dummy
48	Set NVM testbyte to 44h in NVM.
49	Erase NVM testbyte
50	No function.
51	Toggle 60/100 programs.

**Note :** For Test Modes 41 - 51, it is necessary to ensure that the TV is set to Prog 59.

### DEFLECTION SYSTEM ADJUSTMENT

1. Enter into the service mode.
2. Using the Blue or Green buttons select the Adjust item.
3. Press the Yellow button to enter the adjustment submenu.
4. Select and adjust each item in order to obtain the optimum image.

See Note on page 22

Adjustment	Set	Range
V size	21	0 - 63
V breth	32	0 - 63
Pin amp	12	0 - 63
Para. tilt	43	0 - 63
V linear	42	0 - 63
Corner corr	05	0 - 63
H size	34	0 - 63
V pos	00	0 - 63
H phase	42	0 - 63
Blue	26	0 - 63
Green	32	0 - 63
Red	42	0 - 63
HV blk 1	00	0 - 63
HV blk 2	00	0 - 63
V cent	06	0 - 63
Zwei max	36	0 - 63
zwei min	18	0 - 63

VERT, AMPL

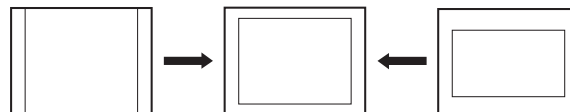

V, LINEAR

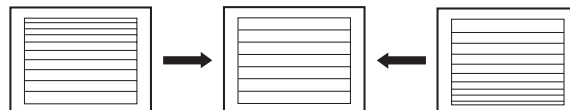

V, CENTRE

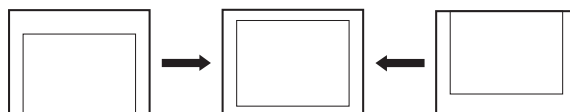

H, CENTRE

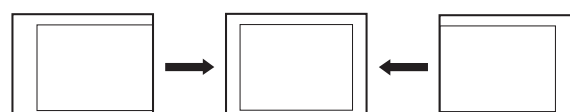

PAR TILT

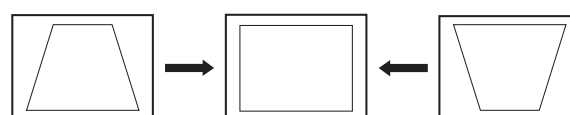

PAR AMP

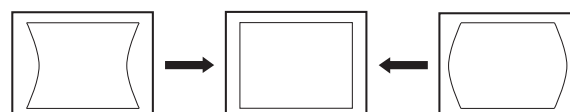

### AGC ADJUSTMENT

1. Receive a signal of 63dBuV / 75 ohm terminated via the tuner socket.
2. Measure the voltage at AGC TP.
3. Adjust TU101 RV to obtain a voltage of  $3.0 \pm 0.3V$ .

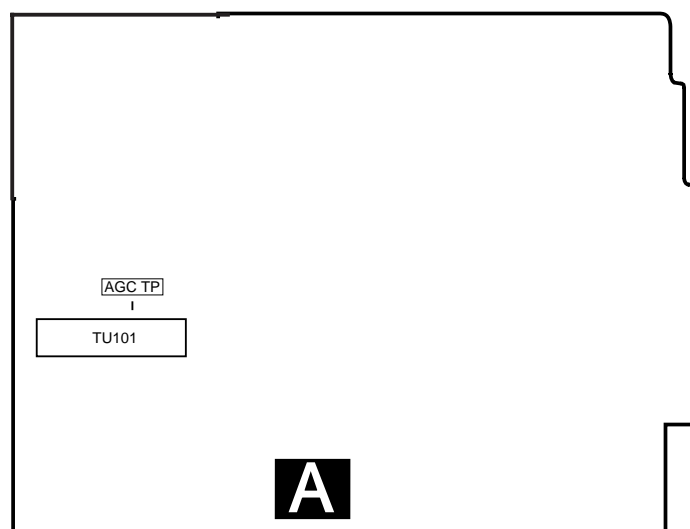

- A Board Component Side -