

**EXPLODED PARTS DIAGRAM**

MODEL	FIG.
<b>C-765 Ultra Zoom</b>	<b>1/2</b>
<b>OLYMPUS CORPORATION</b>	

Rev.3  
Ver.1  
2005.01

A

B

C

D

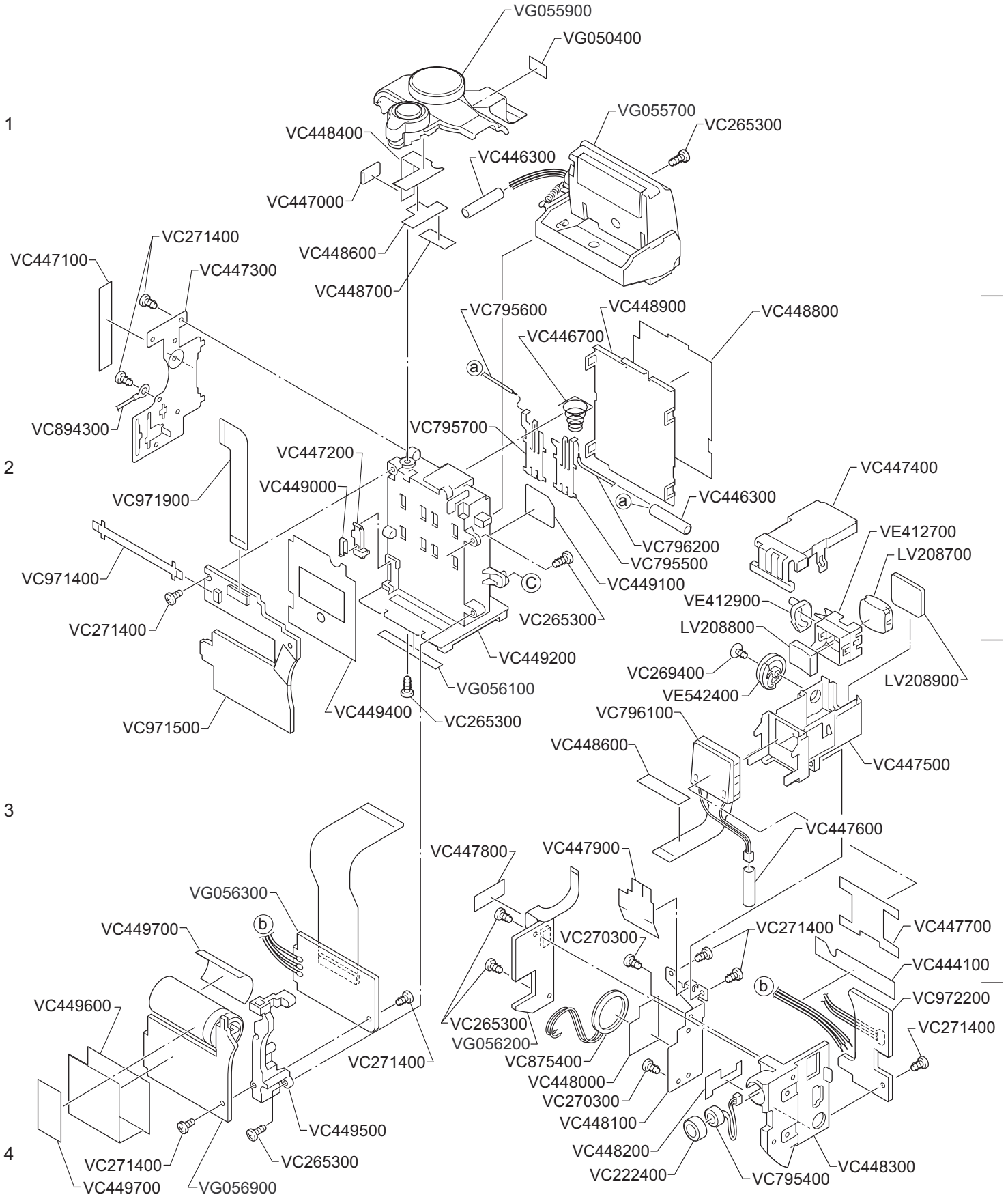

## EXPLODED PARTS DIAGRAM

MODEL	FIG.
C-765 Ultra Zoom	2/2
<b>OLYMPUS CORPORATION</b>	

Ver.1  
2004.04

REF NO	PARTS NO	DESCRIPTION	REMARKS	NOTE
	LV208700	LENS EVF 2-T	2-D2	
	LV208800	LENS EVF 1-O	2-C2	
	LV208900	LENS EVF 1-F	2-D3	
	VC222400	MIC HOLDER	2-C4	
	VC265300	SCREW 1.7X4	1-B3,B4,	
	VC265600	SPECIAL SCREW 1.7X2.2	1-A1,A2	
	VC266300	S SCREW 1.4X5	1-A3,B3	
	VC269400	S SCREW 1.6X3.0	2-C3	
	VC270300	SCREW 1.7X2.5	2-C3,C4	
	VC271400	SCREW 1.7X3	1-B1,B4,D2,D3,	
	VC275500	SCREW 1.7X5	1-A3	
	VC275700	SCREW 1.7X4.0	1-D1	
	VC443600	PUK SCREW 1.7X2.5	1-C3	
	VC443800	PUK SCREW 1.7X6	1-C4	
	VC443900	PUK SCREW 1.7X3	1-B4,C1	
	VC444000	SHIELD TAPE 6	1-C2	
	VC444100	SPACER PLATE	2-D3	
	VC444200	INSULATION 3	1-A2	
	VC444300	LCD PLATE	1-A1	
	VC444400	SHIELD TAPE 3	1-B1	
	VC444500	SHIELD TAPE 4	1-B1	
	VC444800	4KEY BUTTON	1-B2	
	VC444900	POWER BUTTON	1-C2	
	VC445100	VIEW BUTTON	1-C2	
	VC445200	ACCESS WINDOW	1-C1	
	VC445300	SHIELD TAPE 5	1-B1	
	VC445500	SHIELD TAPE 1	1-B3	
	VC445600	SHIELD TAPE 2	1-C3	
	VC445700	COVER SHAFT	1-C4	
	VC446000	B PLATE	1-D3	
	VC446100	INSULATION 2	1-D2	
	VC446200	B COVER SPRING	1-D3	
	VC446300	SILICON TUBE	2-C2	
	VC446400	B COVER SHAFT	1-C4	
	VC446500	SHIELD PLATE	1-B2	
	VC446600	INSULATION 1	1-C2	
	VC446700	B SPRING	2-C2	
	VC446800	TRIPOD SOCKET	1-B3	
	VC446900	SELF WINDOW	1-B3	
	VC447000	PAD	2-B1	
	VC447100	LEAD HOLD TAPE	2-A1	
	VC447200	LOCK LEVER	2-B2	
	VC447300	SIDE PLATE	2-A1	
	VC447400	F COVER	2-D2	
	VC447500	F FRAME	2-D3	
	VC447600	TUBE	2-D3	
	VC447700	LIGHT PROOF	2-D3	
	VC447800	INSULATION 9	2-B3	

REF NO	PARTS NO	DESCRIPTION	REMARKS	NOTE
	VC447900	INSULATION 8	2-C3	
	VC448000	SPEAKER TAPE	2-C4	
	VC448100	SPEAKER PLATE	2-C4	
	VC448200	SHIELD TAPE 9	2-C4	
	VC448300	JACK BASE	2-D4	
	VC448400	SHIELD PLATE 8	2-B1	
	VC448500	SHIELD TAPE 7	1-C3	
	VC448600	INSULATION 7	2-B1	
	VC448700	INSULATION 6	2-B1	
	VC448800	B PLATE TAPE	2-D2	
	VC448900	B PLATE	2-C2	
	VC449000	LOCK LEVER SPRING	2-B2	
	VC449100	BATTERY LABEL	2-C2	
	VC449200	BATTERY CASE	2-C3	
	VC449400	INSULATION 5	2-B3	
	VC449500	PCB HOLDER	2-B4	
	VC449600	INSULATION 4	2-A4	
	VC449700	PW1 FPC TAPE	2-A4	
	VC449700	PW1 FPC TAPE	2-A3	
S3002	VC795200	POP UP SW	CP1	
S3001	VC795300	B COVER SW	CP1	
	VC795400	MICROPHONE	2-D4	
	VC795500	BATTERY TERMINAL B	2-C2	
	VC795600	BATTERY LEAD(+)	2-B2	
	VC795700	BATTERY TERMINAL A	2-B2	
	VC795800	LCD	1-B1	
	VC795900	LCD LEAD	1-B2	
	VC796000	FILTER	1-A2	
	VC796100	EVF	2-C3	
	VC796200	BATTERY LEAD(-)	2-C2	
F5051	VC796600	FUSE 32V 6A	PW2	
5002,5003	VC796700	FUSE 32V 2A (F5001,5002,5003,5004)	PW1,ST1	
	VC866000	PHONE JACK	CP1	
	VC866700	SOCKET,DC	PW2	
	VC875400	BUZZER	2-C4	
CN110	VC885400	SOCKET,USB 5P	CP1	
	VC894300	TERMINAL CORD	2-A2	
	VC971300	CA1 FPC	1-B2	
	VC971400	TB3 FPC	2-A2	
	VC971500	TB1 PCB	2-A3	
	VC971900	TB1 FPC	2-A2	
	VC972100	TB3 PCB	1-B3	
	VC972200	PW2 PCB	2-D4	
	VC972400	MODE FPC	1-A1	
	VE089300	CLICK BALL	1-A3,C4	
	VE209800	MOUNTING STRAP,L	1-A3	
	VE209900	MOUNTING STRAP,R	1-C4	
	VE210000	STRAP HOOK	1-A3,C4	

REF NO	PARTS NO	DESCRIPTION	REMARKS	NOTE
	VE210200	CLICK SPRING	1-A3,C4	
	VE335900	SPECIAL SCREW-1.6X4.0	1-A2,B3	
	VE412700	EVF LENS HOLDER	2-D2	
	VE412900	EVF COM	2-C2	
	VE452300	FILTER SPACER	1-B2	
	VE542400	DIOPTOR DIAL	2-C3	
	VG050200	CCD LEAD	1-D3	
	VG050400	DCT	2-C1	
	VG051200	PLATE TAPE	1-B2	
	VG051300	LCD TAPE	1-B2	
	VG052900	SHEET TAPE	1-A2	
	VG053000	SELF BUTTON	1-C2	
	VG055600	FRONT COVER	1-A4	NEW
	VG055700	FLASH UNIT	2-C1	NEW
	VG055800	LEAD SPACER	1-C2	NEW
	VG055900	MODE DIAL UNIT	2-C1	NEW
	VG056000	BACK COVER	1-D1	NEW
	VG056100	CAUTION LABEL	2-B3	NEW
	VG056200	TB2 PCB	2-B4	NEW
	VG056300	PW1 PCB	2-A3	NEW
	VG056400	SCREW 2X3.5	1-C2	NEW
	VG056500	TERMINAL COVER	1-C4	NEW
	VG056600	BATTERY COVER	1-D3	NEW
	VG056700	CA1PCB	1-B3	NEW
	VG056800	CP1PCB	1-D3	NEW
	VG056900	ST1 PCB	2-A4	NEW
	VJ608400	LENS ASSY	1-A3	