

CDX-L410

SERVICE MANUAL

Ver 1.0 2001.12

AEP Model
UK Model



- The tuner and CD sections have no adjustments.

Model Name Using Similar Mechanism	CDX-L350/L360
CD Drive Mechanism Type	MG-393X-121//Q
Optical Pick-up Name	KSS-720A

SPECIFICATIONS

CD player section

Signal-to-noise ratio	90 dB
Frequency response	10 – 20,000 Hz
Wow and flutter	Below measurable limit

Tuner section

FM

Tuning range	87.5 – 108.0 MHz
Aerial terminal	External aerial connector
Intermediate frequency	10.7 MHz/450 kHz
Usable sensitivity	8 dBf
Selectivity	75 dB at 400 kHz
Signal-to-noise ratio	66 dB (stereo), 72 dB (mono)
Harmonic distortion at 1 kHz	0.6% (stereo), 0.3% (mono)
Separation	35 dB at 1 kHz
Frequency response	30 – 15,000 Hz

MW/LW

Tuning range	MW: 531 – 1,602 kHz LW: 153 – 279 kHz
Aerial terminal	External aerial connector
Intermediate frequency	10.7 MHz/450 kHz
Sensitivity	MW: 30 μ V LW: 40 μ V

Power amplifier section

Outputs	Speaker outputs (sure seal connectors)
Speaker impedance	4 – 8 ohms
Maximum power output	45 W \times 4 (at 4 ohms)

General

Outputs	Power aerial relay control lead
Inputs	Telephone ATT control lead
Tone controls	Bass \pm 9 dB at 100 Hz Treble \pm 9 dB at 10 kHz
Power requirements	12 V DC car battery (negative ground)
Dimensions	Approx. 178 \times 50 \times 177 mm (w/h/d)
Mounting dimension	Approx. 182 \times 53 \times 162 mm (w/h/d)
Mass	Approx. 1.2 kg
Supplied accessories	Parts for installation and connections (1 set) Front panel case (1)

Design and specifications are subject to change without notice.

FM/MW/LW COMPACT DISC PLAYER

9-873-444-01

2001L0400-1

© 2001. 12

Sony Corporation

e Vehicle Company

Published by Sony Engineering Corporation

SONY®

SERVICE NOTES



This label is located on the bottom of the chassis.



This label is located on the drive unit's internal chassis.

When replacing the chassis (T.U) of mechanism deck which have the "CAUTION LABEL" attached, please be sure to put a new LABEL (OP CAUTION) (3-223-913-01) to the chassis (T.U).

NOTES ON HANDLING THE OPTICAL PICK-UP BLOCK OR BASE UNIT

The laser diode in the optical pick-up block may suffer electrostatic breakdown because of the potential difference generated by the charged electrostatic load, etc. on clothing and the human body. During repair, pay attention to electrostatic breakdown and also use the procedure in the printed matter which is included in the repair parts. The flexible board is easily damaged and should be handled with care.

NOTES ON LASER DIODE EMISSION CHECK

The laser beam on this model is concentrated so as to be focused on the disc reflective surface by the objective lens in the optical pick-up block. Therefore, when checking the laser diode emission, observe from more than 30 cm away from the objective lens.

Notes on Chip Component Replacement

- Never reuse a disconnected chip component.
- Notice that the minus side of a tantalum capacitor may be damaged by heat.

TEST DISCS

This set can playback CD-R and CD-ROM discs. The following test discs should be used to check the capability:

CD-R test disc TCD-R082LMT (Part No. J-2501-063-1)
CD-RW test disc TCD-W082L (Part No. J-2501-063-2)

SAFETY-RELATED COMPONENT WARNING!!

COMPONENTS IDENTIFIED BY MARK \triangle OR DOTTED LINE WITH MARK \triangle ON THE SCHEMATIC DIAGRAMS AND IN THE PARTS LIST ARE CRITICAL TO SAFE OPERATION. REPLACE THESE COMPONENTS WITH SONY PARTS WHOSE PART NUMBERS APPEAR AS SHOWN IN THIS MANUAL OR IN SUPPLEMENTS PUBLISHED BY SONY.

EXTENSION CABLE AND SERVICE POSITION

When repairing or servicing this set, connect the jig (extension cable) as shown below.

- Connect the MAIN board (CNP301) and the SERVO board (CN1) with the extension cable (Part No. J-2502-011-1).

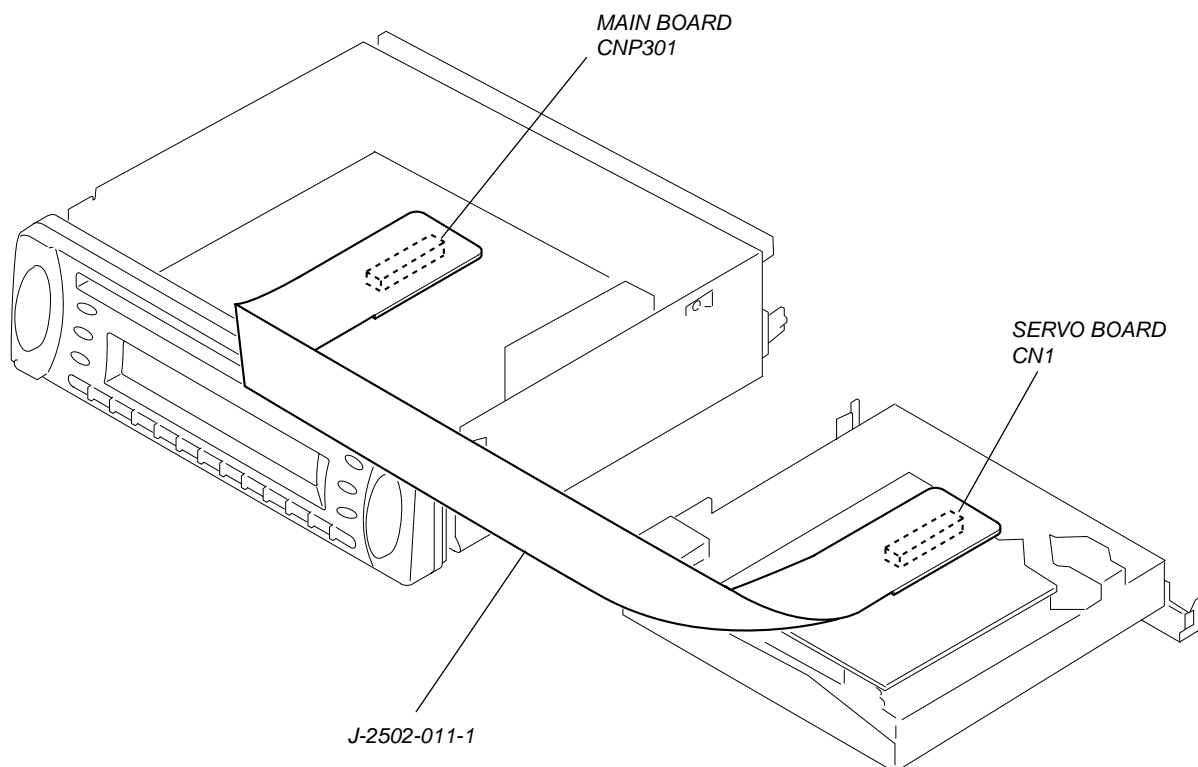
**TABLE OF CONTENTS****1. GENERAL**

Location of controls	4
Notes on CD-R/CD-RW discs	4
Connections	5

2. DISASSEMBLY

2-1. Sub Panel Assy	6
2-2. CD Mechanism Block	7
2-3. Main Board	7
2-4. Heat Sink	8
2-5. Chassis (T.U) Assy	8
2-6. Disc in Board	9
2-7. Servo Board	9
2-8. Arm Roller Assy	10
2-9. Chassis (OP) Assy	10
2-10. Optical Pick-up Block	11

3. DIAGRAMS

3-1. IC Pin Description	12
3-2. Circuit Boards Location	14

3-3. Block Diagram –CD Section–	15
3-4. Block Diagram –Tuner Section–	16
3-5. Block Diagram –Display Section–	17
3-6. Printed Wiring Boards –CD Mechanism Section–	18
3-7. Schematic Diagram –CD Mechanism Section–	20
3-8. Printed Wiring Board –Main Section–	21
3-9. Schematic Diagram –Main Section (1/2)–	22
3-10. Schematic Diagram –Main Section (2/2)–	23
3-11. Printed Wiring Board –Key Section–	24
3-12. Schematic Diagram –Key Section–	25

4. EXPLODED VIEWS

4-1. Chassis Section	28
4-2. Front panel Section	29
4-3. CD Mechanism Section (1)	30
4-4. CD Mechanism Section (2)	31
4-5. CD Mechanism Section (3)	32

5. ELECTRICAL PARTS LIST	33
---------------------------------------	-----------

SECTION 1 GENERAL

This section is extracted
from instruction manual.

Location of controls

Refer to the pages listed for details.

CD : During playback **RADIO** : During radio reception

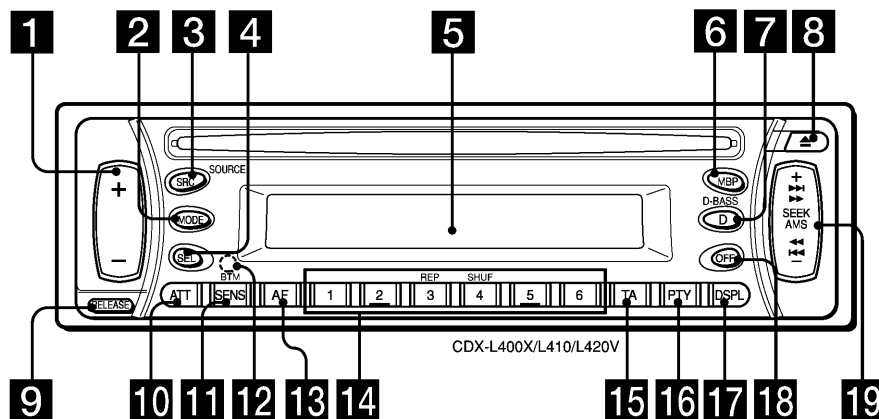

- | | |
|--|--|
| <p>1 Volume +/- button 8, 13, 17</p> <p>2 MODE button
RADIO 10, 11, 13</p> <p>3 SRC (SOURCE) (TUNER/CD) button
8, 10, 11, 13</p> <p>4 SEL (select) button 8, 15, 17, 18</p> <p>5 Display window</p> <p>6 MBP (My Best sound Position) button 18</p> <p>7 D (D-BASS) button 18</p> <p>8 ▲ (eject) button 8</p> <p>9 RELEASE (front panel release) button 7</p> <p>10 ATT (attenuate) button 17</p> <p>11 SENS/BTM button 10, 11, 13</p> <p>12 RESET button (located on the front side of the unit, behind the front panel) 6</p> <p>13 AF button 12, 13</p> | <p>14 Number buttons 17
CD
③ REP 9
④ SHUF 9
RADIO 10, 11, 12, 13, 15</p> <p>15 TA button 13</p> <p>16 PTY (programme type) button 14</p> <p>17 DSPL (display mode change) button
8, 9, 11</p> <p>18 OFF button* 7, 8</p> <p>19 SEEK/AMS +/- button
CD 8
RADIO 10, 11, 12, 14</p> |
|--|--|

* **Warning when installing in a car without an ACC (accessory) position on the ignition key switch**
Be sure to press **OFF** on the unit for 2 seconds to turn off the clock display after turning off the engine.
Otherwise, the clock display does not turn off and this causes battery drain.

Notes on CD-R/CD-RW discs

- You can play CD-Rs (recordable CDs)/CD-RWs (rewritable CDs) designed for audio use on this unit.
Look for these marks to distinguish CD-Rs/CD-RWs for audio use.



These marks denote that a disc is not for audio use.



- Some CD-Rs/CD-RWs (depending on the equipment used for its recording or the condition of the disc) may not play on this unit.
- You cannot play a CD-R/CD-RW that is not finalized*.

* A process necessary for a recorded CD-R/CD-RW disc to be played on the audio CD player.

SECTION 2 DISASSEMBLY

Note : This set can be disassemble according to the following sequence.

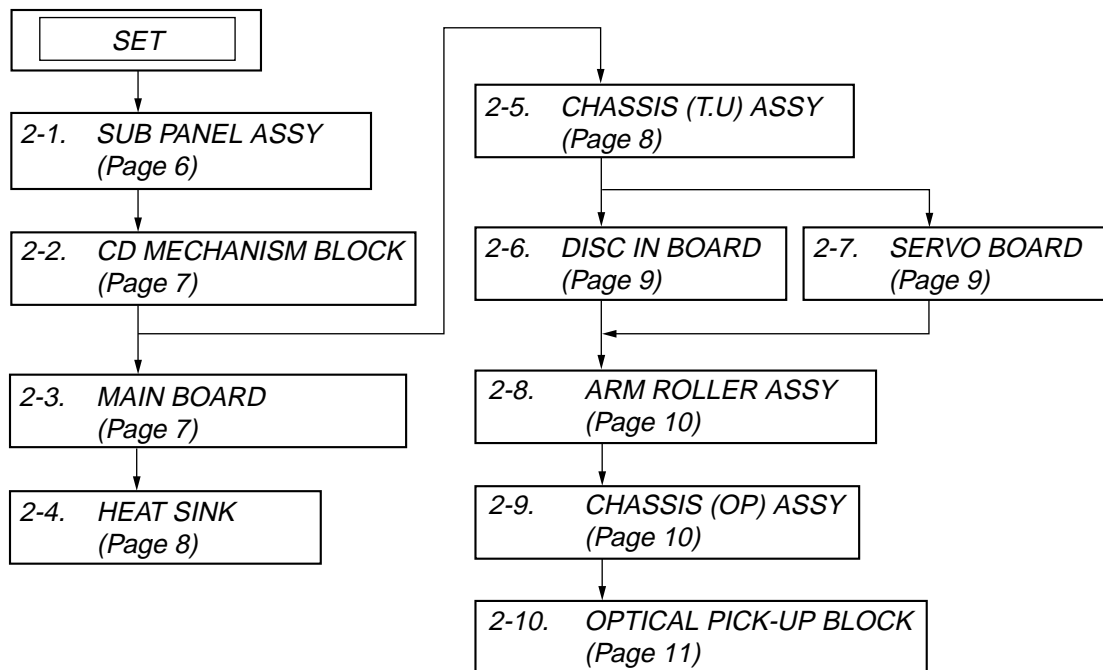

Note : Follow the disassembly procedure in the numerical order given.

2-1. SUB PANEL ASSY

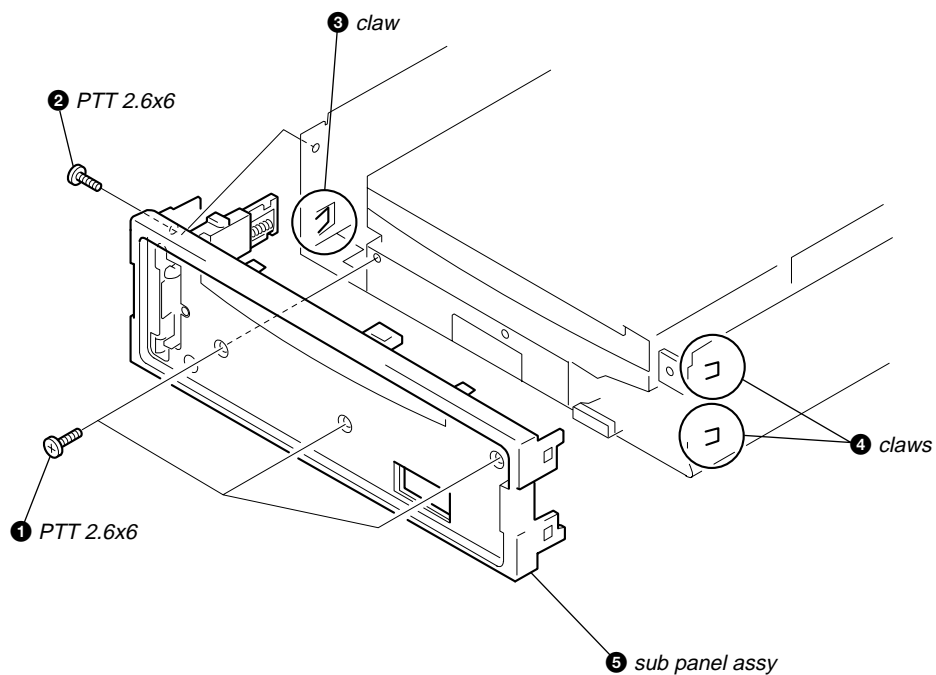

2-2. CD MECHANISM BLOCK

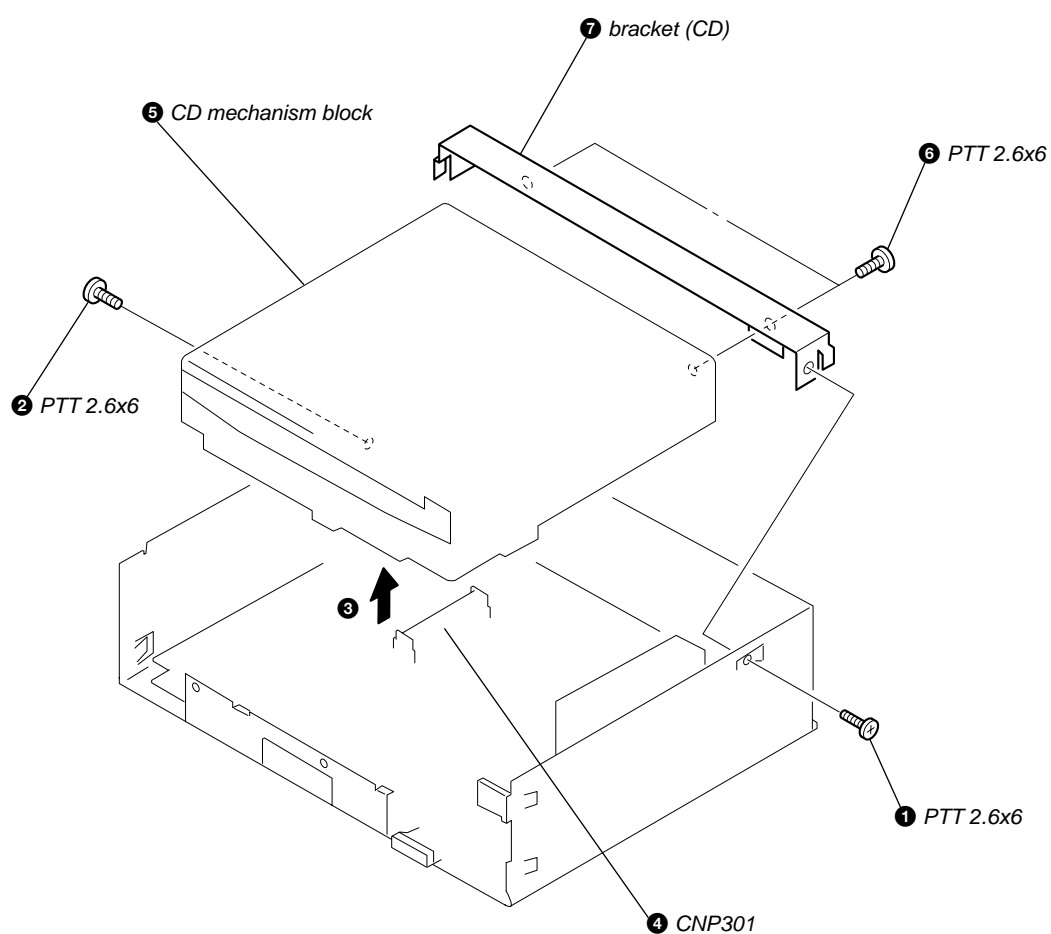

2-3. MAIN BOARD

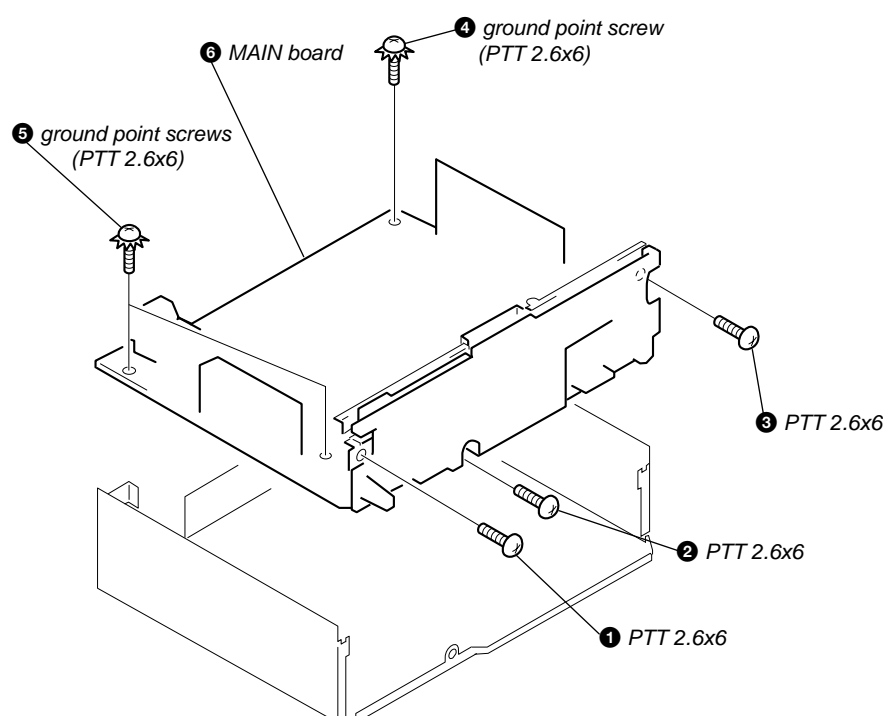

2-4. HEAT SINK

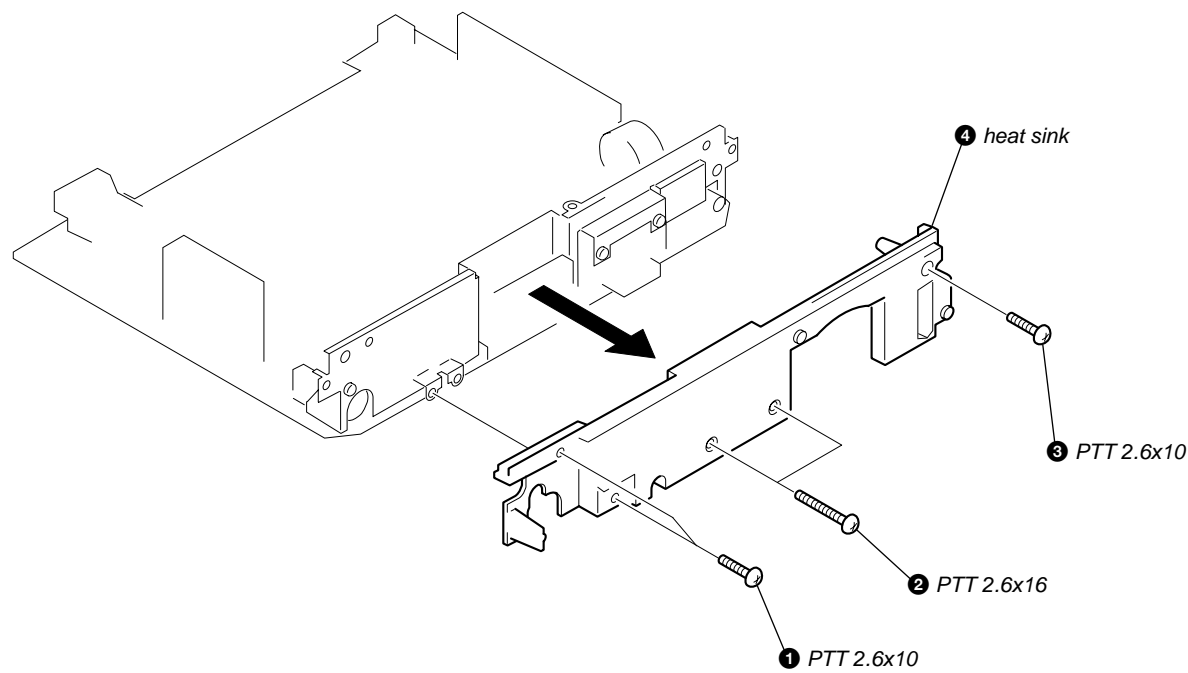

2-5. CHASSIS (T.U) ASSY

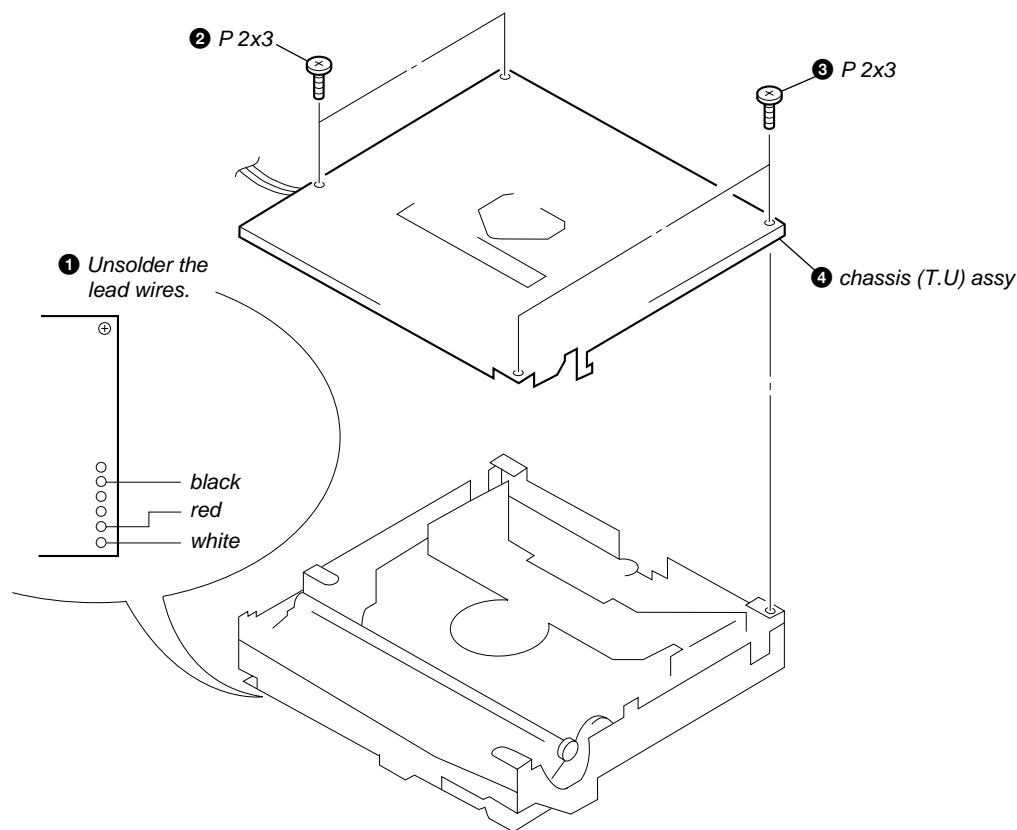

2-6. DISC IN BOARD

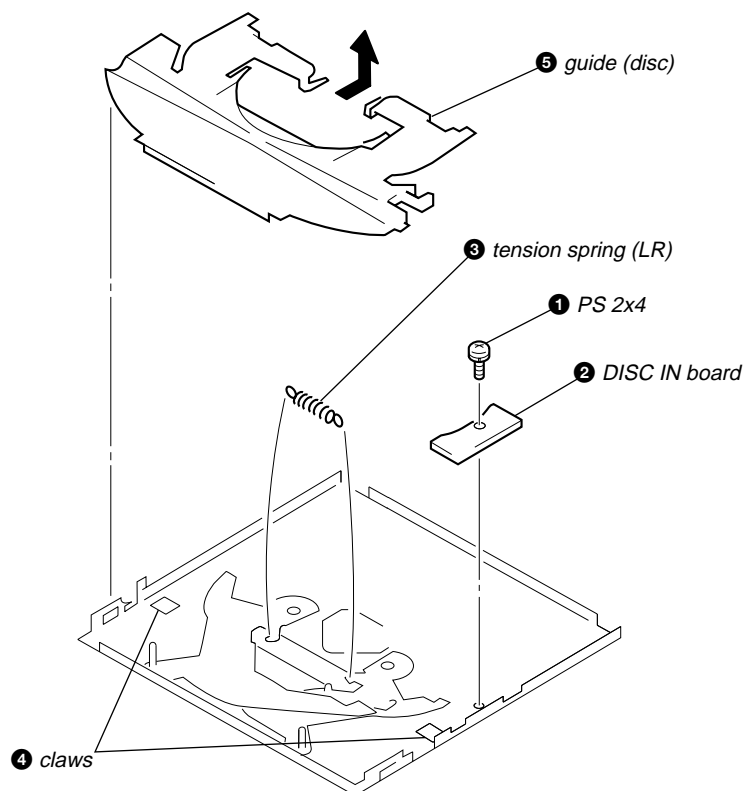

2-7. SERVO BOARD

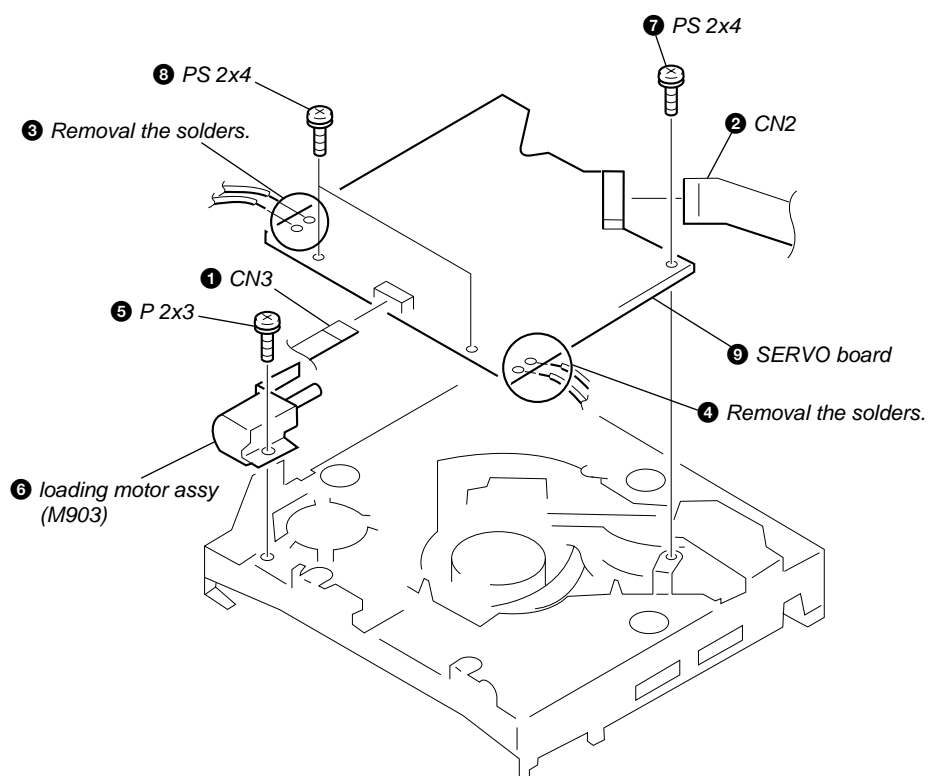

2-8. ARM ROLLER ASSY

- When installing, take note of the positions arm (roller) and washers. (Fig. 1)

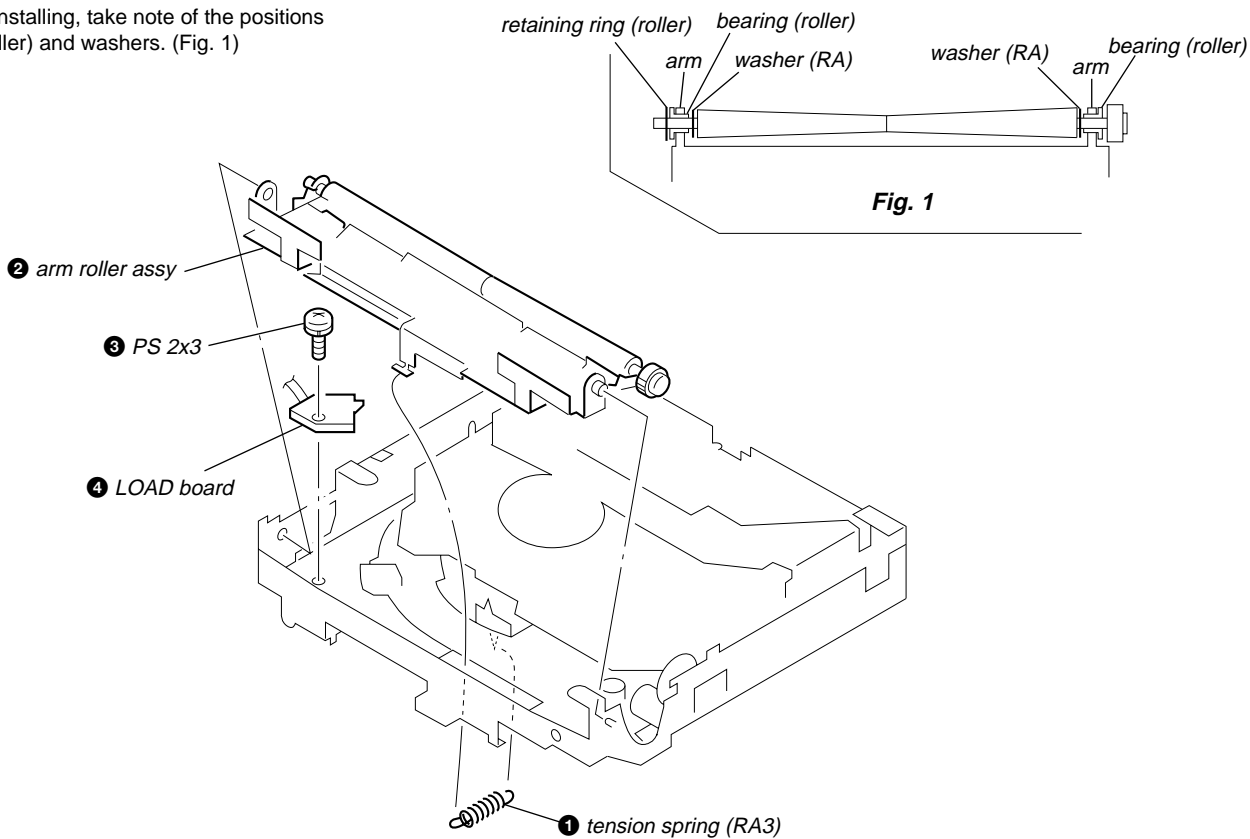

2-9. CHASSIS (OP) ASSY

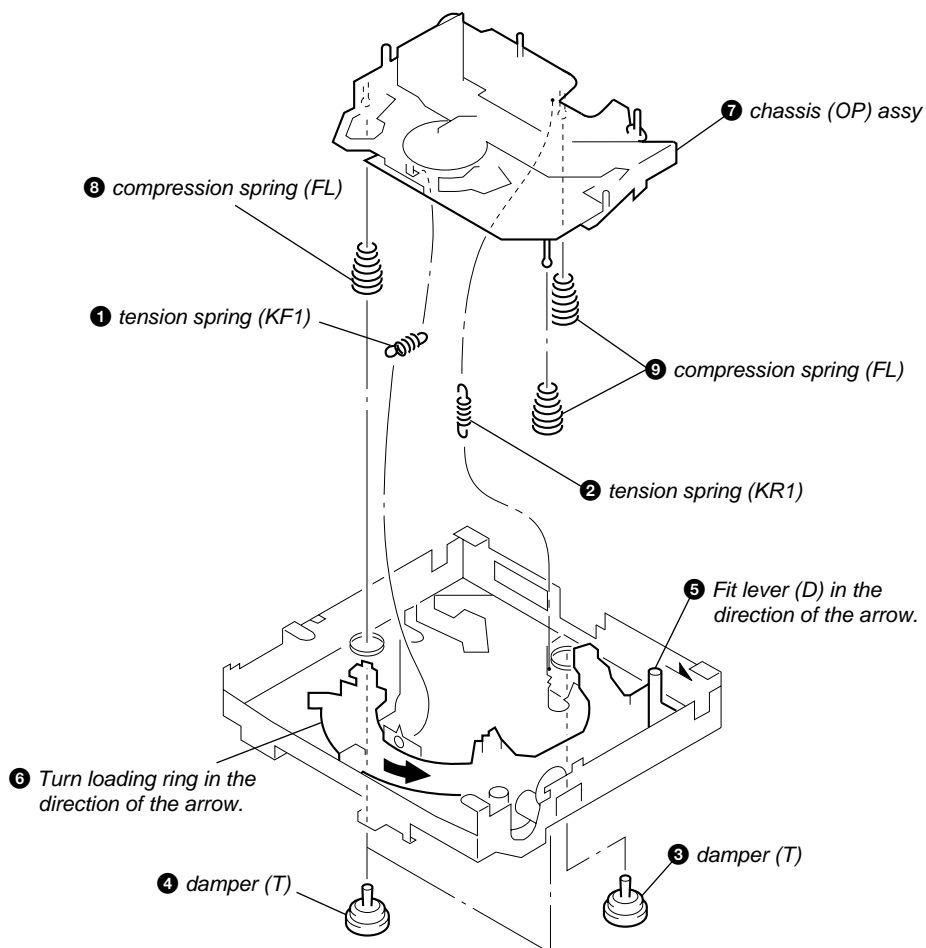

2-10. OPTICAL PICK-UP BLOCK

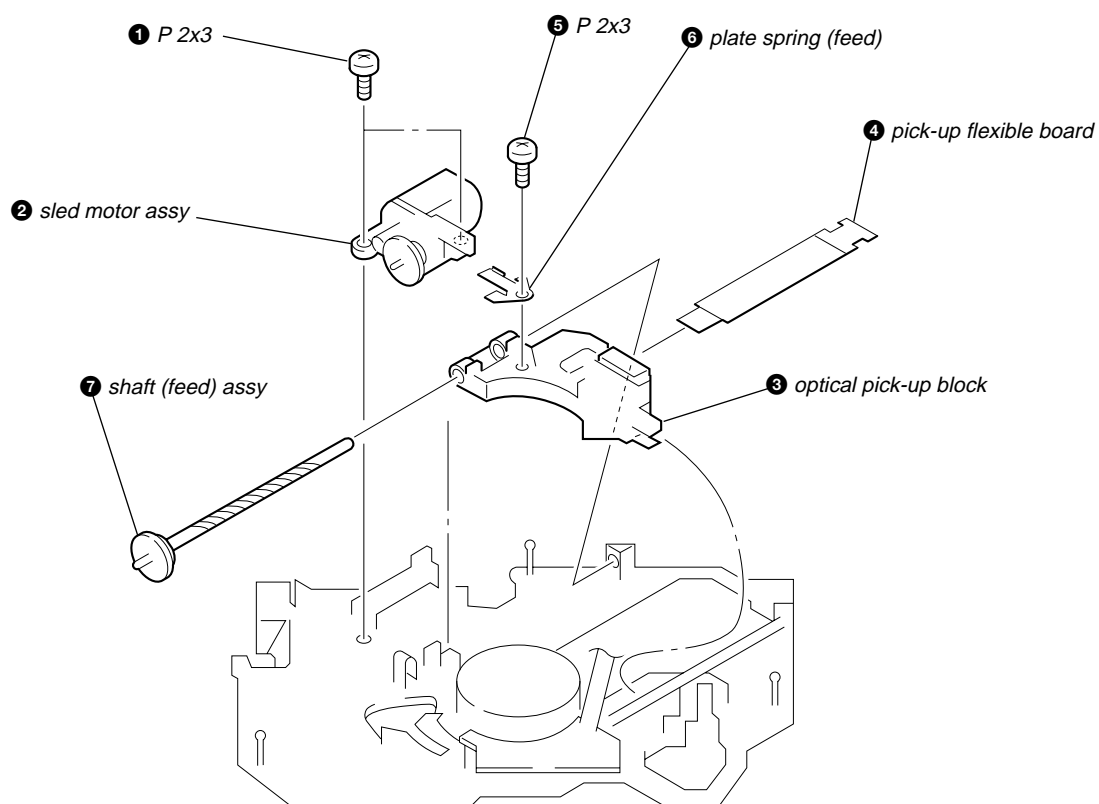

SECTION 3 DIAGRAMS

3-1. IC PIN DESCRIPTION

• IC501 MN101C49KTD2 (SYSTEM CONTROL)

Pin No.	Pin Name	I/O	Pin Description
1	VREF-	—	Rated voltage – for A/D converter.
2	VSM	I	S-meter voltage detection input
3	NC	—	Not used. (Connect to ground in this set)
4	KEYIN1	I	Key input 1
5	KEYIN0	I	Key input 0
6	RCIN0	I	Rotary commander input 0
7	QUALITY	I	Noise detection input
8	MPTH	I	Tuner multi-path detection input
9	NC	—	Not used. (Connect to ground in this set)
10	VREF+	—	Rated voltage + for A/D converter. (+5 V)
11	VDD	—	Power supply pin (+5 V)
12	OSCOUT	O	Oscillator output (18.432 MHz)
13	OSCIN	I	Oscillator input (18.432 MHz)
14	VSS	—	Ground
15	XIN	I	Oscillator input (32.768 kHz)
16	XOUT	O	Oscillator output (32.768 kHz)
17	MMOD	—	Mode selector (Connect to ground in this set)
18	LCDSO	O	LCD serial data output
19	LCDCE	O	LCD chip enable output
20	LCDCKO	O	LCD serial clock output
21	CD_TSO	O	CD text serial data output
22	CD_TSI	I	CD text serial data input
23	CD_TCKO	O	CD text serial clock output
24	NC	—	Not used. (Open)
25	NC	—	Not used. (Open)
26	KEY ACK	I	Key acknowledge detection input
27	DAVN	I	RDS data block synchro detection input
28	BUIN	I	Back-up power detection input
29	NC	I	Not used. (Connect to ground in this set)
30	CD_SELFSW	I	CD self switch input
31	CD_PACK	I	CD pack synchro signal input
32	NC (VCC)	—	Not used. (Connect to VDD in this set)
33	RESET	I	Reset input
34	NC	—	Not used. (Fixed at H in this set)
35	BEEP	O	Beep output
36	NC	—	Not used. (Open)
37	TESTIN	I	Test mode detection input
38	ACCIN	I	Accessory power detection input
39	NC (VCC)	—	Not used. (Open)
40	TELATT	I	Telephone attenuate detection input
41	NC (VCC)	—	Not used. (Connect to VDD in this set)
42	UNISO	O	SONY BUS data output
43	UNISI	I	SONY BUS data input
44	UNICKO	O	SONY BUS clock output
45	I2C_SIO	I/O	I ² C BUS serial data input/output
46	NC	—	Not used. (Open)
47	I2C_CKO	O	I ² C BUS serial clock output
48	NC	—	Not used. (Open)
49	TUNON	O	Tuner power control output
50	PW_ON	O	System power control output
51	TSTB	O	CD text strobe output

Pin No.	Pin Name	I/O	Pin Description
52	RFOK	I	CD RFOK signal input
53	CD_RST	O	CD reset signal output
54	A0	O	CD command/parameter signal output
55	STB	O	CD strobe signal output
56	X_EN	O	CD crystal oscillator control output
57	LIMIT	I	CD limit switch input
58	PH1	I	Not used. (Fixed at H in this set)
59	D_SW	I	CD down switch input
60	INSW	I	CD disc in switch input
61	NC (PH3)	—	Not used. (Fixed at H in this set)
62	CD_LM_LO	O	Loading motor control output (Loading direction)
63	CD_LM_EJ	O	Loading motor control output (Eject direction)
64	NC	—	Not used. (Open)
65	NC	—	Not used. (Open)
66	AMPATT	O	Power amplifier attenuator control output
67	AMPON	O	Power amplifier standby control output
68	CDMD_ON	O	CD mechanism power control output
69	ATT	O	System attenuate control output
70	VOLATT	O	Electronic volume attenuate control output
71	NC	—	Not used. (Open)
72	NC	—	Not used. (Open)
73	NC	—	Not used. (Open)
74	NC	—	Not used. (Open)
75	NC	—	Not used. (Open)
76	NC	—	Not used. (Connect to ground in this set)
77	NC	—	Not used. (Connect to ground in this set)
78	DIMSEL	—	Not used. (Open)
79	XCD_ON	O	CD power control output
80	TU-ATT	—	Not used. (Open)
81	NC	—	Not used. (Open)
82	NC	—	Not used. (Open)
83	NC	—	Not used. (Open)
84	NC	—	Not used. (Open)
85	NC	—	Not used. (Open)
86	E2P_SIO	I/O	EEPROM serial data input/output
87	E2P_CKO	O	EEPROM serial clock output
88	NC	—	Not used. (Open)
89	FLASH_W	I	Flash write input
90	NS_MASK	O	Noise detection output
91	AD_ON	O	Key power control output
92	NC	—	Not used. (Open)
93	ILLON	O	Illumination power control output
94	DOORSW	I	Not used. (Connect to ground in this set)
95	DAVSS	—	Ground for D/A converter.
96	NC	—	Not used. (Open)
97	NC	—	Not used. (Open)
98	RCIN1	I	Rotary commander input 1
99	RAMBU	—	Not used. (Connect to ground in this set)
100	DAVDD	—	D/A converter power supply pin (+5 V)

3-2. CIRCUIT BOARDS LOCATION

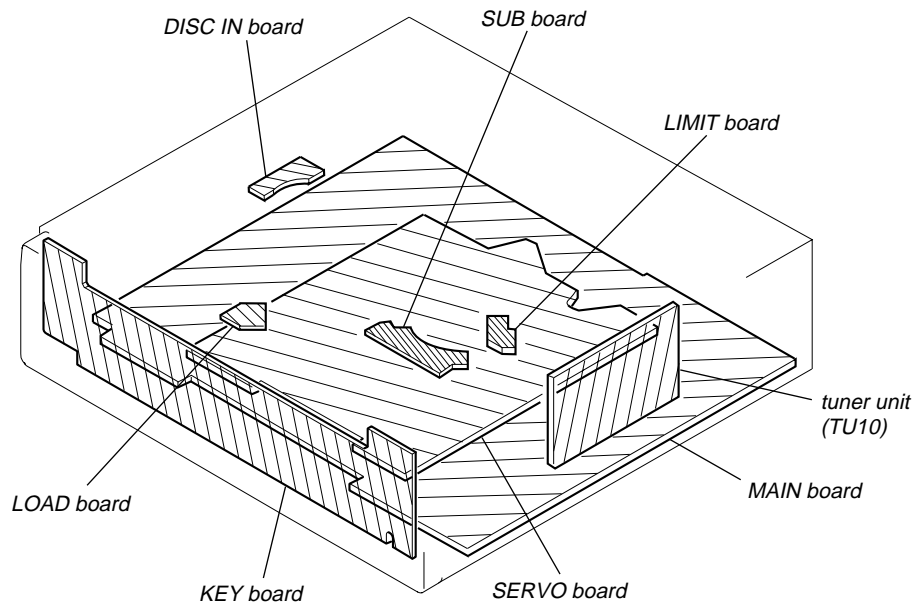

• Waveforms

— Servo Board —
(MODE: CD PLAY)

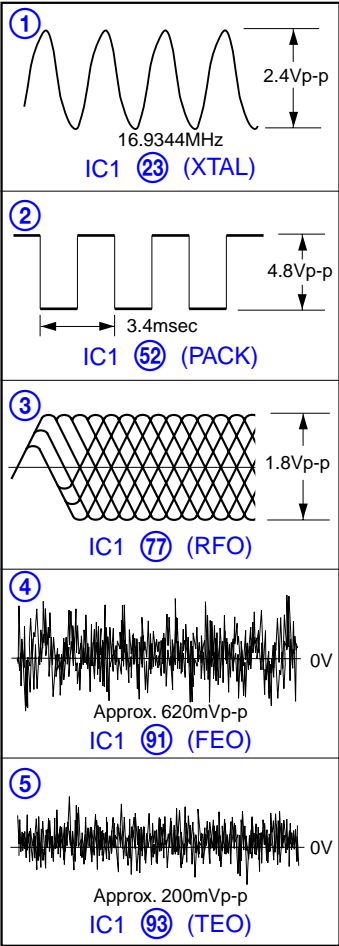

— Main Board —

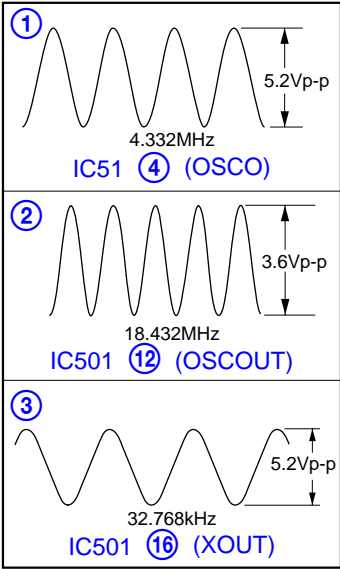

3-3. BLOCK DIAGRAM — CD SECTION —

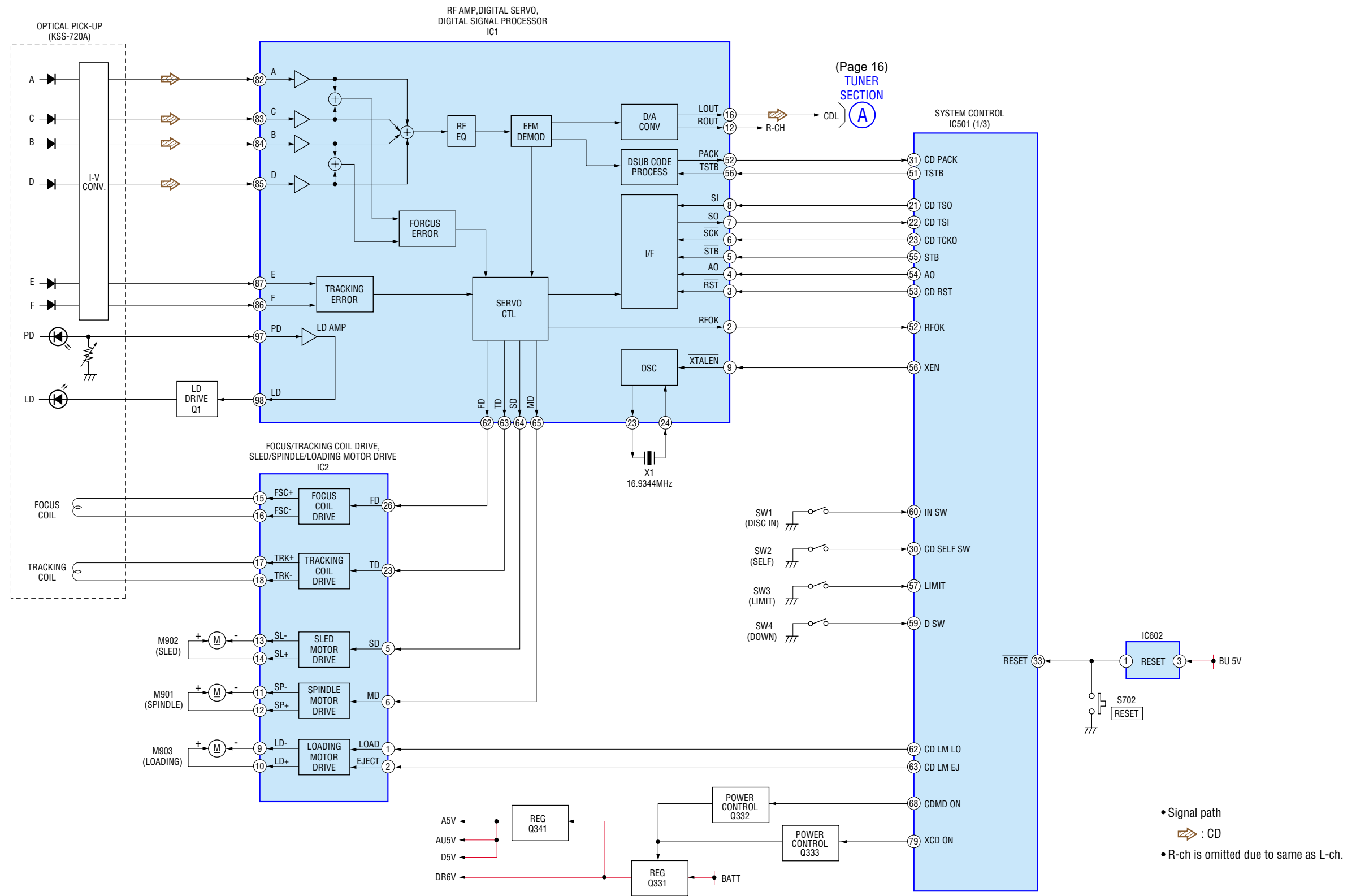

3-4. BLOCK DIAGRAM — TUNER SECTION —

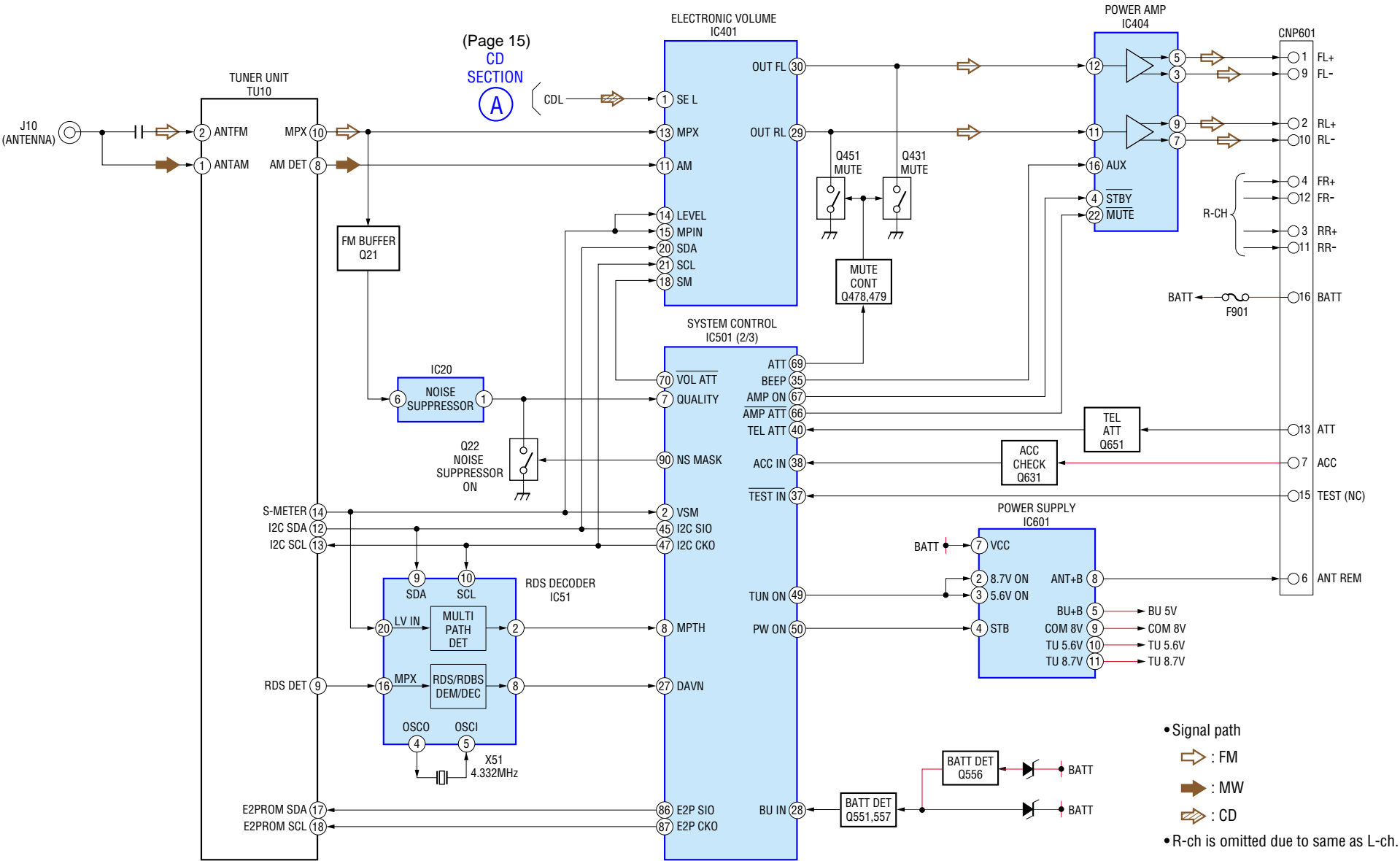

3-5. BLOCK DIAGRAM — DISPLAY SECTION —

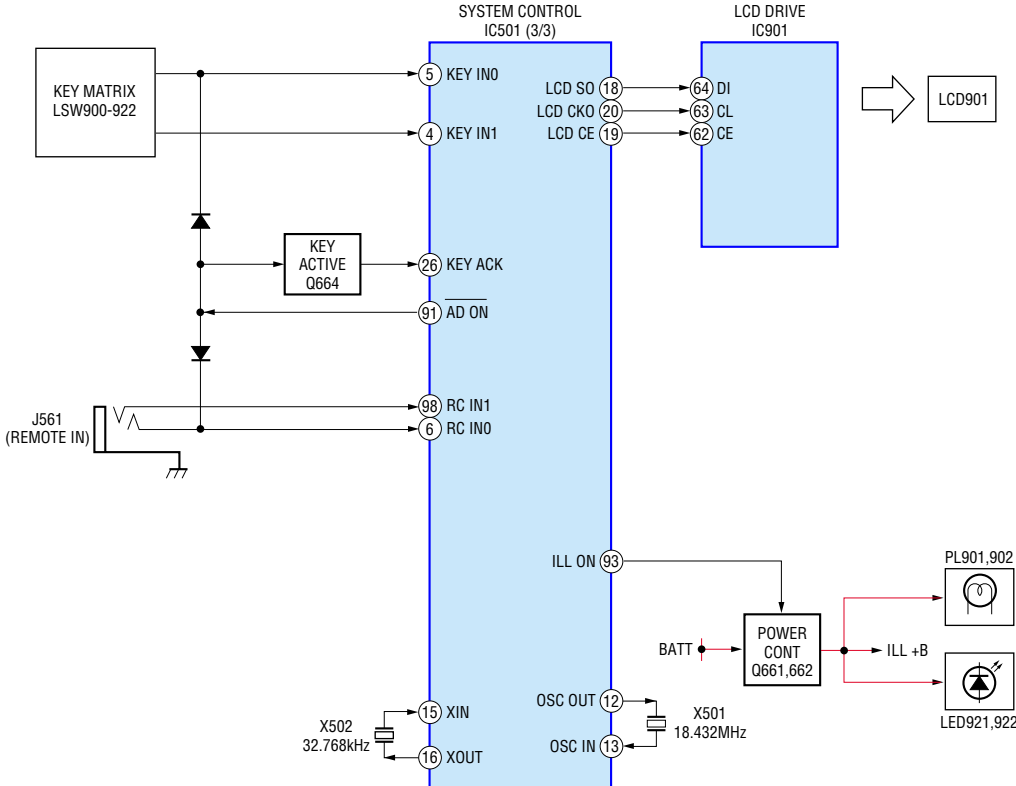

3-6. PRINTED WIRING BOARDS — CD MECHANISM SECTION — • Refer to page 14 for Circuit Boards Location.

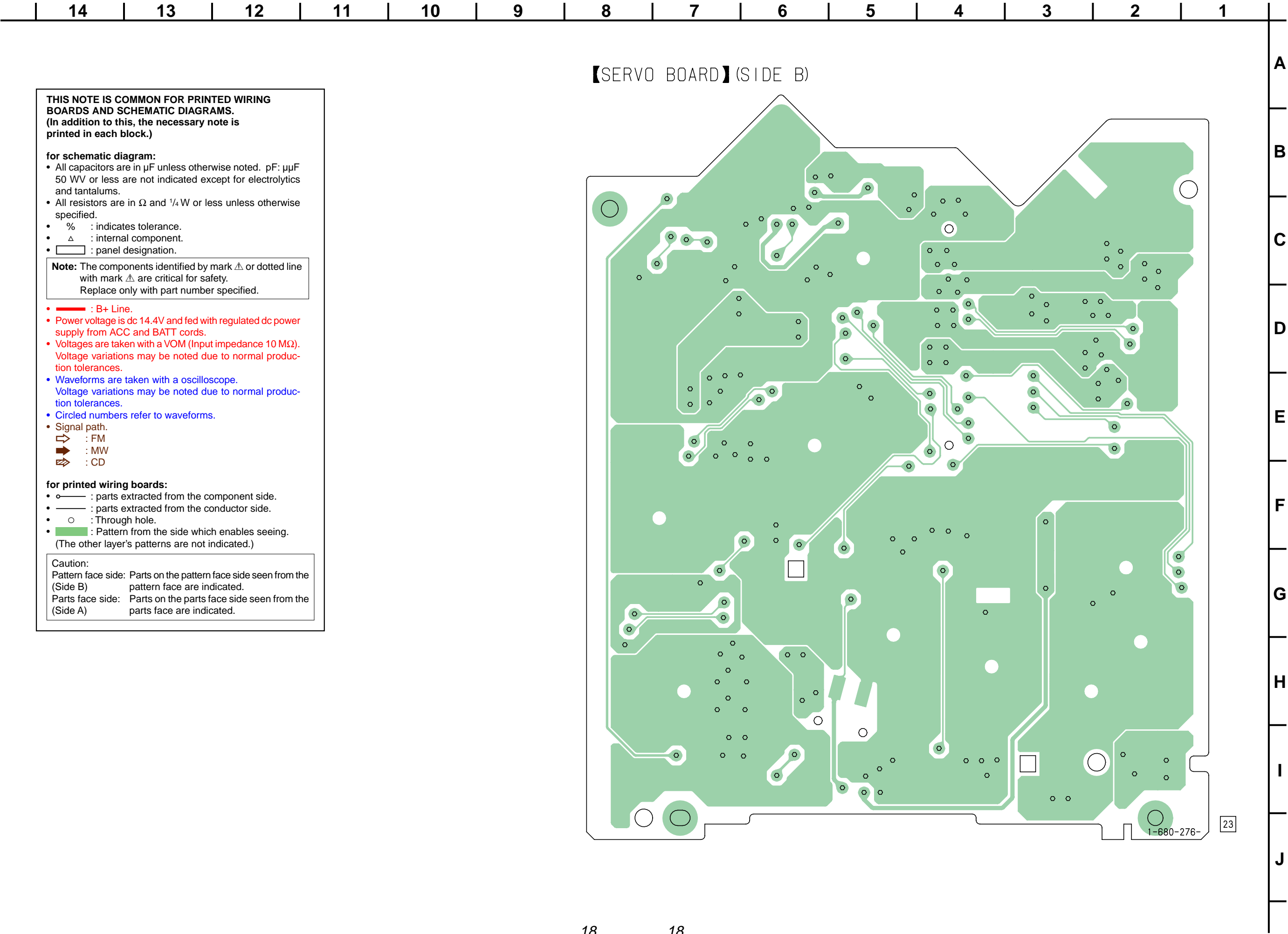

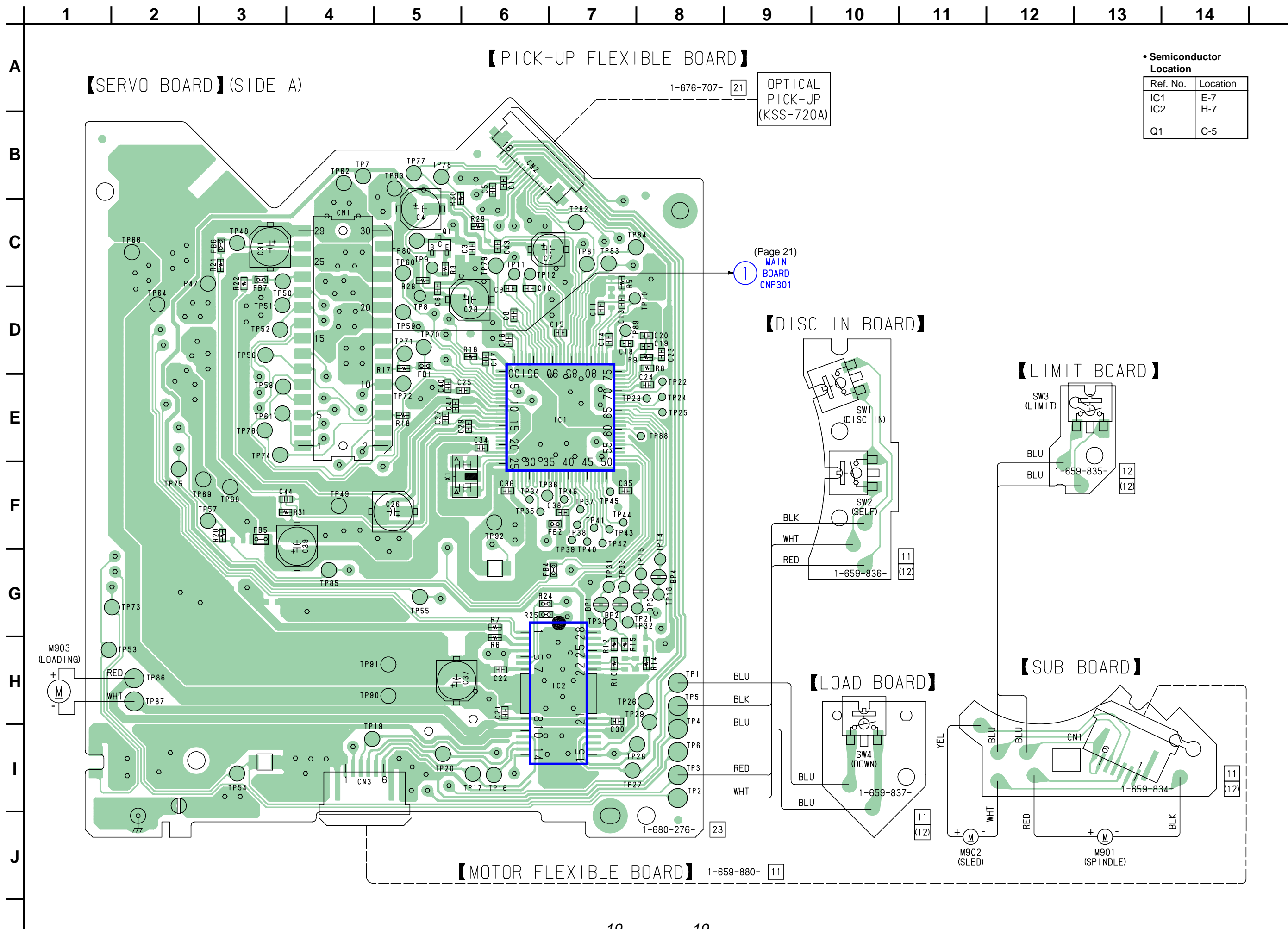

• Semiconductor Location

Ref. No.	Location
IC1	E-7
IC2	H-7
Q1	C-5

(Page 21)
MAIN BOARD
CNP301

• Refer to page 14 for Waveforms and page 18 for Common Note on Schematic Diagram.

3-7. SCHEMATIC DIAGRAM — CD MECHANISM SECTION — • Refer to page 26 for IC Block Diagrams.

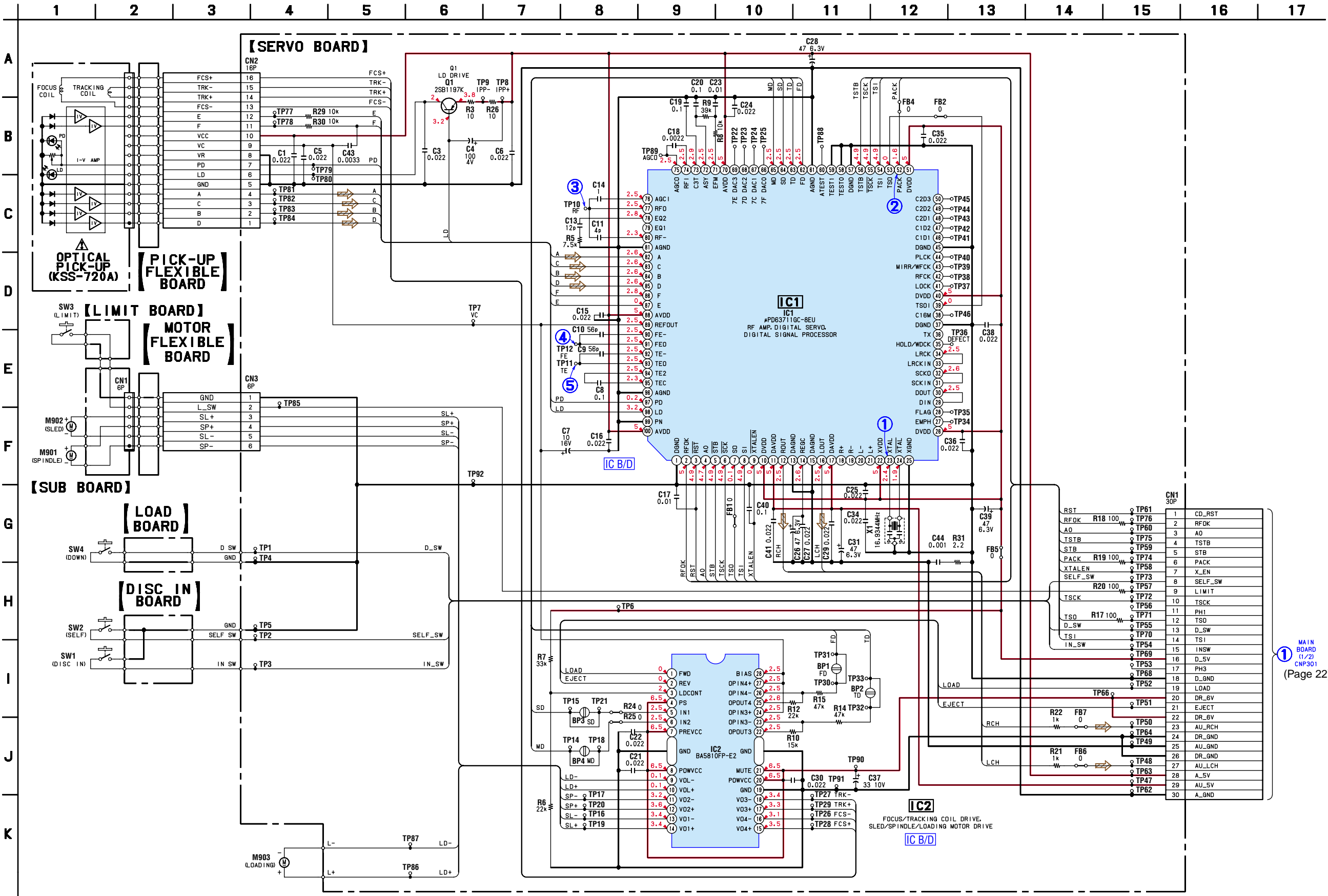

① MAIN BOARD (1/2) CNP301 (Page 22)

Note:
• Voltage is dc with respect to ground under no-signal conditions.
no mark : CD PLAY



• Refer to page 14 for Waveforms and page 18 for Common Note on Schematic Diagram.

3-9. SCHEMATIC DIAGRAM — MAIN SECTION (1/2) — • Refer to page 26 for IC Block Diagrams.

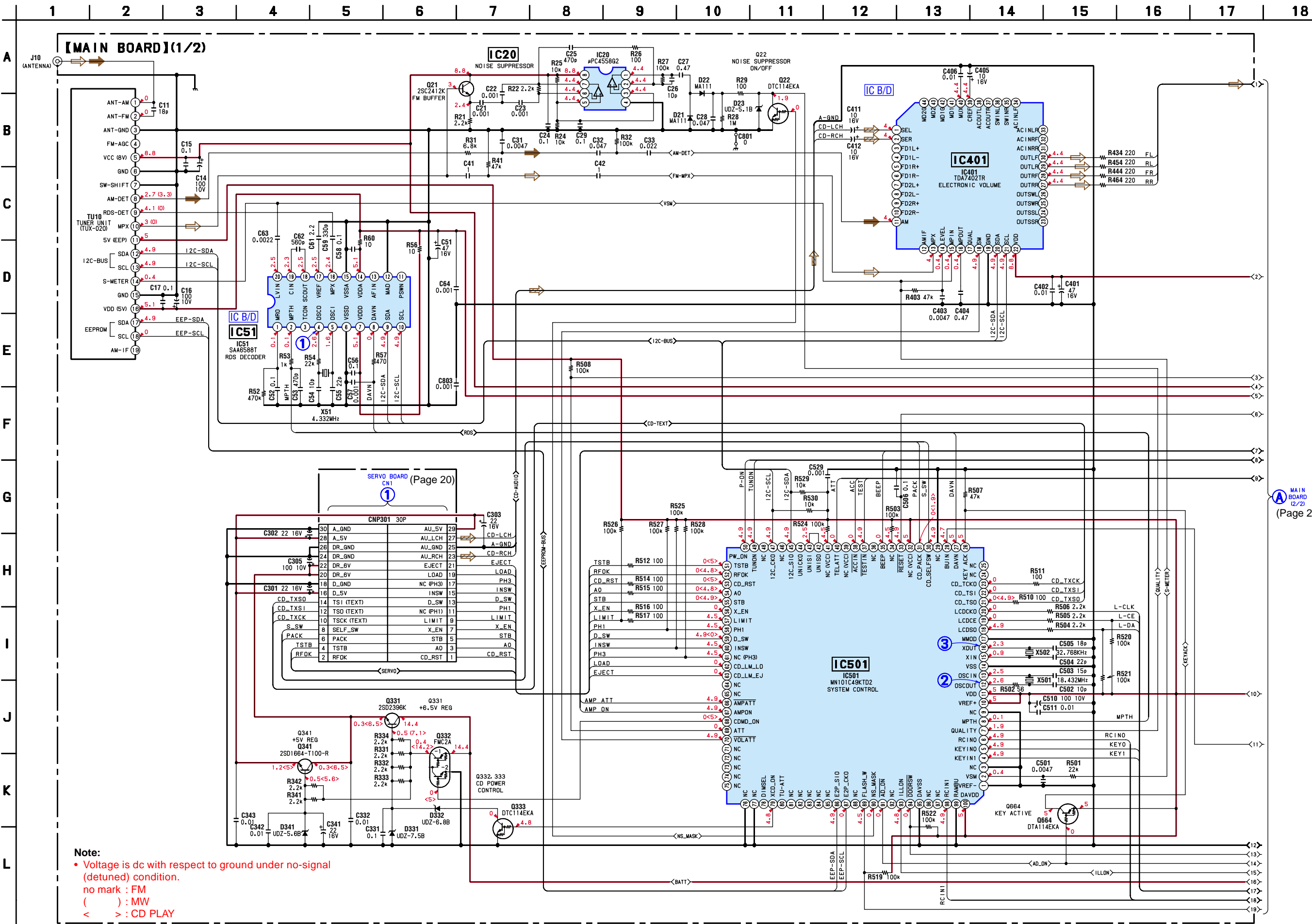

3-10. SCHEMATIC DIAGRAM — MAIN SECTION (2/2) — • Refer to page 18 for Common Note on Schematic Diagram and page 26 for IC Block Diagrams.

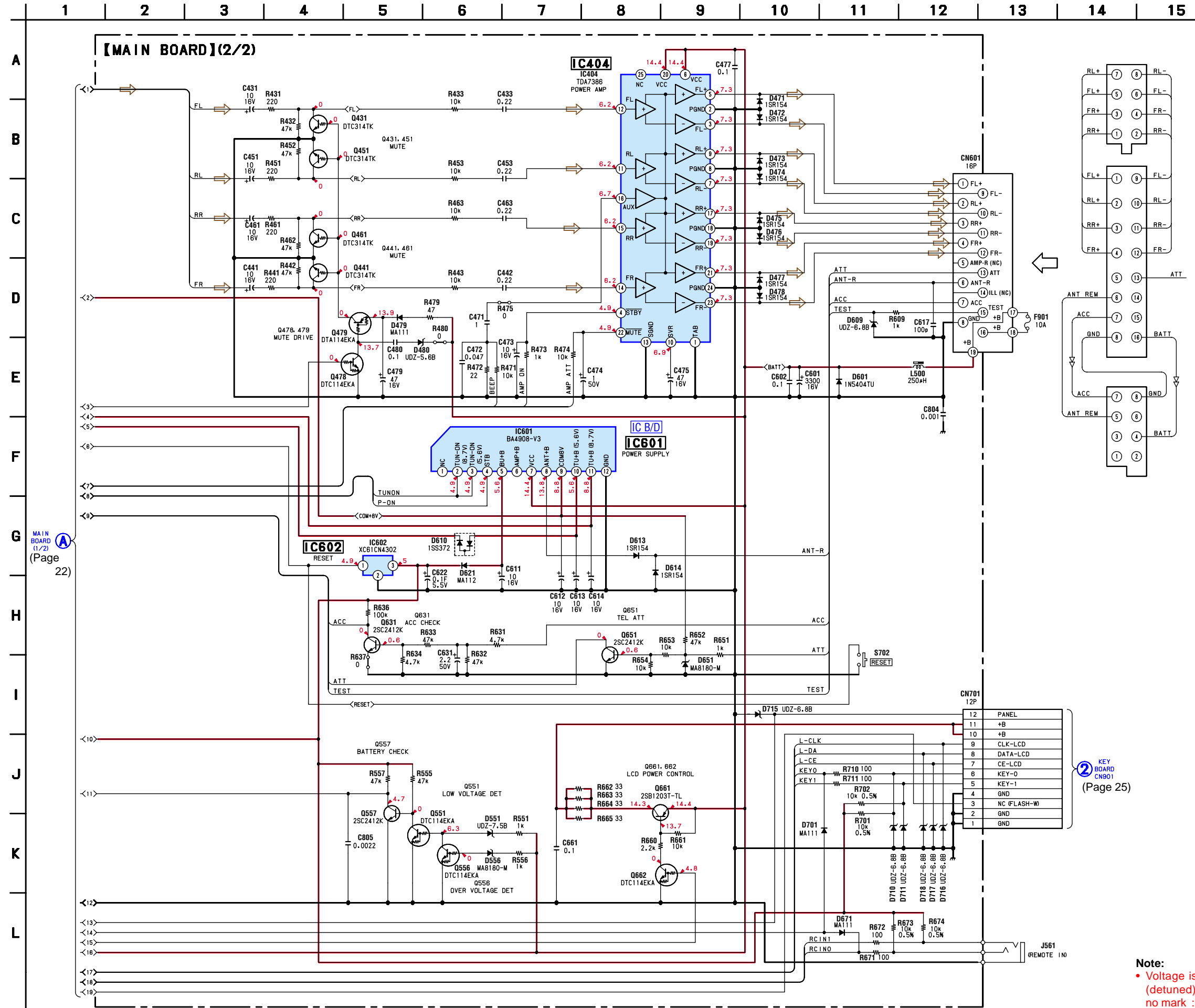

Note:

- Voltage is dc with respect to ground under no-signal (detuned) condition.

no mark : FM

3-11. PRINTED WIRING BOARD — KEY SECTION — • Refer to page 14 for Circuit Boards Location and page 18 for Common Note on Printed Wiring Boards.

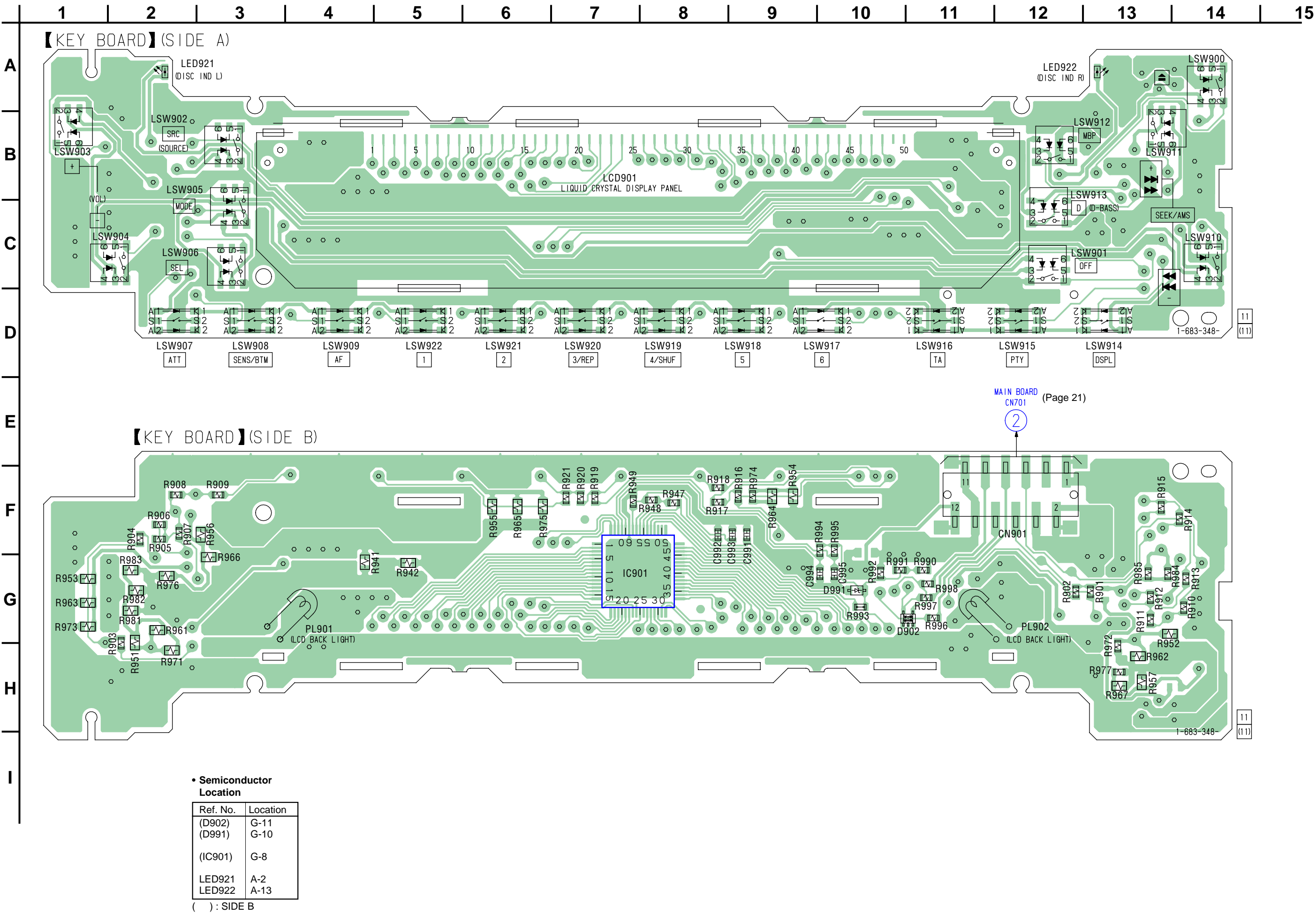

3-12. SCHEMATIC DIAGRAM — KEY SECTION — • Refer to page 18 for Common Note on Schematic Diagram.

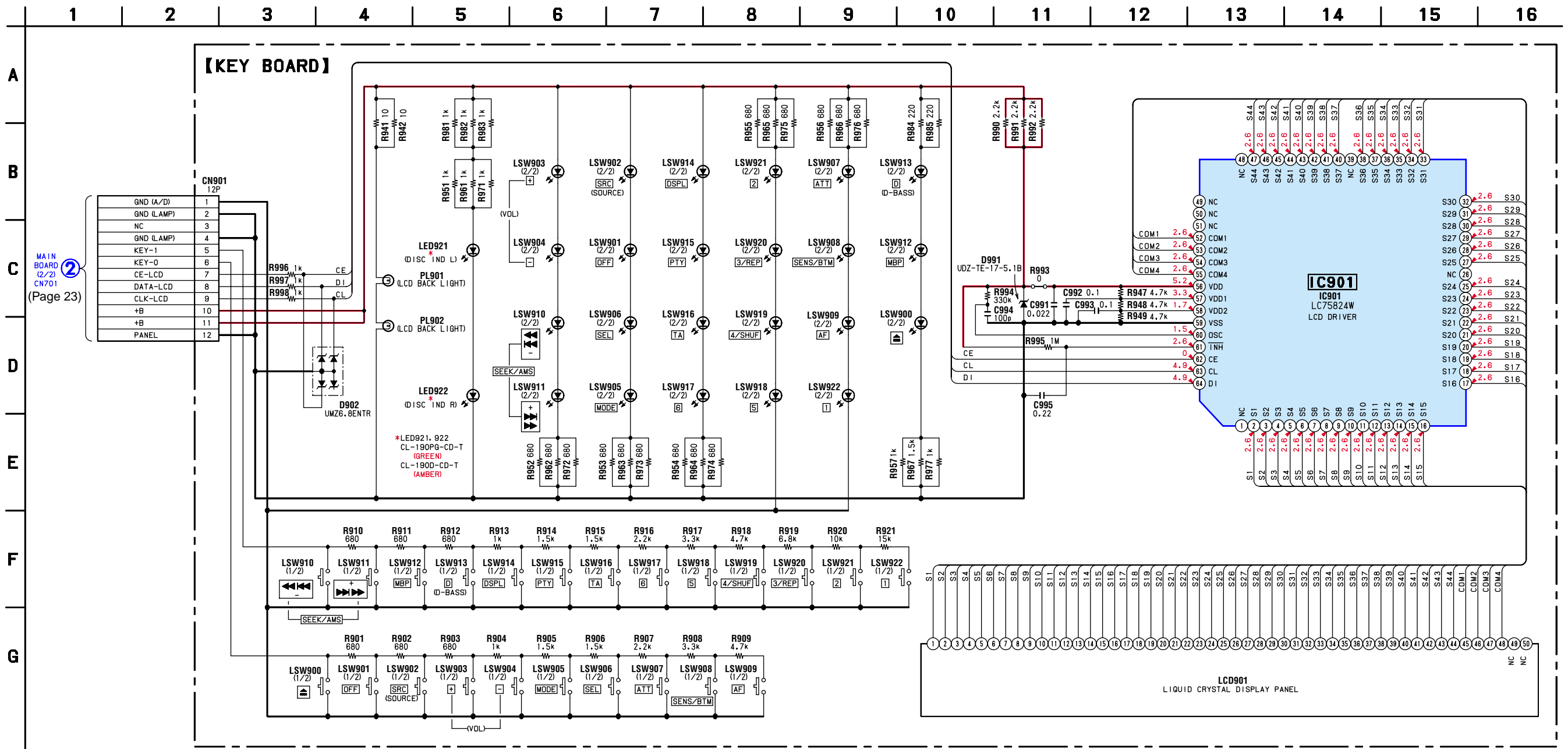

Note:

- Voltage is dc with respect to ground under no-signal (detuned) condition.
no mark : FM

CDX-L410

• IC Block Diagrams

IC1 μ PD63711GC-8EU

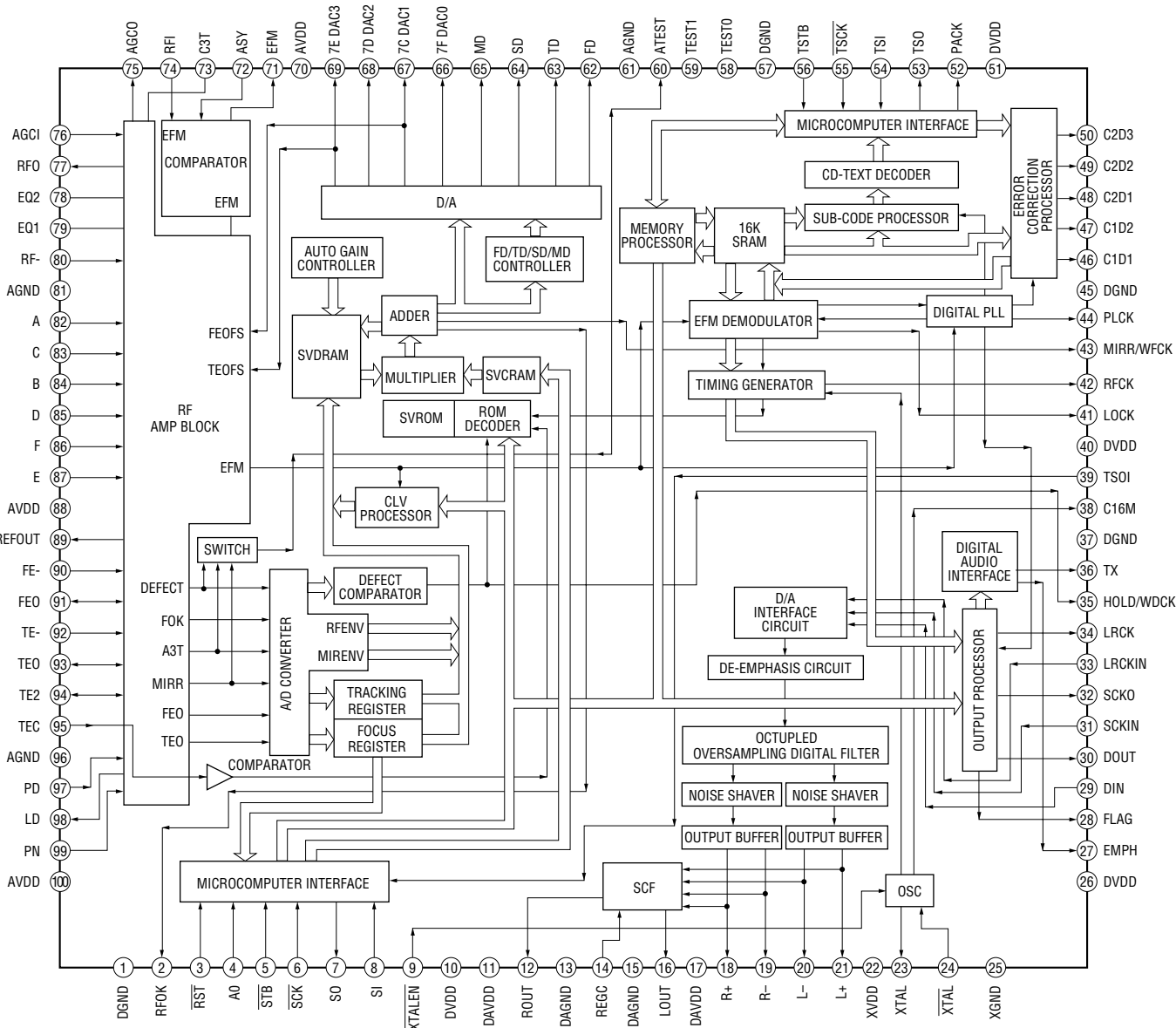

IC51 SAA6588T

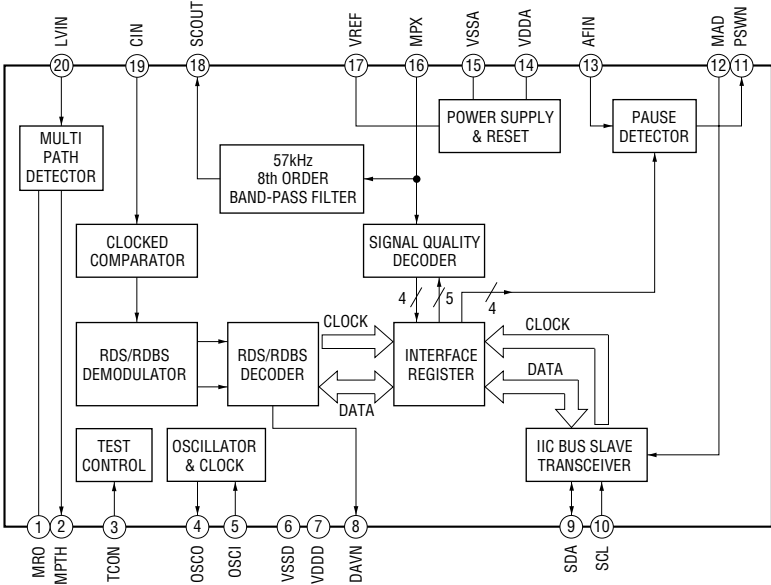

IC2 BA5810FP-E2

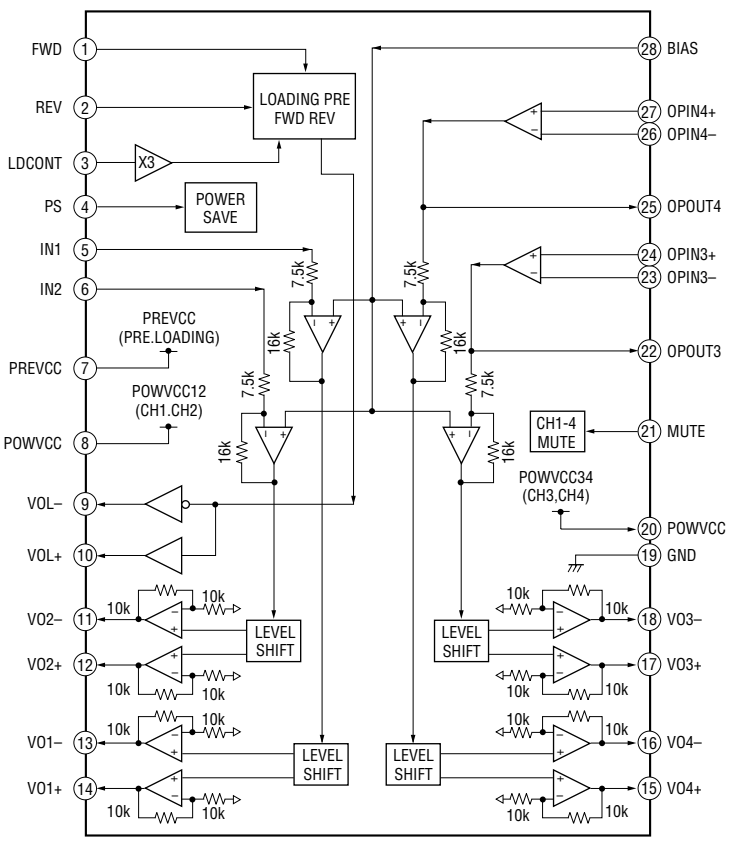

IC601 BA4908-V3

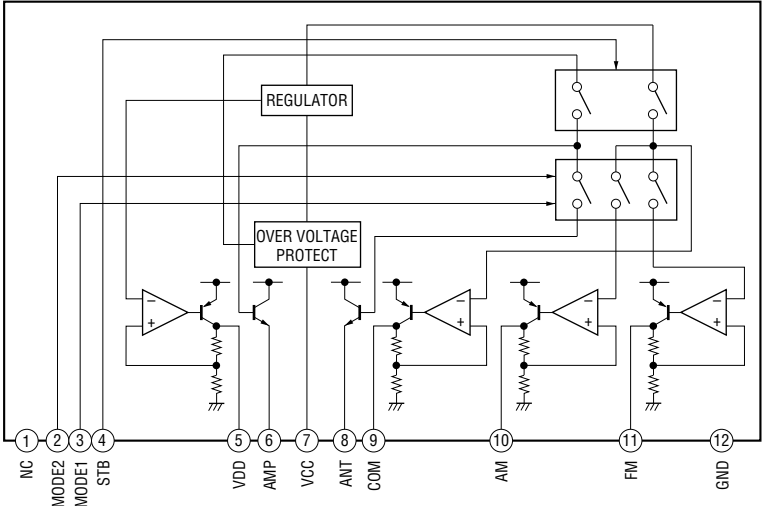

IC401 TDA7402TR

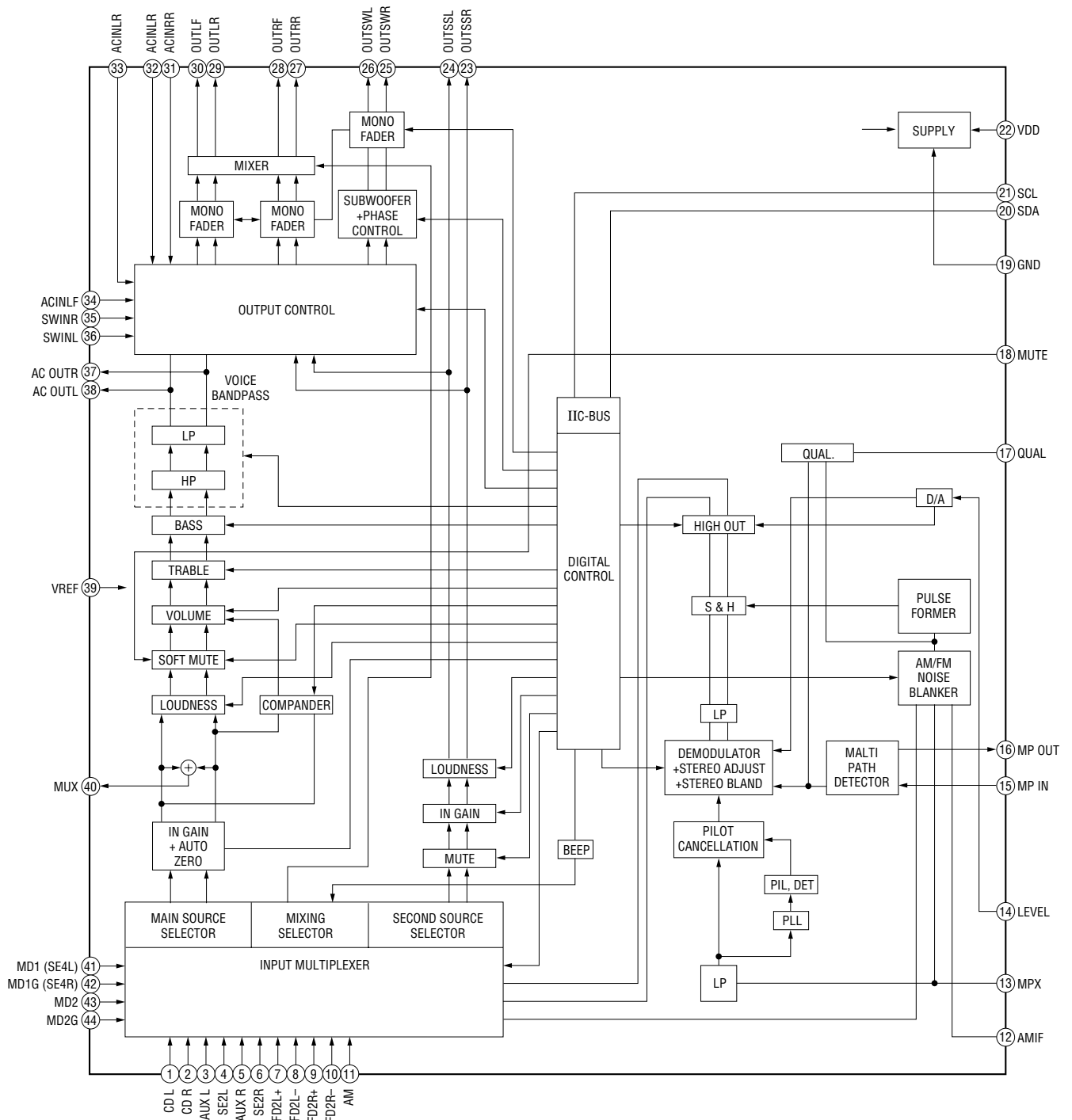

SECTION 4

EXPLODED VIEWS



NOTE:

- The mechanical parts with no reference number in the exploded views are not supplied.
- Items marked “*” are not stocked since they are seldom required for routine service. Some delay should be anticipated when ordering these items.
- -XX and -X mean standardized parts, so they may have some difference from the original one.

- Color Indication of Appearance Parts
Example :
KNOB, BALANCE (WHITE) ... (RED)

↑
Parts Color

↑
Cabinet's Color
- Accessories are given in the last of this parts list.

The components identified by mark  or dotted line with mark.  are critical for safety.
Replace only with part number specified.

4-1. CHASSIS SECTION

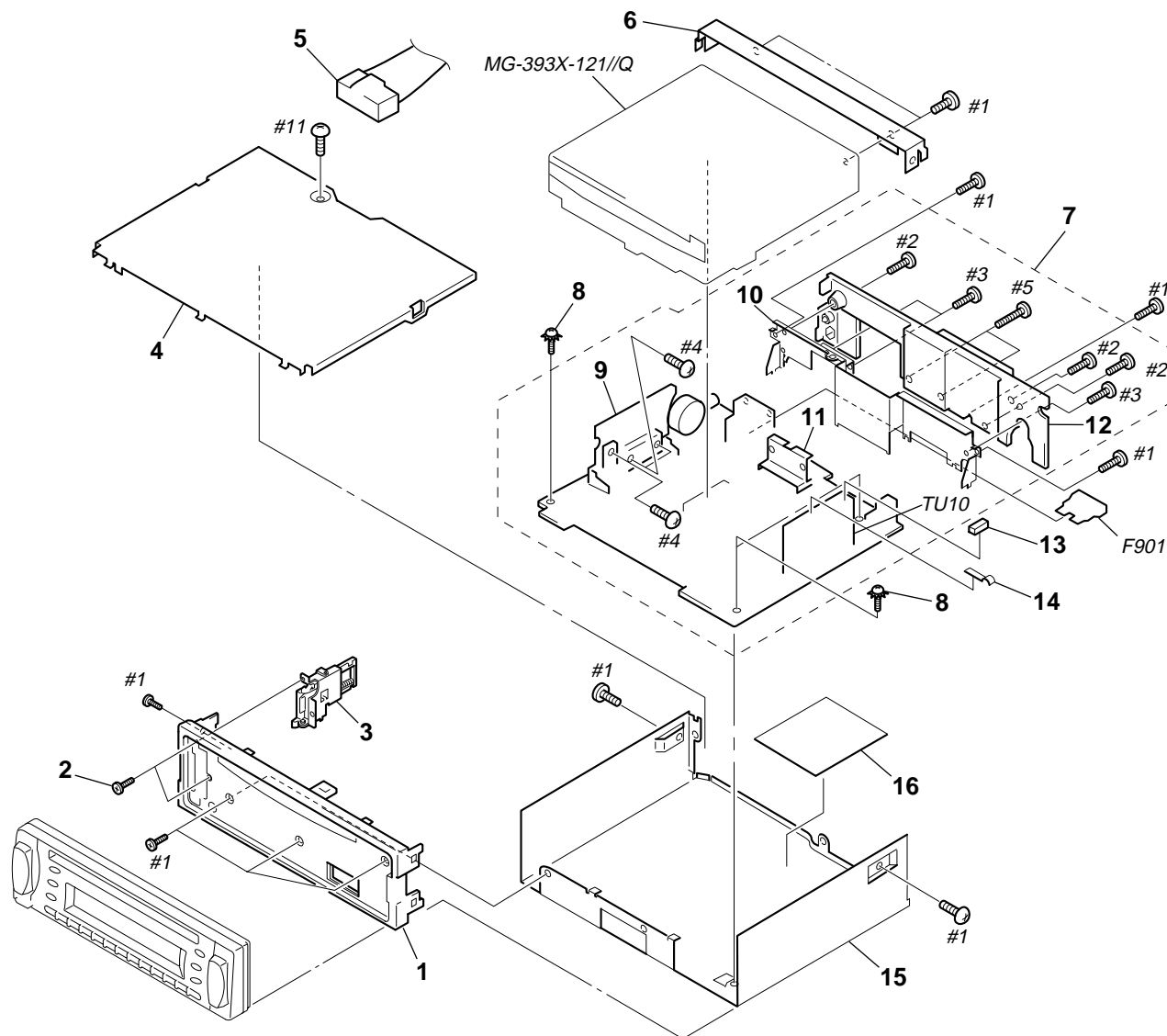

Ref. No.	Part No.	Description	Remark	Ref. No.	Part No.	Description	Remark
1	X-3380-162-4	PANEL SUB ASSY, SUB		* 13	3-045-877-02	CUSHION (TU)	
2	3-042-244-11	SCREW (T)		* 14	3-045-878-01	PLATE (TU), GROUND	
3	X-3379-876-3	LOCK ASSY (S)		15	3-225-133-11	CHASSIS	
4	3-223-782-21	COVER		16	3-231-821-01	PLATE, INSULATED	
5	1-776-527-82	CORD (WITH CONNECTOR) (ISO) (POWER)		F901	1-532-877-11	FUSE (BLADE TYPE) (AUTO FUSE) 10A	
6	3-041-012-11	BRACKET (CD)		TU10	A-3220-812-A	TUNER UNIT (TUX-020)	
7	A-3340-225-A	MAIN BOARD, COMPLETE		#1	7-685-792-09	SCREW +PTT 2.6X6 (S)	
8	3-376-464-11	SCREW (+PTT 2.6X6), GROUND POINT		#2	7-685-795-09	SCREW +PTT 2.6X12 (S)	
* 9	3-225-136-01	HEAT SINK (REG)		#3	7-685-793-09	SCREW +PTT 2.6X8 (S)	
* 10	3-225-271-02	CHASSIS (BACK)		#4	7-685-647-79	SCREW +BVPT 3X10 TYPE2 N-S	
* 11	3-040-998-01	BRACKET (IC)		#5	7-685-797-09	SCREW +PTT 2.6X16 (S)	
* 12	3-225-135-01	HEAT SINK		#11	7-685-791-09	SCREW +PTT 2.6X5 (S)	

4-2. FRONT PANEL SECTION

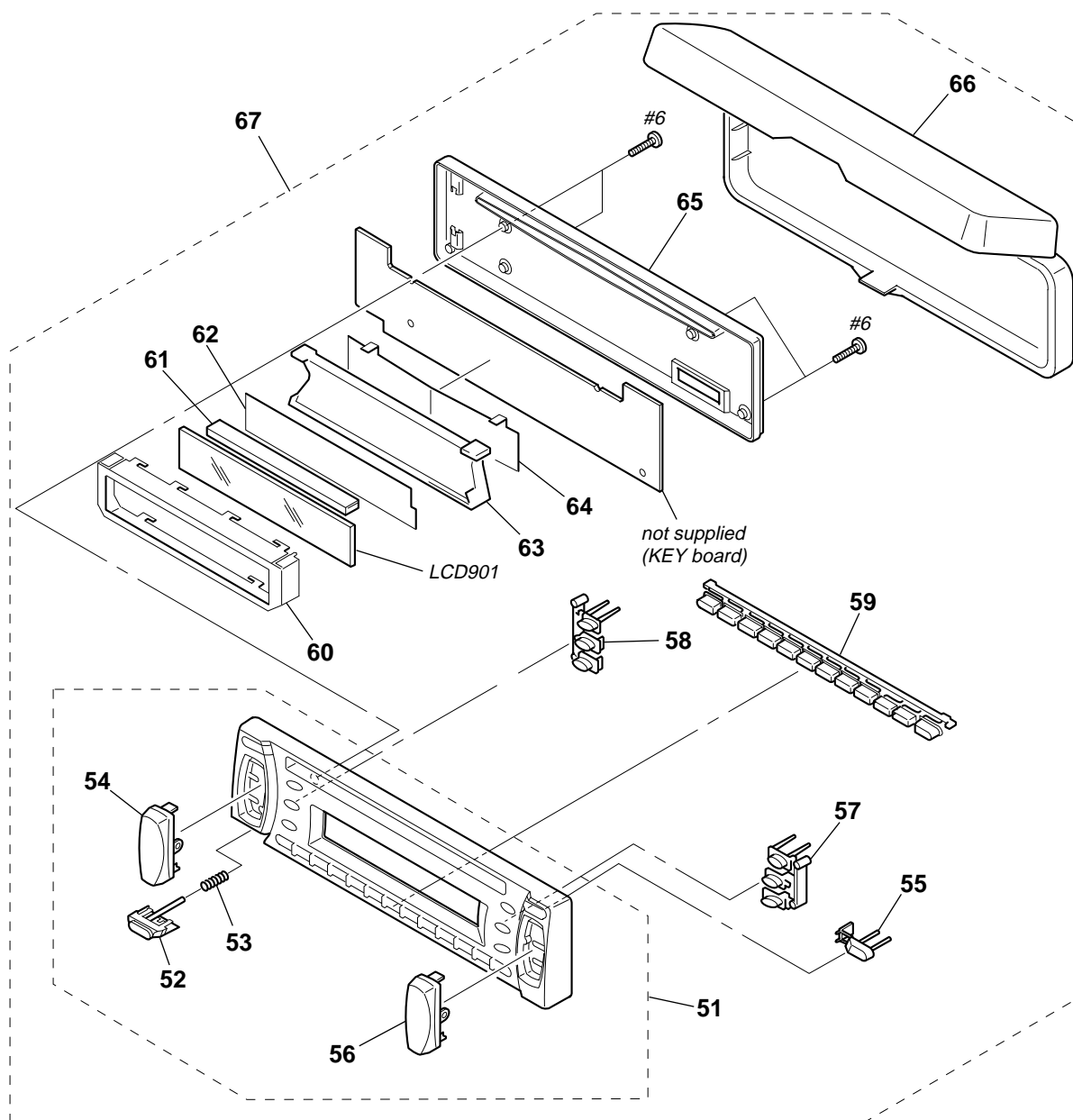

Ref. No.	Part No.	Description	Remark	Ref. No.	Part No.	Description	Remark
51	X-3381-288-1	PANEL SUB ASSY, FRONT		61	1-694-781-11	CONDUCTIVE BOARD, CONNECTION	
52	3-224-869-11	BUTTON (RELEASE/U)		62	3-235-387-11	ILLUMINATOR (LCD)	
53	3-231-816-01	SPRING (RELEASE)		63	3-235-381-01	PLATE (LCD), LIGHT GUIDE	
54	3-235-389-01	BUTTON (W) (+/-)		64	3-235-388-01	REFLECTOR (LCD)	
55	3-235-383-11	BUTTON (EJECT)		65	3-235-380-01	PANEL (CD), FRONT BACK	
56	3-235-390-01	BUTTON (W) (S/A)		66	X-3378-490-2	CASE (PANEL) ASSY (for FRONT PANEL)	
57	3-235-385-01	BUTTON (R)		* 67	A-3307-999-A	PANEL COMPLETE ASSY, FRONT (AMBER)	
58	3-235-384-01	BUTTON (L)		* 67	A-3337-001-A	PANEL COMPLETE ASSY, FRONT (GREEN)	
59	3-225-123-01	BUTTON (PRESET/CE)		LCD901	1-804-625-11	DISPLAY PANEL, LIQUID CRYSTAL	
60	3-235-382-01	PLATE (LCD), GROUND		#6	7-685-106-19	SCREW +P 2X10 TYPE2 NON-SLIT	

4-3. CD MECHANISM SECTION (1)
(MG-393X-121//Q)

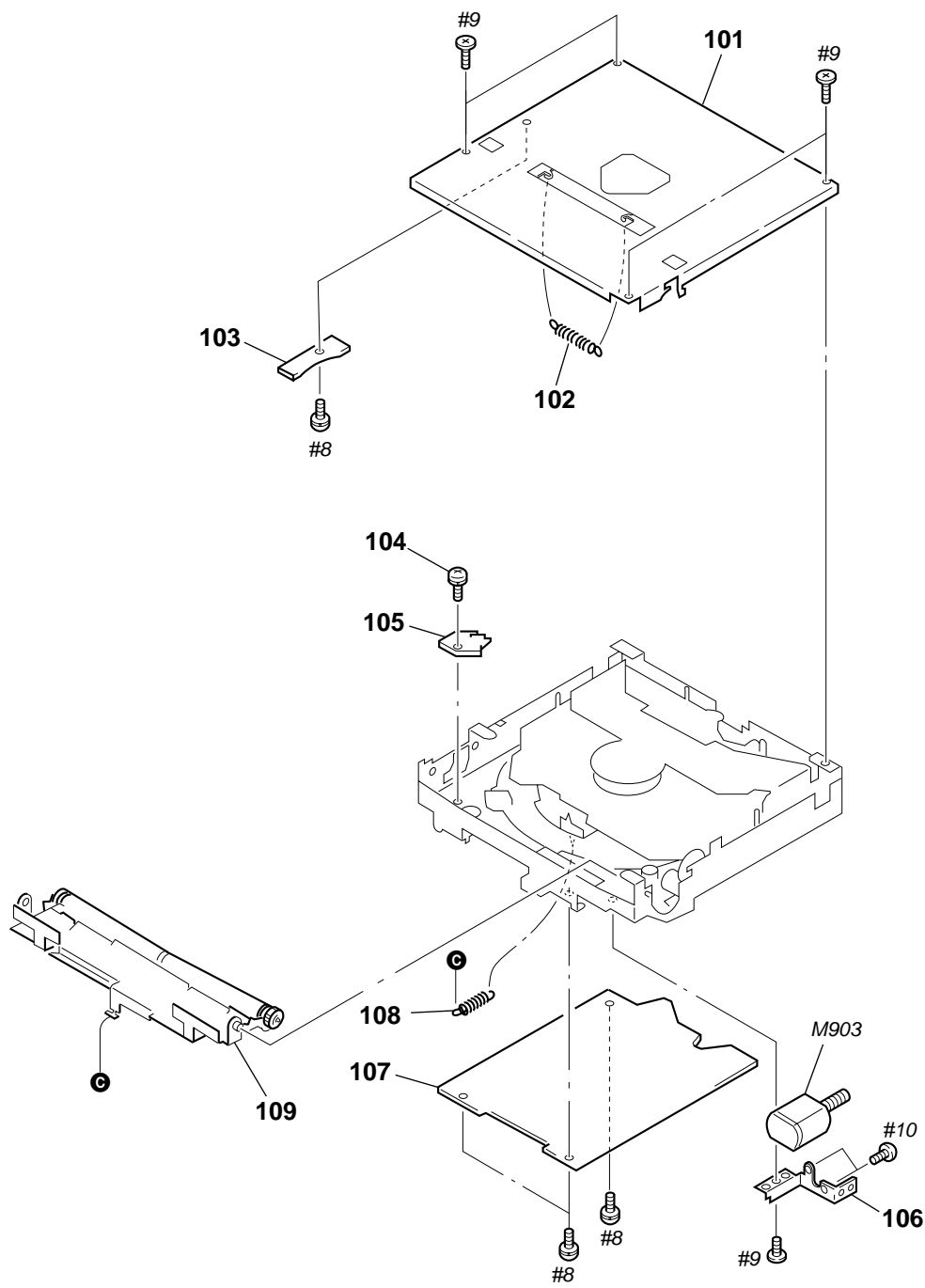

Ref. No.	Part No.	Description	Remark	Ref. No.	Part No.	Description	Remark
101	A-3315-247-B	CHASSIS (T.U) ASSY		108	3-225-784-01	SPRING (RA3), TENSION	
102	3-931-909-01	SPRING (LR), TENSION		109	A-3315-040-A	ROLLER ASSY, ARM	
* 103	1-659-836-11	DISC IN BOARD		M903	A-3315-039-A	MOTOR SUB ASSY, LD (LOADING)	
104	3-338-737-01	SCREW (2X3), +PS		#8	7-628-253-00	SCREW +PS 2X4	
* 105	1-659-837-11	LOAD BOARD		#9	7-627-553-37	SCREW, PRECISION +P 2X3 TYPE3	
* 106	3-039-629-02	BRACKET (MOTOR)		#10	7-627-553-17	SCREW, PRECISION +P 2X2 TYPE3	
* 107	A-3283-047-A	SERVO BOARD, COMPLETE					

4-4. CD MECHANISM SECTION (2) (MG-393X-121//Q)

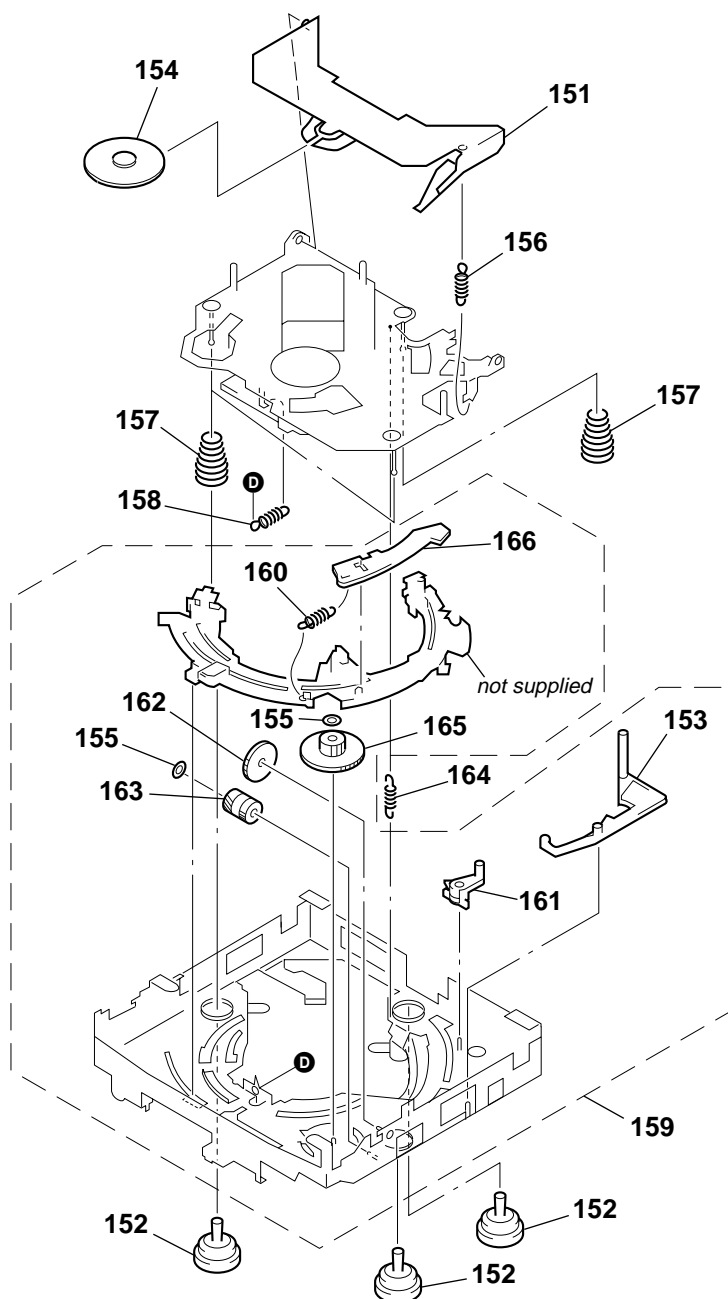

Ref. No.	Part No.	Description	Remark	Ref. No.	Part No.	Description	Remark
151	X-3378-956-8	ARM ASSY, CHUCKING		159	A-3315-243-C	CHASSIS (M) ASSY	
152	3-931-897-61	DAMPER (T)		160	3-220-180-01	SPRING (TR2), TENSION	
153	3-039-627-01	LEVER (D)		161	3-931-881-03	LEVER (LOCK)	
154	3-040-165-02	RETAINER (DISC)		162	3-931-882-02	GEAR (MDL)	
155	3-018-272-01	WASHER		163	3-007-537-11	WHEEL (U), WORM	
156	3-931-895-01	SPRING (CH), TENSION		164	3-032-484-01	SPRING (KR1), TENSION	
157	3-931-898-01	SPRING (FL), COMPRESSION		165	3-014-727-01	WHEEL (LW), WORM	
158	3-032-483-02	SPRING (KF1), TENSION		166	3-039-626-01	LEVER (TR)	

4-5. CD MECHANISM SECTION (3)
(MG-393X-121//Q)

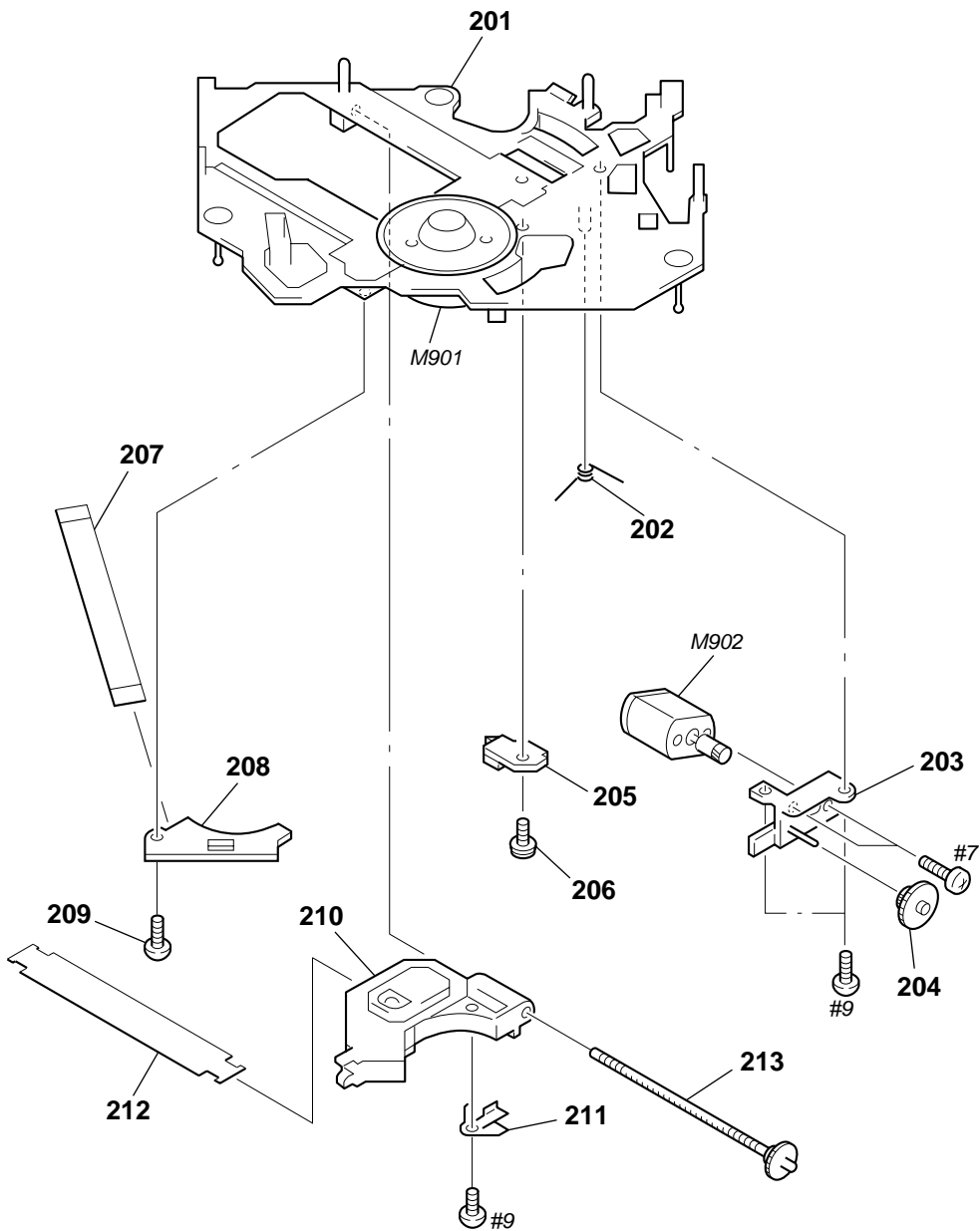

Ref. No.	Part No.	Description	Remark	Ref. No.	Part No.	Description	Remark
201	X-3378-598-2	CHASSIS (OP) ASSY (including M901)		209	3-909-607-01	SCREW	
202	3-043-494-01	SPRING (SL), TORSION		Δ 210	8-820-103-11	PICK-UP, OPTICAL KSS-720A/C-RP	
203	3-040-170-01	BASE (DRIVING)		211	3-025-743-01	SPRING (FEED), LEAF	
204	3-040-419-01	GEAR (MIDWAY)		212	1-676-707-21	PICK-UP FLEXIBLE BOARD	
* 205	1-659-835-12	LIMIT BOARD		213	A-3291-669-A	SHAFT (FEED) ASSY	
206	3-338-737-01	SCREW (2X3), +PS		M902	A-3291-674-A	MOTOR ASSY, SLED (SLED)	
207	1-659-880-11	MOTOR FLEXIBLE BOARD		#7	7-627-850-28	SCREW, PRECISION +P 1.4X3	
* 208	1-659-834-11	SUB BOARD		#9	7-627-553-37	SCREW, PRECISION +P 2X3 TYPE3	

SECTION 5 ELECTRICAL PARTS LIST

DISC IN

KEY

NOTE:

- Due to standardization, replacements in the parts list may be different from the parts specified in the diagrams or the components used on the set.
- -XX and -X mean standardized parts, so they may have some difference from the original one.
- RESISTORS
All resistors are in ohms.
METAL: Metal-film resistor.
METAL OXIDE: Metal oxide-film resistor.
F: nonflammable

- Items marked “*” are not stocked since they are seldom required for routine service. Some delay should be anticipated when ordering these items.
- SEMICONDUCTORS
In each case, u : μ , for example:
uA.. : μ A.. uPA.. : μ PA..
uPB.. : μ PB.. uPC.. : μ PC.. uPD.. : μ PD..
- CAPACITORS
uF : μ F
- COILS
uH : μ H

The components identified by mark Δ or dotted line with mark. Δ are critical for safety. Replace only with part number specified.

When indicating parts by reference number, please include the board.

Ref. No.	Part No.	Description	Remark
*	1-659-836-11	DISC IN BOARD *****	
		< SWITCH >	
SW1	1-529-566-31	SWITCH, PUSH (1 KEY) (DISC IN)	
SW2	1-529-566-31	SWITCH, PUSH (1 KEY) (SELF)	

		KEY BOARD *****	
	1-694-781-11	CONDUCTIVE BOARD, CONNECTION	
	3-235-381-01	PLATE (LCD), LIGHT GUIDE	
	3-235-382-01	PLATE (LCD), GROUND	
	3-235-387-11	ILLUMINATOR (LCD)	
	3-235-388-01	REFLECTOR (LCD)	
		< CAPACITOR >	
C991	1-164-227-11	CERAMIC CHIP 0.022uF 10% 25V	
C992	1-107-826-11	CERAMIC CHIP 0.1uF 10% 16V	
C993	1-107-826-11	CERAMIC CHIP 0.1uF 10% 16V	
C994	1-162-927-11	CERAMIC CHIP 100PF 5% 50V	
C995	1-127-715-11	CERAMIC CHIP 0.22uF 10% 16V	
		< CONNECTOR >	
CN901	1-794-312-11	PIN, CONNECTOR 12P	
		< DIODE >	
D902	8-719-085-72	DIODE UMZ6.8ENTR	
D991	8-719-976-99	DIODE DTZ5.1B	
		< IC >	
IC901	8-759-365-90	IC LC75824W	
		< LIQUID CRYSTAL DISPLAY >	
LCD901	1-804-625-11	DISPLAY PANEL, LIQUID CRYSTAL	
		< DIODE >	
LED921	8-719-038-07	LED CL-190PG-CD-T (DISC IND L) (GREEN)	
LED921	8-719-047-66	LED CL-190D-CD-T (DISC IND L) (AMBER)	
LED922	8-719-038-07	LED CL-190PG-CD-T (DISC IND R) (GREEN)	
LED922	8-719-047-66	LED CL-190D-CD-T (DISC IND R) (AMBER)	
		< SWITCH >	
LSW900	1-762-617-21	SWITCH, KEYBOARD (WITH LED) (Δ) (AMBER)	

Ref. No.	Part No.	Description	Remark
LSW900	1-786-124-11	SWITCH, KEYBOARD (WITH LED) (Δ) (GREEN)	
LSW901	1-762-619-21	SWITCH, KEYBOARD (WITH LED) (OFF) (GREEN)	
LSW901	1-771-500-21	SWITCH, KEYBOARD (WITH LED) (OFF) (AMBER)	
LSW902	1-762-619-21	SWITCH, KEYBOARD (WITH LED) (SRC (SOURCE)) (GREEN)	
LSW902	1-771-500-21	SWITCH, KEYBOARD (WITH LED) (SRC (SOURCE)) (AMBER)	
LSW903	1-762-617-21	SWITCH, KEYBOARD (WITH LED) (+ (VOL)) (AMBER)	
LSW903	1-786-124-11	SWITCH, KEYBOARD (WITH LED) (+ (VOL)) (GREEN)	
LSW904	1-762-617-21	SWITCH, KEYBOARD (WITH LED) (- (VOL)) (AMBER)	
LSW904	1-786-124-11	SWITCH, KEYBOARD (WITH LED) (- (VOL)) (GREEN)	
LSW905	1-762-619-21	SWITCH, KEYBOARD (WITH LED) (MODE) (GREEN)	
LSW905	1-771-500-21	SWITCH, KEYBOARD (WITH LED) (MODE) (AMBER)	
LSW906	1-762-619-21	SWITCH, KEYBOARD (WITH LED) (SEL) (GREEN)	
LSW906	1-771-500-21	SWITCH, KEYBOARD (WITH LED) (SEL) (AMBER)	
LSW907	1-771-882-11	SWITCH, TACTILE (WITH LED) (ATT) (AMBER)	
LSW907	1-786-113-11	SWITCH, TACTILE (WITH LED) (ATT) (GREEN)	
LSW908	1-771-882-11	SWITCH, TACTILE (WITH LED) (SENS/BTM) (AMBER)	
LSW908	1-786-113-11	SWITCH, TACTILE (WITH LED) (SENS/BTM) (GREEN)	
LSW909	1-771-882-11	SWITCH, TACTILE (WITH LED) (AF) (AMBER)	
LSW909	1-786-113-11	SWITCH, TACTILE (WITH LED) (AF) (GREEN)	
LSW910	1-762-617-21	SWITCH, KEYBOARD (WITH LED) (\lll \lll - (SEEK/AMS)) (AMBER)	
LSW910	1-786-124-11	SWITCH, KEYBOARD (WITH LED) (\lll \lll - (SEEK/AMS)) (GREEN)	
LSW911	1-762-617-21	SWITCH, KEYBOARD (WITH LED) (+ \ggg \ggg (SEEK/AMS)) (AMBER)	
LSW911	1-786-124-11	SWITCH, KEYBOARD (WITH LED) (+ \ggg \ggg (SEEK/AMS)) (GREEN)	
LSW912	1-762-619-21	SWITCH, KEYBOARD (WITH LED) (MBP) (GREEN)	
LSW912	1-771-500-21	SWITCH, KEYBOARD (WITH LED) (MBP) (AMBER)	
LSW913	1-762-619-21	SWITCH, KEYBOARD (WITH LED) (D (D-BASS)) (GREEN)	

Ref. No.	Part No.	Description	Remark
LSW913	1-771-500-21	SWITCH, KEYBOARD (WITH LED) (D (D-BASS)) (AMBER)	
LSW914	1-771-882-11	SWITCH, TACTILE (WITH LED) (DSPL) (AMBER)	
LSW914	1-786-113-11	SWITCH, TACTILE (WITH LED) (DSPL) (GREEN)	
LSW915	1-771-882-11	SWITCH, TACTILE (WITH LED) (PTY) (AMBER)	
LSW915	1-786-113-11	SWITCH, TACTILE (WITH LED) (PTY) (GREEN)	
LSW916	1-771-882-11	SWITCH, TACTILE (WITH LED) (TA) (AMBER)	
LSW916	1-786-113-11	SWITCH, TACTILE (WITH LED) (TA) (GREEN)	
LSW917	1-771-882-11	SWITCH, TACTILE (WITH LED) (6) (AMBER)	
LSW917	1-786-113-11	SWITCH, TACTILE (WITH LED) (6) (GREEN)	
LSW918	1-771-882-11	SWITCH, TACTILE (WITH LED) (5) (AMBER)	
LSW918	1-786-113-11	SWITCH, TACTILE (WITH LED) (5) (GREEN)	
LSW919	1-771-882-11	SWITCH, TACTILE (WITH LED) (4/SHUF) (AMBER)	
LSW919	1-786-113-11	SWITCH, TACTILE (WITH LED) (4/SHUF) (GREEN)	
LSW920	1-771-882-11	SWITCH, TACTILE (WITH LED) (3/REP) (AMBER)	
LSW920	1-786-113-11	SWITCH, TACTILE (WITH LED) (3/REP) (GREEN)	
LSW921	1-771-882-11	SWITCH, TACTILE (WITH LED) (2) (AMBER)	
LSW921	1-786-113-11	SWITCH, TACTILE (WITH LED) (2) (GREEN)	
LSW922	1-771-882-11	SWITCH, TACTILE (WITH LED) (1) (AMBER)	
LSW922	1-786-113-11	SWITCH, TACTILE (WITH LED) (1) (GREEN)	
< PILOT LAMP >			
PL901	1-518-743-51	LAMP, PILOT (LCD BACK LIGHT) (GREEN)	
PL901	1-518-743-61	LAMP, PILOT (LCD BACK LIGHT) (AMBER)	
PL902	1-518-743-51	LAMP, PILOT (LCD BACK LIGHT) (GREEN)	
PL902	1-518-743-61	LAMP, PILOT (LCD BACK LIGHT) (AMBER)	
< RESISTOR >			
R901	1-216-819-11	METAL CHIP 680 5%	1/16W
R902	1-216-819-11	METAL CHIP 680 5%	1/16W
R903	1-216-819-11	METAL CHIP 680 5%	1/16W
R904	1-216-821-11	METAL CHIP 1K 5%	1/16W
R905	1-216-823-11	METAL CHIP 1.5K 5%	1/16W
R906	1-216-823-11	METAL CHIP 1.5K 5%	1/16W
R907	1-216-825-11	METAL CHIP 2.2K 5%	1/16W
R908	1-216-827-11	METAL CHIP 3.3K 5%	1/16W
R909	1-216-829-11	METAL CHIP 4.7K 5%	1/16W
R910	1-216-819-11	METAL CHIP 680 5%	1/16W
R911	1-216-819-11	METAL CHIP 680 5%	1/16W
R912	1-216-819-11	METAL CHIP 680 5%	1/16W
R913	1-216-821-11	METAL CHIP 1K 5%	1/16W
R914	1-216-823-11	METAL CHIP 1.5K 5%	1/16W
R915	1-216-823-11	METAL CHIP 1.5K 5%	1/16W
R916	1-216-825-11	METAL CHIP 2.2K 5%	1/16W
R917	1-216-827-11	METAL CHIP 3.3K 5%	1/16W
R918	1-216-829-11	METAL CHIP 4.7K 5%	1/16W
R919	1-218-867-11	RES-CHIP 6.8K 5%	1/16W
R920	1-216-833-11	METAL CHIP 10K 5%	1/16W

Ref. No.	Part No.	Description	Remark
R921	1-216-835-11	METAL CHIP 15K 5%	1/16W
R941	1-216-797-11	METAL CHIP 10 5%	1/16W
R942	1-216-797-11	METAL CHIP 10 5%	1/16W
R947	1-216-829-11	METAL CHIP 4.7K 5%	1/16W
R948	1-216-829-11	METAL CHIP 4.7K 5%	1/16W
R949	1-216-829-11	METAL CHIP 4.7K 5%	1/16W
R951	1-216-821-11	METAL CHIP 1K 5%	1/16W
R952	1-216-819-11	METAL CHIP 680 5%	1/16W
R953	1-216-819-11	METAL CHIP 680 5%	1/16W
R954	1-216-819-11	METAL CHIP 680 5%	1/16W
R955	1-216-819-11	METAL CHIP 680 5%	1/16W
R956	1-216-819-11	METAL CHIP 680 5%	1/16W
R957	1-216-821-11	METAL CHIP 1K 5%	1/16W
R961	1-216-821-11	METAL CHIP 1K 5%	1/16W
R962	1-216-819-11	METAL CHIP 680 5%	1/16W
R963	1-216-819-11	METAL CHIP 680 5%	1/16W
R964	1-216-819-11	METAL CHIP 680 5%	1/16W
R965	1-216-819-11	METAL CHIP 680 5%	1/16W
R966	1-216-819-11	METAL CHIP 680 5%	1/16W
R967	1-216-823-11	METAL CHIP 1.5K 5%	1/16W
R971	1-216-821-11	METAL CHIP 1K 5%	1/16W
R972	1-216-819-11	METAL CHIP 680 5%	1/16W
R973	1-216-819-11	METAL CHIP 680 5%	1/16W
R974	1-216-819-11	METAL CHIP 680 5%	1/16W
R975	1-216-819-11	METAL CHIP 680 5%	1/16W
R976	1-216-819-11	METAL CHIP 680 5%	1/16W
R977	1-216-821-11	METAL CHIP 1K 5%	1/16W
R981	1-216-821-11	METAL CHIP 1K 5%	1/16W
R982	1-216-821-11	METAL CHIP 1K 5%	1/16W
R983	1-216-821-11	METAL CHIP 1K 5%	1/16W
R984	1-216-813-11	METAL CHIP 220 5%	1/16W
R985	1-216-813-11	METAL CHIP 220 5%	1/16W
R990	1-216-825-11	METAL CHIP 2.2K 5%	1/16W
R991	1-216-825-11	METAL CHIP 2.2K 5%	1/16W
R992	1-216-825-11	METAL CHIP 2.2K 5%	1/16W
R993	1-216-864-11	METAL CHIP 0 5%	1/16W
R994	1-216-851-11	METAL CHIP 330K 5%	1/16W
R995	1-216-857-11	METAL CHIP 1M 5%	1/16W
R996	1-216-821-11	METAL CHIP 1K 5%	1/16W
R997	1-216-821-11	METAL CHIP 1K 5%	1/16W
R998	1-216-821-11	METAL CHIP 1K 5%	1/16W

*	1-659-835-12	LIMIT BOARD	*****
< SWITCH >			
SW3	1-529-565-41	SWITCH, PUSH (1 KEY) (LIMIT)	*****

LOAD

MAIN

Ref. No.	Part No.	Description	Remark			Ref. No.	Part No.	Description	Remark		
*	1-659-837-11	LOAD BOARD *****				C303	1-124-234-00	ELECT	22uF	20%	16V
		< SWITCH >				C305	1-124-584-00	ELECT	100uF	20%	10V
SW4	1-529-566-31	SWITCH, PUSH (1 KEY) (DOWN)				C331	1-107-826-11	CERAMIC CHIP	0.1uF	10%	16V
*****						C332	1-162-970-11	CERAMIC CHIP	0.01uF	10%	25V
	A-3340-225-A	MAIN BOARD, COMPLETE *****				C341	1-124-234-00	ELECT	22uF	20%	16V
*	3-040-998-01	BRACKET (IC)				C342	1-162-970-11	CERAMIC CHIP	0.01uF	10%	25V
*	3-225-135-01	HEAT SINK				C343	1-162-970-11	CERAMIC CHIP	0.01uF	10%	25V
*	3-225-136-01	HEAT SINK (REG)				C401	1-124-589-11	ELECT	47uF	20%	16V
*	3-225-271-02	CHASSIS (BACK)				C402	1-162-970-11	CERAMIC CHIP	0.01uF	10%	25V
	7-685-647-79	SCREW +BVTP 3X10 TYPE2 N-S				C403	1-162-968-11	CERAMIC CHIP	0.0047uF	10%	50V
	7-685-793-09	SCREW +PTT 2.6X8 (S)				C404	1-125-891-11	CERAMIC CHIP	0.47uF	10%	10V
	7-685-795-09	SCREW +PTT 2.6X12 (S)				C405	1-124-233-11	ELECT	10uF	20%	16V
	7-685-797-09	SCREW +PTT 2.6X16 (S)				C406	1-162-970-11	CERAMIC CHIP	0.01uF	10%	25V
		< CAPACITOR >				C411	1-124-233-11	ELECT	10uF	20%	16V
C11	1-162-918-11	CERAMIC CHIP	18PF	5%	50V	C412	1-124-233-11	ELECT	10uF	20%	16V
C14	1-124-584-00	ELECT	100uF	20%	10V	C453	1-127-715-11	CERAMIC CHIP	0.22uF	10%	16V
C15	1-107-826-11	CERAMIC CHIP	0.1uF	10%	16V	C461	1-124-233-11	ELECT	10uF	20%	16V
C16	1-124-584-00	ELECT	100uF	20%	10V	C463	1-127-715-11	CERAMIC CHIP	0.22uF	10%	16V
C17	1-107-826-11	CERAMIC CHIP	0.1uF	10%	16V	C471	1-125-837-00	CERAMIC CHIP	1uF	10%	6.3V
						C472	1-165-176-11	CERAMIC CHIP	0.047uF	10%	16V
C21	1-162-964-11	CERAMIC CHIP	0.001uF	10%	50V	C473	1-124-233-11	ELECT	10uF	20%	16V
C22	1-162-964-11	CERAMIC CHIP	0.001uF	10%	50V	C474	1-126-160-11	ELECT	1uF	20%	50V
C23	1-162-964-11	CERAMIC CHIP	0.001uF	10%	50V	C475	1-124-589-11	ELECT	47uF	20%	16V
C24	1-107-826-11	CERAMIC CHIP	0.1uF	10%	16V	C477	1-107-826-11	CERAMIC CHIP	0.1uF	10%	16V
C25	1-164-315-11	CERAMIC CHIP	470PF	5%	50V	C479	1-124-589-11	ELECT	47uF	20%	16V
C26	1-162-915-11	CERAMIC CHIP	10PF	0.5PF	50V	C480	1-107-826-11	CERAMIC CHIP	0.1uF	10%	16V
C27	1-125-891-11	CERAMIC CHIP	0.47uF	10%	10V	C501	1-162-968-11	CERAMIC CHIP	0.0047uF	10%	50V
C28	1-165-176-11	CERAMIC CHIP	0.047uF	10%	16V	C502	1-162-915-11	CERAMIC CHIP	10PF	0.5PF	50V
C29	1-107-826-11	CERAMIC CHIP	0.1uF	10%	16V	C503	1-162-917-11	CERAMIC CHIP	15PF	5%	50V
C31	1-162-968-11	CERAMIC CHIP	0.0047uF	10%	50V	C504	1-162-919-11	CERAMIC CHIP	22PF	5%	50V
C32	1-165-176-11	CERAMIC CHIP	0.047uF	10%	16V	C505	1-162-918-11	CERAMIC CHIP	18PF	5%	50V
C33	1-164-227-11	CERAMIC CHIP	0.022uF	10%	25V	C506	1-107-826-11	CERAMIC CHIP	0.1uF	10%	16V
C41	1-125-837-00	CERAMIC CHIP	1uF	10%	6.3V	C510	1-124-584-00	ELECT	100uF	20%	10V
C42	1-125-837-00	CERAMIC CHIP	1uF	10%	6.3V	C511	1-162-970-11	CERAMIC CHIP	0.01uF	10%	25V
C51	1-124-589-11	ELECT	47uF	20%	16V	C529	1-162-964-11	CERAMIC CHIP	0.001uF	10%	50V
C52	1-107-826-11	CERAMIC CHIP	0.1uF	10%	16V	C601	1-135-473-21	ELECT	3300uF	20%	16V
C53	1-164-315-11	CERAMIC CHIP	470PF	5%	50V	C602	1-107-826-11	CERAMIC CHIP	0.1uF	10%	16V
C54	1-162-915-11	CERAMIC CHIP	10PF	0.5PF	50V	C611	1-126-157-11	ELECT	10uF	20%	16V
C55	1-162-919-11	CERAMIC CHIP	22PF	5%	50V	C612	1-126-157-11	ELECT	10uF	20%	16V
C56	1-107-826-11	CERAMIC CHIP	0.1uF	10%	16V	C613	1-126-157-11	ELECT	10uF	20%	16V
C57	1-162-964-11	CERAMIC CHIP	0.001uF	10%	50V	C614	1-126-157-11	ELECT	10uF	20%	16V
C58	1-107-826-11	CERAMIC CHIP	0.1uF	10%	16V	C617	1-163-251-11	CERAMIC CHIP	100PF	5%	50V
C59	1-162-959-11	CERAMIC CHIP	330PF	5%	50V	C622	1-125-710-11	DOUBLE LAYERS	0.1F		5.5V
C61	1-164-505-11	CERAMIC CHIP	2.2uF		16V	C631	1-124-257-00	ELECT	2.2uF	20%	50V
C62	1-164-739-11	CERAMIC CHIP	560PF	5%	50V	C661	1-107-826-11	CERAMIC CHIP	0.1uF	10%	16V
C63	1-162-966-11	CERAMIC CHIP	0.0022uF	10%	50V	C801	1-216-864-11	METAL CHIP	0	5%	1/16W
C64	1-162-964-11	CERAMIC CHIP	0.001uF	10%	50V	C803	1-162-964-11	CERAMIC CHIP	0.001uF	10%	50V
C301	1-124-234-00	ELECT	22uF	20%	16V	C804	1-162-964-11	CERAMIC CHIP	0.001uF	10%	50V
C302	1-124-234-00	ELECT	22uF	20%	16V						

CDX-L410

MAIN

Ref. No.	Part No.	Description	Remark	Ref. No.	Part No.	Description	Remark
C805	1-162-966-11	CERAMIC CHIP 0.0022uF 10% 50V				< JACK >	
		< CONNECTOR >		J10	1-815-185-12	JACK (ANTENNA)	
CN701	1-794-311-21	PLUG, CONNECTOR 12P		J561	1-566-822-41	JACK (REMOTE IN)	
CNP301	1-764-617-12	PIN, CONNECTOR (PC BOARD) 30P				< COIL >	
CNP601	1-774-701-11	PIN, CONNECTOR 16P		L500	1-419-476-11	COIL, CHOKE 250uH	
		< DIODE >				< TRANSISTOR >	
D21	8-719-404-50	DIODE MA111-TX		Q21	8-729-120-28	TRANSISTOR 2SC1623-L5L6	
D22	8-719-404-50	DIODE MA111-TX		Q22	8-729-900-53	TRANSISTOR DTC114EK	
D23	8-719-976-99	DIODE DTZ5.1B		Q331	8-729-021-82	TRANSISTOR 2SD2396K	
D331	8-719-056-84	DIODE UDZ-TE-17-7.5B		Q332	8-729-047-76	TRANSISTOR FMC2A-T148	
D332	8-719-056-83	DIODE UDZ-TE-17-6.8B		Q333	8-729-900-53	TRANSISTOR DTC114EK	
D341	8-719-158-15	DIODE RD5.6S-B		Q341	8-729-106-68	TRANSISTOR 2SD1615A-GP	
D471	8-719-053-18	DIODE 1SR154-400TE-25		Q431	8-729-920-21	TRANSISTOR DTC314TK-T-146	
D472	8-719-053-18	DIODE 1SR154-400TE-25		Q441	8-729-920-21	TRANSISTOR DTC314TK-T-146	
D473	8-719-053-18	DIODE 1SR154-400TE-25		Q451	8-729-920-21	TRANSISTOR DTC314TK-T-146	
D474	8-719-053-18	DIODE 1SR154-400TE-25		Q461	8-729-920-21	TRANSISTOR DTC314TK-T-146	
D475	8-719-053-18	DIODE 1SR154-400TE-25		Q478	8-729-900-53	TRANSISTOR DTC114EK	
D476	8-719-053-18	DIODE 1SR154-400TE-25		Q479	8-729-027-23	TRANSISTOR DTA114EKA-T146	
D477	8-719-053-18	DIODE 1SR154-400TE-25		Q551	8-729-900-53	TRANSISTOR DTC114EK	
D478	8-719-053-18	DIODE 1SR154-400TE-25		Q556	8-729-900-53	TRANSISTOR DTC114EK	
D479	8-719-404-50	DIODE MA111-TX		Q557	8-729-120-28	TRANSISTOR 2SC1623-L5L6	
D480	8-719-158-15	DIODE RD5.6S-B		Q631	8-729-120-28	TRANSISTOR 2SC1623-L5L6	
D551	8-719-056-84	DIODE UDZ-TE-17-7.5B		Q651	8-729-120-28	TRANSISTOR 2SC1623-L5L6	
D556	8-719-057-80	DIODE MA8180-M-TX		Q661	8-729-821-63	TRANSISTOR 2SB1203T-FA	
D601	8-719-049-38	DIODE 1N5404TU		Q662	8-729-900-53	TRANSISTOR DTC114EK	
D609	8-719-056-83	DIODE UDZ-TE-17-6.8B		Q664	8-729-027-23	TRANSISTOR DTA114EKA-T146	
D610	8-719-056-65	DIODE 1SS372-TE85L				< RESISTOR >	
D613	8-719-053-18	DIODE 1SR154-400TE-25		R21	1-216-825-11	METAL CHIP 2.2K 5% 1/16W	
D614	8-719-053-18	DIODE 1SR154-400TE-25		R22	1-216-825-11	METAL CHIP 2.2K 5% 1/16W	
D621	8-719-067-56	DIODE MA112-TX		R24	1-216-833-11	METAL CHIP 10K 5% 1/16W	
D651	8-719-057-80	DIODE MA8180-M-TX		R25	1-216-833-11	METAL CHIP 10K 5% 1/16W	
D671	8-719-404-50	DIODE MA111-TX		R26	1-216-809-11	METAL CHIP 100 5% 1/16W	
D701	8-719-404-50	DIODE MA111-TX		R27	1-216-845-11	METAL CHIP 100K 5% 1/16W	
D710	8-719-056-83	DIODE UDZ-TE-17-6.8B		R28	1-216-857-11	METAL CHIP 1M 5% 1/16W	
D711	8-719-056-83	DIODE UDZ-TE-17-6.8B		R29	1-216-809-11	METAL CHIP 100 5% 1/16W	
D715	8-719-056-83	DIODE UDZ-TE-17-6.8B		R31	1-218-867-11	RES-CHIP 6.8K 5% 1/16W	
D716	8-719-056-83	DIODE UDZ-TE-17-6.8B		R32	1-216-845-11	METAL CHIP 100K 5% 1/16W	
D717	8-719-056-83	DIODE UDZ-TE-17-6.8B		R41	1-216-841-11	METAL CHIP 47K 5% 1/16W	
D718	8-719-056-83	DIODE UDZ-TE-17-6.8B		R52	1-216-853-11	METAL CHIP 470K 5% 1/16W	
		< IC >		R53	1-216-821-11	METAL CHIP 1K 5% 1/16W	
IC20	8-759-100-96	IC uPC4558G2		R54	1-216-837-11	METAL CHIP 22K 5% 1/16W	
IC51	8-759-492-59	IC SAA6588T-118		R56	1-216-797-11	METAL CHIP 10 5% 1/16W	
IC401	8-759-653-27	IC TDA7402TR		R57	1-216-817-11	METAL CHIP 470 5% 1/16W	
IC404	8-759-486-44	IC TDA7386		R60	1-216-797-11	METAL CHIP 10 5% 1/16W	
IC501	6-800-278-02	IC MN101C49KTD2		R331	1-216-825-11	METAL CHIP 2.2K 5% 1/16W	
IC601	8-759-661-47	IC BA4908-V3		R332	1-216-825-11	METAL CHIP 2.2K 5% 1/16W	
IC602	8-759-682-69	IC XC61CN4302MR		R333	1-216-825-11	METAL CHIP 2.2K 5% 1/16W	
				R334	1-216-825-11	METAL CHIP 2.2K 5% 1/16W	
				R341	1-216-825-11	METAL CHIP 2.2K 5% 1/16W	

37

Ref. No.	Part No.	Description	Remark		
C11	1-162-909-11	CERAMIC CHIP	4PF	0.25PF	50V
C13	1-162-916-11	CERAMIC CHIP	12PF	5%	50V
C14	1-125-837-00	CERAMIC CHIP	1uF	10%	6.3V
C15	1-164-227-11	CERAMIC CHIP	0.022uF	10%	25V
C16	1-164-227-11	CERAMIC CHIP	0.022uF	10%	25V
C17	1-162-970-11	CERAMIC CHIP	0.01uF	10%	25V
C18	1-162-966-11	CERAMIC CHIP	0.0022uF	10%	50V
C19	1-107-826-11	CERAMIC CHIP	0.1uF	10%	16V
C20	1-107-826-11	CERAMIC CHIP	0.1uF	10%	16V
C21	1-164-227-11	CERAMIC CHIP	0.022uF	10%	25V
C22	1-164-227-11	CERAMIC CHIP	0.022uF	10%	25V
C23	1-162-970-11	CERAMIC CHIP	0.01uF	10%	25V
C24	1-164-227-11	CERAMIC CHIP	0.022uF	10%	25V
C25	1-164-227-11	CERAMIC CHIP	0.022uF	10%	25V
C26	1-126-391-11	ELECT CHIP	47uF	20%	6.3V
C27	1-164-227-11	CERAMIC CHIP	0.022uF	10%	25V
C28	1-126-391-11	ELECT CHIP	47uF	20%	6.3V
C29	1-164-227-11	CERAMIC CHIP	0.022uF	10%	25V
C30	1-164-227-11	CERAMIC CHIP	0.022uF	10%	25V
C31	1-126-391-11	ELECT CHIP	47uF	20%	6.3V
C34	1-164-227-11	CERAMIC CHIP	0.022uF	10%	25V
C35	1-164-227-11	CERAMIC CHIP	0.022uF	10%	25V
C36	1-164-227-11	CERAMIC CHIP	0.022uF	10%	25V
C37	1-126-393-11	ELECT CHIP	33uF	20%	10V
C38	1-164-227-11	CERAMIC CHIP	0.022uF	10%	25V
C39	1-126-391-11	ELECT CHIP	47uF	20%	6.3V
C40	1-107-826-11	CERAMIC CHIP	0.1uF	10%	16V
C41	1-164-227-11	CERAMIC CHIP	0.022uF	10%	25V
C43	1-162-967-11	CERAMIC CHIP	0.0033uF	10%	50V
C44	1-162-964-11	CERAMIC CHIP	0.001uF	10%	50V
< CONNECTOR >					
CN1	1-764-616-12	HOUSING, CONNECTOR (PC BOARD) 30P			
CN2	1-794-153-21	CONNECTOR, FPC (ZIF) 16P			
CN3	1-770-347-21	CONNECTOR, FPC 6P			
< JUMPER RESISTOR >					
FB1	1-216-864-11	METAL CHIP	0	5%	1/16W
FB2	1-216-864-11	METAL CHIP	0	5%	1/16W
FB4	1-216-864-11	METAL CHIP	0	5%	1/16W
FB5	1-216-295-11	SHORT	0		
FB6	1-216-864-11	METAL CHIP	0	5%	1/16W
FB7	1-216-864-11	METAL CHIP	0	5%	1/16W
< IC >					
IC1	8-759-699-98	IC uPD63711GC-8EU			
IC2	8-759-658-87	IC BA5810FP-E2			
< TRANSISTOR >					
Q1	8-729-904-87	TRANSISTOR 2SB1197K-R			

Ref. No.	Part No.	Description	Remark		
< RESISTOR >					
R3	1-216-797-11	METAL CHIP	10	5%	1/16W
R5	1-218-344-11	RES-CHIP	7.5K	5%	1/16W
R6	1-216-837-11	METAL CHIP	22K	5%	1/16W
R7	1-216-839-11	METAL CHIP	33K	5%	1/16W
R8	1-216-833-11	METAL CHIP	10K	5%	1/16W
R9	1-216-840-11	METAL CHIP	39K	5%	1/16W
R10	1-216-835-11	METAL CHIP	15K	5%	1/16W
R12	1-216-837-11	METAL CHIP	22K	5%	1/16W
R14	1-216-841-11	METAL CHIP	47K	5%	1/16W
R15	1-216-841-11	METAL CHIP	47K	5%	1/16W
R17	1-216-809-11	METAL CHIP	100	5%	1/16W
R18	1-216-809-11	METAL CHIP	100	5%	1/16W
R19	1-216-809-11	METAL CHIP	100	5%	1/16W
R20	1-216-809-11	METAL CHIP	100	5%	1/16W
R21	1-216-821-11	METAL CHIP	1K	5%	1/16W
R22	1-216-821-11	METAL CHIP	1K	5%	1/16W
R24	1-216-864-11	METAL CHIP	0	5%	1/16W
R25	1-216-864-11	METAL CHIP	0	5%	1/16W
R26	1-216-797-11	METAL CHIP	10	5%	1/16W
R29	1-216-833-11	METAL CHIP	10K	5%	1/16W
R30	1-216-833-11	METAL CHIP	10K	5%	1/16W
R31	1-216-789-11	METAL CHIP	2.2	5%	1/16W
< VIBRATOR >					
X1	1-781-759-21	VIBRATOR, CERAMIC (CHIP TYPE) (16.9344MHz)			

*	1-659-834-11	SUB BOARD *****			
< CONNECTOR >					
CN1	1-770-347-21	CONNECTOR, FPC 6P			

MISCELLANEOUS *****					
5	1-776-527-82	CORD (WITH CONNECTOR) (ISO) (POWER)			
201	X-3378-598-2	CHASSIS (OP) ASSY (including M901)			
207	1-659-880-11	MOTOR FLEXIBLE BOARD			
△ 210	8-820-103-11	PICK-UP, OPTICAL KSS-720A/C-RP			
212	1-676-707-21	PICK-UP FLEXIBLE BOARD			
F901	1-532-877-11	FUSE (BLADE TYPE) (AUTO FUSE) 10A			
M902	A-3291-674-A	MOTOR ASSY, SLED (SLED)			
M903	A-3315-039-A	MOTOR SUB ASSY, LD (LOADING)			

The components identified by mark △ or dotted line with mark. △ are critical for safety. Replace only with part number specified.

Ref. No.	Part No.	Description	Remark
		ACCESSORIES	

	3-236-849-11	MANUAL, INSTRUCTION (ENGLISH,GERMAN, FRENCH,ITALIAN,DUTCH)	
	3-236-850-11	MANUAL, INSTRUCTION, INSTALL (ENGLISH, GERMAN,FRENCH,ITALIAN,DUTCH)	
	X-3378-490-2	CASE (PANEL) ASSY (for FRONT PANEL)	

PARTS FOR INSTALLATION AND CONNECTIONS

251	X-3373-602-2	FRAME ASSY
252	X-3381-148-1	SCREW ASSY (BS2), FITTING
253	3-349-410-11	BUSHING
254	3-232-419-01	COLLAR
255	3-934-325-01	SCREW, +K (5X8) TAPPING
256	1-465-459-21	ADAPTOR, ANTENNA
257	3-233-644-01	SPRING, FITTING
258	1-776-527-82	CORD (WITH CONNECTOR) (ISO) (POWER)

